

State of S^c Carolina

Pursuant to an warrant from John Thomas Esq^r Com^r of locations I have admeasured and laid out unto George Straight a tract of one hundred and seventy acres of land in 96 district on the waters of Foster's creek a branch of Enoree river, and hath such shape and Marks, buttings and boundings as the above Plat represents, Survey: 8th Dec^r 1786, Del. W^m Calmes, Recorded 21st Dec^r 1786, Del. W^m Calmes.

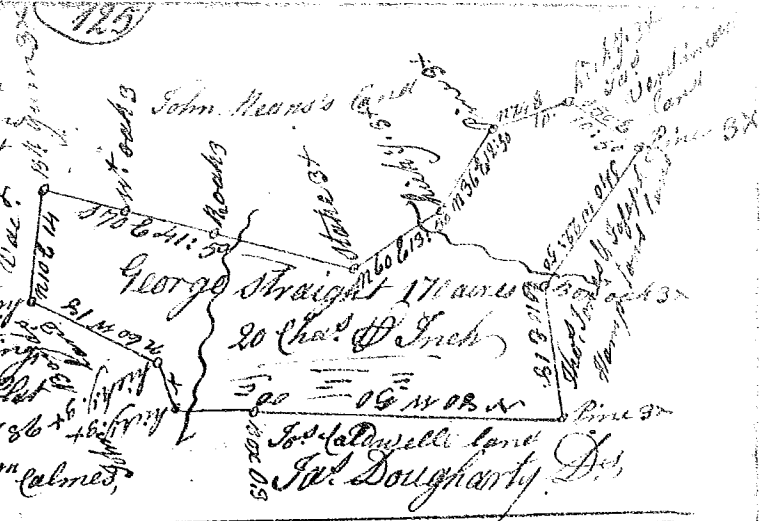

State of S^c Carolina

Pursuant to an warrant from John Thomas Commissioner of locations dated 17th Aug^t 1786, I have admeasured and laid out unto James Wofford a tract of four hundred acres of land on the north of Ferguson's

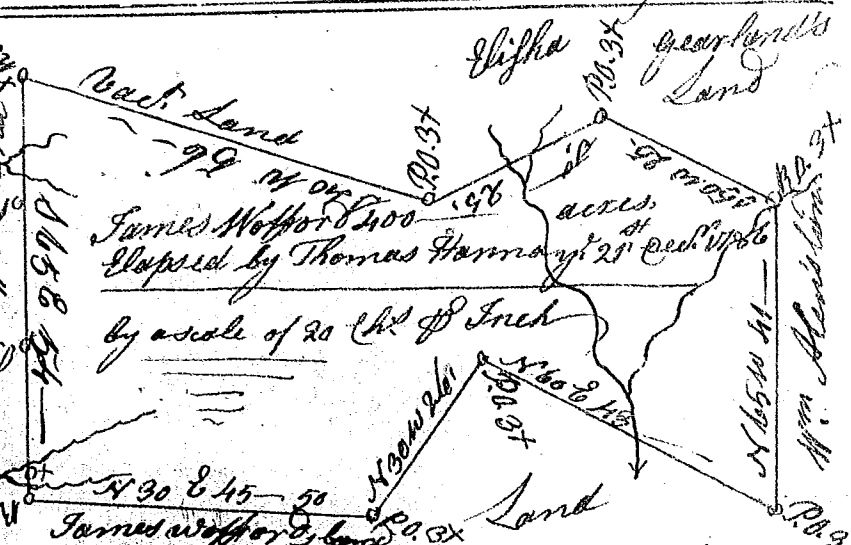

waters of Sugar river, bounded N. by William Allen's land, W. by Elisha Gearland's land, S. by E. by James Wofford's land all other sides by vacant land, and hath such shape, Marks, buttings and boundings as the above Plat represents, Recorded 21st Dec^r 1786, Survey: 22nd Aug^t 1786, James Wofford Esq^r for Thomas Hanna

S^c Carolina Pursuant to an warrant from John Thomas Esq^r Com^r of locations Dated 17th Aug^t 1786, I have admeasured and laid out unto J^m Wofford a tract of 200 acres of land on both sides of Enoree river, bound N. E. by John Weakfield's land W. by Balenger's land, S. by Merrid Burk's Land, E. by the old boundary line, all other sides vacant land and hath such shape, Marks, buttings & boundings as the above Plat represents, Survey: 21st Aug^t 1786, Recorded for John Forester the 21st Dec^r 1786, James Wofford Esq^r.

