

Pursuant to warrant from John Thomas
 Commissioner of locations dated the 7th of Aug^r 1786
 have admeasured and laid out unto
 said John Thomas a tract of two hundred
 and thirty three acres of Land,
 situated in Ninety six District above the old Branch
 Branches of the Middle fork of Saluda River, (Branch
 Middle fork Land Mine) including two small Improvements
 all sides on vacant Land & hath such shape & marks as
 above Plat Represents Survey the 11th of Aug^r 1786
 Recorded the 15 of Dec^r 1786
 & Deliv^d to whom

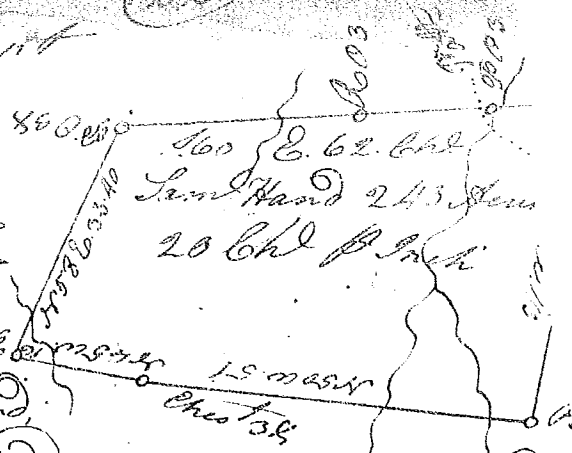

[Signature]

State of S^c Carolina 96 District

Pursuant to warrant from John Thomas
 Commissioner of locations dated 11th Oct^r 1786
 have admeasured and laid out unto
 Owen Forester a tract of one hundred
 and seventy four acres of Land, in
 Spartanburg County on the North
 Side of Sugar Creek, and hath such
 shape, Marks, Sitings
 & boundaries as the above
 plat Represents.

Survey 5th Oct^r 1786
 Recorded 18th Dec^r 1786

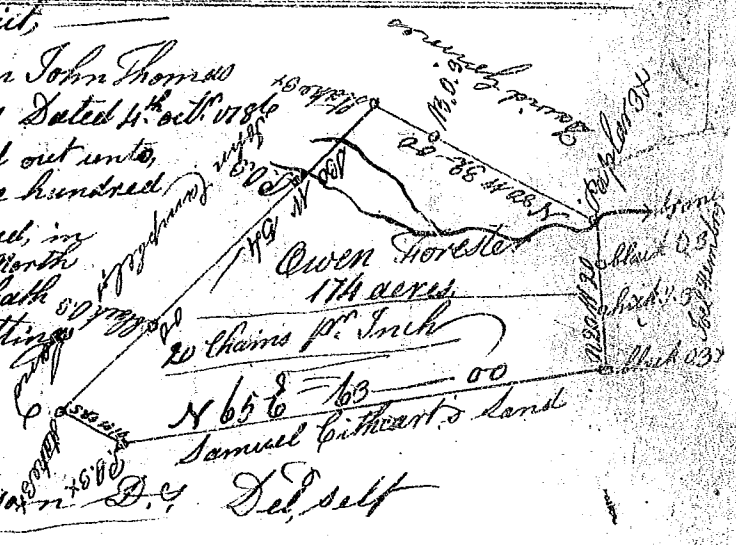

[Signature]
 Del. self