

South Carolina

Pursuant to a warrant from John Thomas Esq. Comr. of Locations of the side of Saluda, I have admeasured & laid out unto Robert Pearce a tract of nine hundred & twenty nine acres of Land, situate in Ninety six District on the waters of Enoree River & hath such shape marks & buttings & Boundings as the above Plat represents

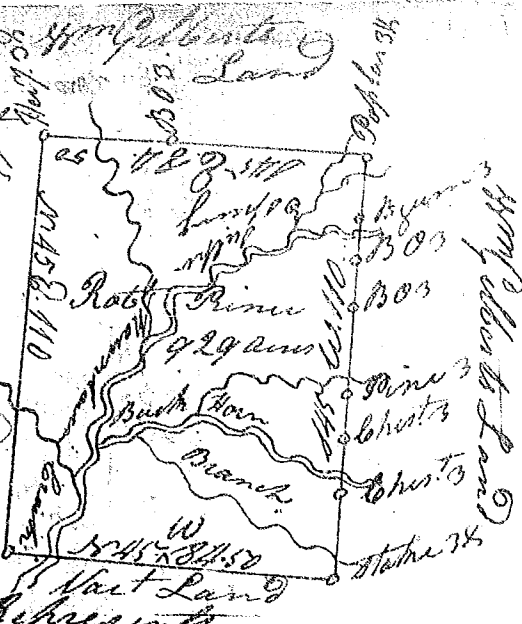

Survey'd the 15 Nov^r 1786 Robert Pearce D.S.
Recorded the 14 Dec^r 1786. Deliv^d to Wm. Abbot

South Carolina

Pursuant to a warrant from John Thomas Esq. Comr. of Locations of the side of Saluda I have admeasured & laid out unto Abraham Mitchell Esq. a tract of one thousand & fifty nine acres of Land situate in Ninety six

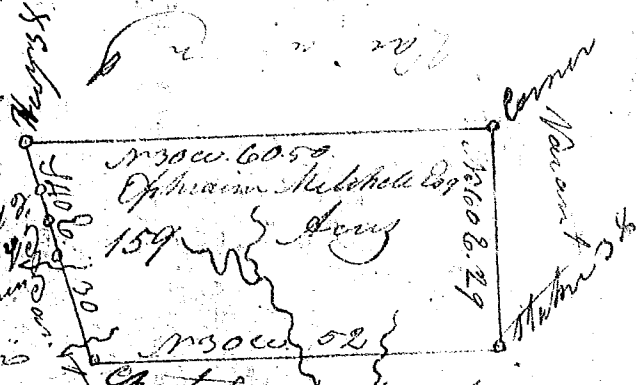

on the top Pearce's Mountain & hath such shape & marks & buttings & Boundings as the above Plat represents - Survey'd the 20 Oct^r 1786.
Recorded the 14 Dec^r 1786. Deliv^d to Wm. Abbot
Robt Pearce D.S.

State of S^c Carolina

Pursuant to a warrant from John Thomas Esq. Comr. of Locations of the side of Saluda I have admeasured and laid out unto James Martin Esq. a tract of 96 acres of Land in Union County, 96 situated on the N.W. side of Enoree River and hath such shape, marks, & buttings and boundings as the above Plat represents - Survey'd the 16 Dec^r 1786.
Recorded the 14 Dec^r 1786.
Deliv^d to

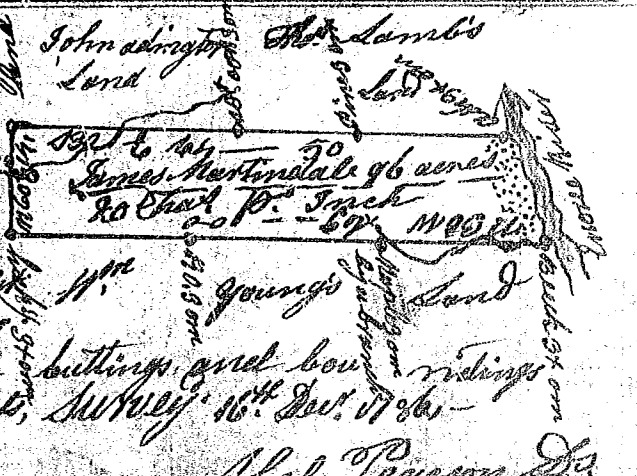

Abel Pearson D.S.