

South Carolina

P. M. WATT is a warrant

from John Thomas Esq. Com. of Locations & Saluda River in Ninety six District dated the 11 of Nov^r 1786 I have admeas^d & laid out unto John Finney a Tract of One Hundred Ten acres of Land siting Part of said warr. Situate in Lawrence County on the Et side of Cane Creek the waters of the Saluda River that

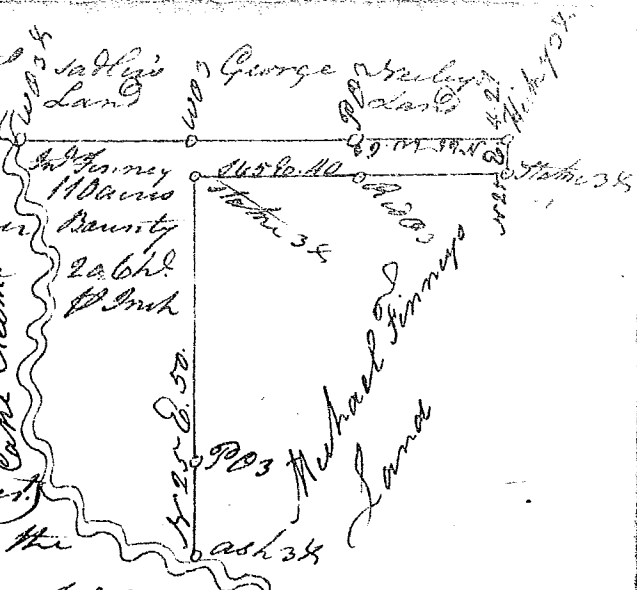

Such Buttings & Boundings as the above Plat Represents Certified the 20 of Nov^r 1786 Jas. Cunningham of Record the 11 of Dec^r 1786.

State of Carolina

P. M. WATT is a warrant to a warrant from John Thomas Esq. Com. of Locations dated the 4 of Sept^r 1786. I have admeas^d & laid out unto John Dushinson a Tract of Three Hundred Forty Acres of Land situate in Ninety six District Granville County on the waters of the Grove Creek & hath such farm Marshes, Buttings & Boundings as the above Plat Represents



Surveyed the 14 of October 1786 by John W. Deane Esq. of Record the 12 of Dec^r 1786. & Deliv^d to self