

South Carolina
 Pursuant to an
 -arrant from John Thomas Esq.
 Com^r of Locations, & since validation
 I have admeasured & laid out unto
 John Each a part of two Hundred &
 Eighty five acres of land situate
 in Newby six district on the
 large Cove of Great River & that
 such Buttines & Boundings & other
 shape & marks as the above plat
 Represents
 Surveyed the 14th Oct^r 1786.

Recorded the 1st of Dec^r 1786.
 & Deliv^d to M^r Prince

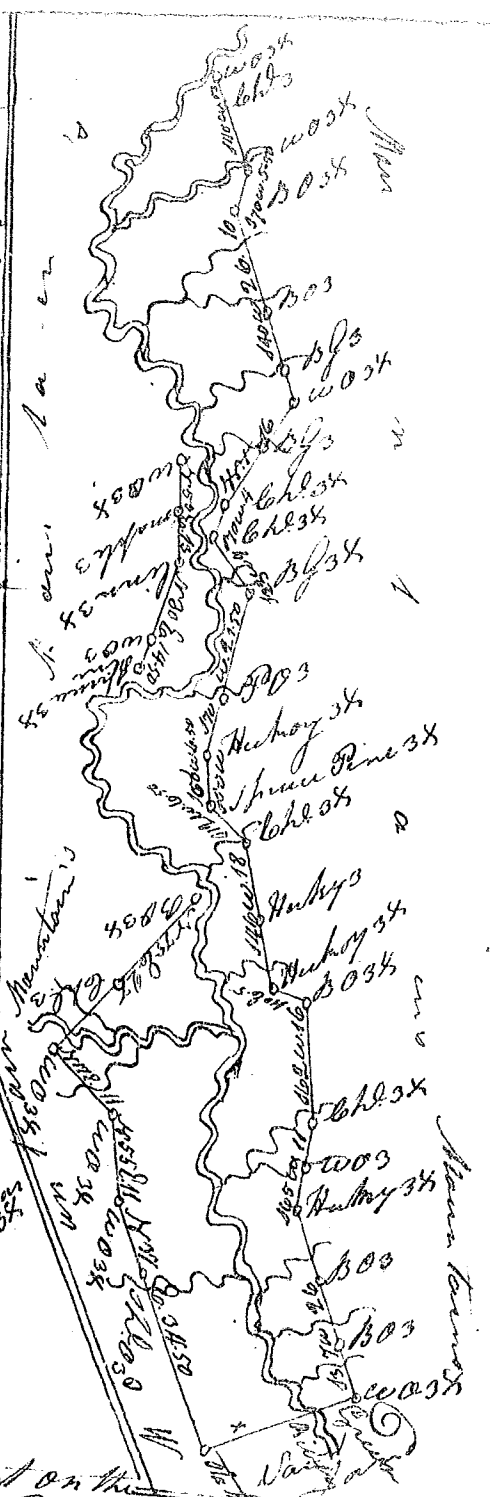
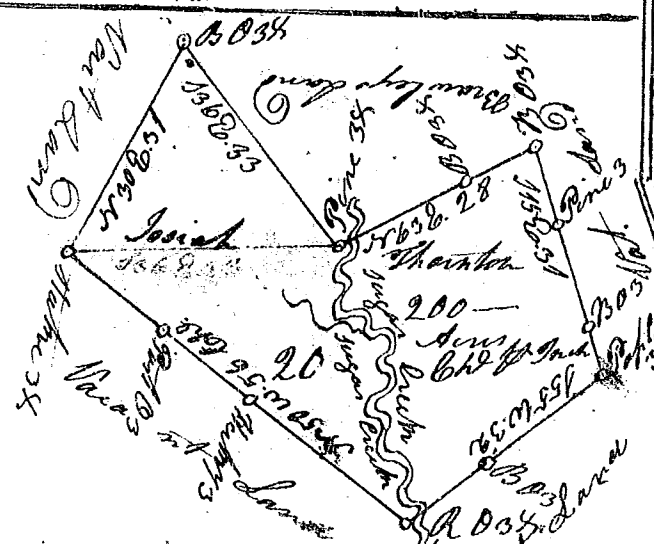

State of South Carolina Sixty six district on the
 East side of the ancient Boundary line Pursuant to
 John Thomas Esq^r Com^r of Locations Bearing date Oct^r 30th 1786.
 I have admeasured & laid out unto Josiah Tharnton a part of Land
 Containing Two Hundred Acres situate lying & being on Both
 sides of Sugar Creek between Broad & Saluda Rivers & on the N^o side
 of Great River bounded to the N^o by Brawley's land other sides
 by warrant & that such shape & marks as the above Plat Repres-
 59 Surveyed the 4th Day of Nov^r 1786 Andrew Thompson Esq^r
 Recorded the 2^d of Dec^r 1786 & Deliv^d to Major Smith