

Pursuant to a Warrant from John Thomas Esq. Commissioner
 of locations, I have admeasured and laid out unto Samuel M. Junkin a
 tract of 507 acres of land, on the branches of Tinker Creek, 96 District,
 and hath such form and marks as the above Plot
 Represents, Surveyed 29th Aug. 1786, Charles Sims Esq.
 Recorded 14th Oct. 1786, Det. Saml. Junkin at order of the owner

Carolina
 Pursuant to a Warrant from John Thomas
 Esq. Com. of the Side Salary
 on the River. I have ad-
 measured and laid out
 unto Obadiah Hooper
 a tract of Two Hundred
 & Thirty five acres of
 land situated in 96
 District On the waters
 of Reedy River & Armstrong
 Creek. & hath such shape
 & marks & buttings & boundings as the
 above plot Represents, Surveyed the 10th Nov. 1786, Robt. Pearce Esq.
 Recorded the 24th Nov. 1786.

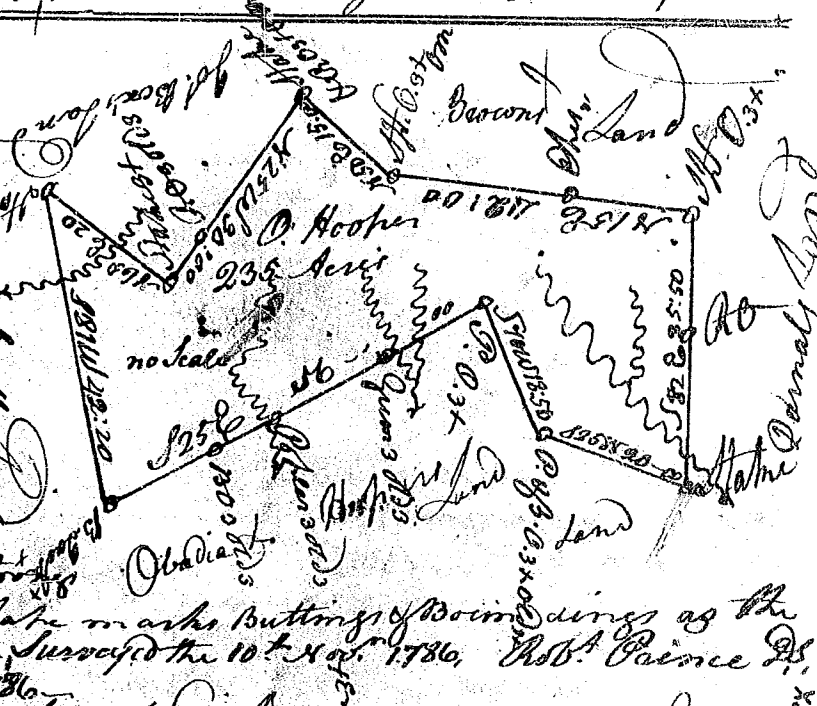

Carolina. Pursuant to a Warrant
 from John Thomas Esq. Com. of Locations
 Dated the 18 Oct. 1786, I have admeasured
 & laid out unto Obadiah Hooper, a tract
 of One Hundred & Fourteen Acres of land
 Situate in 96 District, On the River
 Dam of Enore River. & hath such shape
 & marks & buttings & boundings as the above
 plot Represents, Surveyed 20th Nov. 1786
 Recorded 24th Nov. 1786



Robert Pearce Esq.
 Surveyor