

State of South Carolina,
 Pursuant to a warrant from John
 Thomas Esq. Commissioner of locations
 I have admeasured and laid out unto
 David Lewis a tract of four hundred and
 fifty acres of land in Ninety six District
 on both sides of Meadow Creek of Lawson's fork waters of Peeble
 River, and on branches of Main Lawson's fork of Peeble River, and
 hath such shape, Marks, beatings and boundings as the above Plat
 Represents, Surveyed & Certified the 6th April 1786,
 Recorded 5th July 1786,
 J. Young Junr. D.C.

State of S^c Carolina, 96 District,
 Pursuant to a warrant from John
 Thomas Esq. Commissioner of locations
 dated the 4th day of July 1786,
 I have admeasured and laid
 out unto John Hendricks a
 tract of Three hundred and
 seventy two acres of land, on
 Two Mile Creek, waters of Broad
 River, bounded S^W by
 J^r Whiteacre's land, E^{ly} by
 J^r McGowan & John Ford's land
 all other sides vacant, and
 hath such shape, form and
 Marks as the above Plat Represents, Surveyed 6th July 1786
 Recorded 17th July 1786,

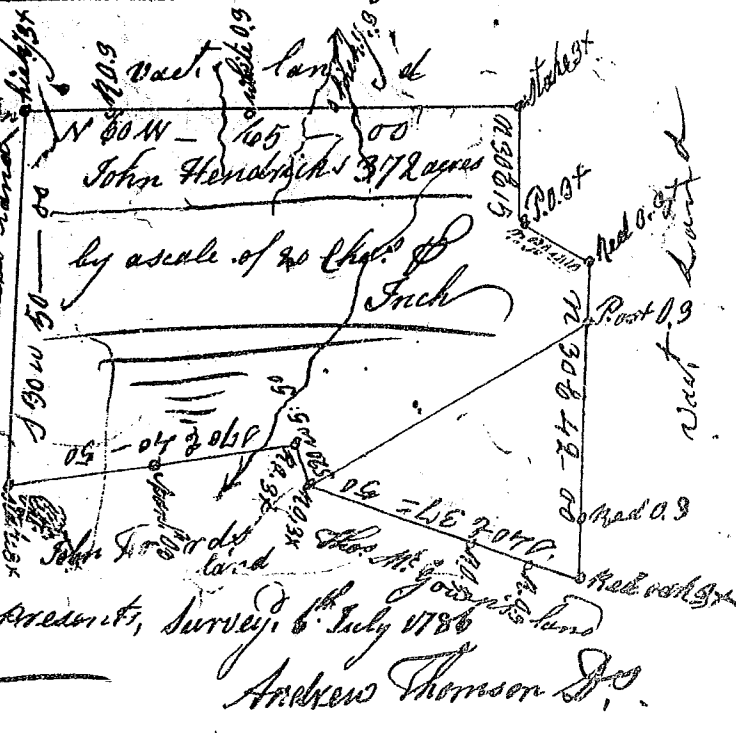

Andrew Thomson D.C.