

State of South Carolina
 Pursuant to a warrant from John Thomas Esq. Dated the 12th April 1786, I have admeasured and laid out unto Philemon Waters a tract of six hundred and thirty eight acres of land in ninety six district, on waters of Enoree River, and hath such shape, marks, buttings and boundings as the above Plat represents, Surveyed 22. April 1786.
 Recorded 5th May 1786, Phil. Waters De.

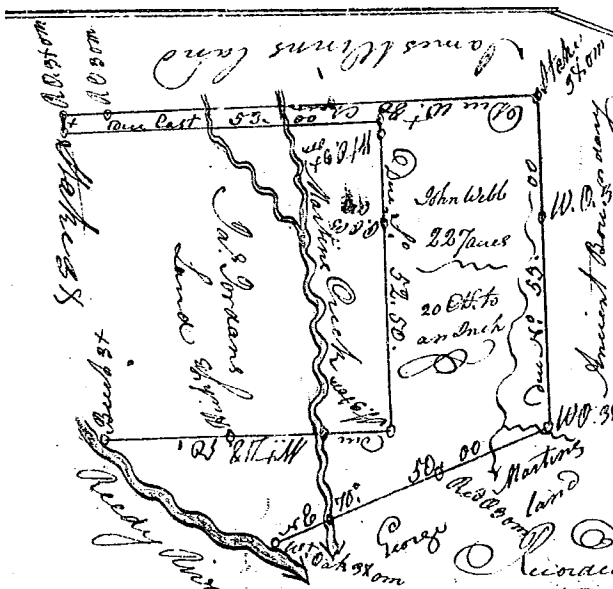

South Carolina
 Pursuant to a Warrant from John Thomas Esq. Dated the 12th April 1786, I have admeasured and laid out unto John Webb a tract of land containing Two Hundred twenty acres, situated in 96 District on the West Side of Reddy River, and hath such shape, marks, buttings and boundings as the above plat represents.
 Certified the 28th April 1786 Lewis D. De.
 Recorded this 8th May 1786 De. the Recorder

State of Carolina Pursuant to a warrant from John Thomas Esq. Dated the 12th April 1786, I have admeasured and laid out unto William Anderson a tract of 443 acres of land, situated in the District of 96. On both sides of Presby Creek of Enoree River, and hath such shape, marks, buttings and boundings as the above plat represents.
 Certified the 30th April 1786
 John Gammage De.
 Recorded this 9th May 1786 De. the Recorder

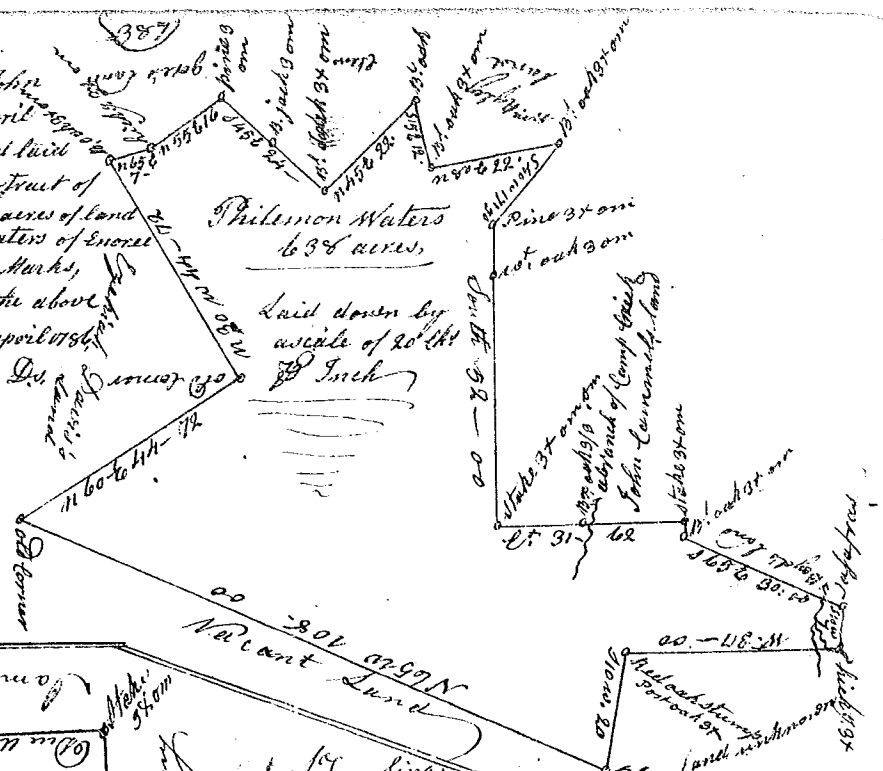