

State of South Carolina, Ninety six District of Saluda

Commissioner of Locations, Pursuant to a warrant from John Thomas Esq. dated the 7th Novem^r 1785. I have administered & laid out unto Thomas Hightower a tract of 600 acres of land, situate on the south side of Sugar Creek, bounded N. by said Sugar Creek, E. by George Brantons land, S. by John H. Copleys land, & Old lines, and by Henry Hightowers land, & S. by James & William Hollis's land, all other sides by vacant land, and hath such shape, form & marks as the above plat represents -

Surveyed the 14th Day of Decem^r 1785
 James Wofford D.S.
 Recorded the 20th day of Jan^y 1786
 D.S. himself

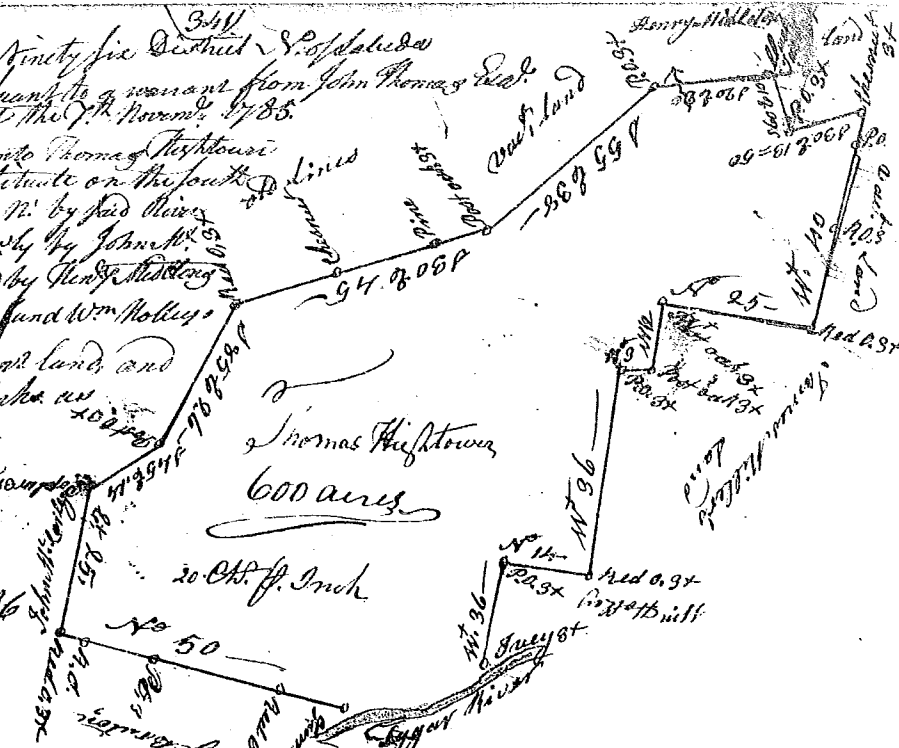

Pursuant to a Warrant from John Thomas Esq. Comm^r of Locations, North side of Saluda, I have administered & laid out unto Thomas Draper a Tract of land containing fifty acres, Situate on Mill Creek a S. Branch of Jacoby River, bounded to the E. & W. on land belonging to T. Draper South on lands belonging to Tyler & others & on Vacant land & hath such shape & marks as the above plat represents -

Surveyed the 20th of Dec^r 1785 by Jas^t Bulloch D.S.
 Recorded this 21st day of Jan^y 1786



State of South Carolina Pursuant to a Warrant from John Thomas Esq. Esq. in 96 District N. of Saluda, I have administered & laid out unto Mary M. Guine a Tract of 530 Acres of land Situate in 96 District on the Waters of Fanning's & Key's Creek, Brooming & Coon land laid out to Dr. M. Craven & Coon Dr. M. Craven's land, all other sides vacant & hath such shape & marks as the above plat represents -

Surveyed the 27th of Sept. 1785
 Recorded 25th Jan^y 1786
 D.S. himself

