

State of South Carolina

Pursuant to a warrant from John Thomas Esq. Com. of Locations dated the 29th Nov. 1785. I have admeasured and laid out unto Thomas Wadsworth a

Tract of 212 acres of land Situate in 96 district on the branches of Indian Creek waters of Broad River. Bounded on all sides as above mentioned & hath such shape & marks as the above plat represents & was surveyed this 30th Dec. 1785. Witness my hand & seal this 30th Dec. 1785. Jesse Cornell Esq.

Recorded this 18th Janry 1786. State of South Carolina. Pursuant to a warrant from John Thomas Esq. Com. of Locations for the district of 96. north of Saluda River dated the 29th Nov. 1785. I have admeasured and laid out unto

Thomas Wadsworth a Tract of 82 acres of land Situate in 96 District on Bush River Waters of Saluda Bounded on all sides as above mentioned & hath such shape & marks as the above plat represents

Recorded this 18th Janry 1786. Surveyed this 17th Dec. 1785. Witness my hand & seal this 17th Dec. 1785. Jesse Cornell Esq.



State of South Carolina Pursuant to warrant from John Thomas Esq. Com. of Locations dated 8th Nov. 1785. I have admeasured and laid out unto Stephen Williford a tract of land containing

200 acres Situate in 96 district on both sides of Transfers Creek Bounded to the N. E. by Williams land & to the S. by Brooks land. 170 by Wm Woods land the other side vacant & hath such shape & marks as the above plat represents

Surveyed the 9th Nov. 1785 by Jesse Cornell Esq. Recorded this 18th Janry 1786. Dit. Williford



State of South Carolina

Pursuant to a warrant from John Thomas Esq. Com. of Locations dated 25th Dec. 1785, I have admeasured and laid out unto James Lee a tract of land containing one hundred and forty four acres in 96 district on the branches of Lawson's fork, bounded N. E. by Neubin Lawson's land, S. W. by Henry Walker's land, all other sides by vacant land, and hath such shape & marks as the above plat represents. Certified the 31st day Janry. 1786. Recorded 19th Janry. 1786. Jesse Cornell Esq.

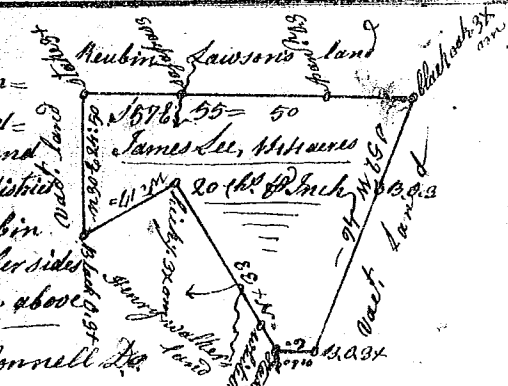

State of South Carolina Pursuant to a warrant from John Thomas Esq. Com. of Locations dated the 5th Nov. 1785 I have admeasured and laid out unto David Henry a tract of land containing two hundred & sixty seven acres in 96 District, east of the Indian boundary east of Pocolat river on the branches of said river, bounded on all sides by vacant land, and hath such shape and marks as the above Plat represents, Surveyed 19th Nov. 1785 by Jesse Cornell Esq. Recorded 19th Janry. 1786.

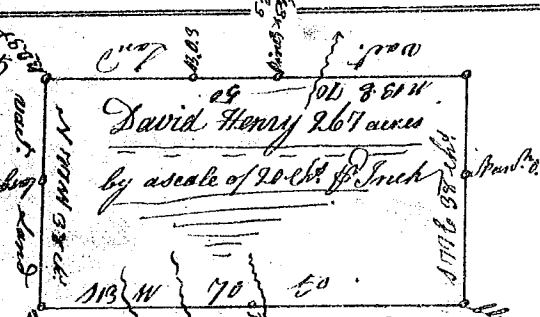

State of South Carolina Pursuant to a warrant from John Thomas Esq. Com. of Locations dated the 5th Nov. 1785. I have admeasured and laid out unto David Henry a tract of land containing 95 acres in Ninety six District, lying on the east side of Pocolat river, bounded N. E. by James Hammett's land, all other sides by vacant land, and hath such shape and marks as the above Plat represents. Surveyed 19th Nov. 1785 by Jesse Cornell Esq. Recorded 19th Janry. 1786.

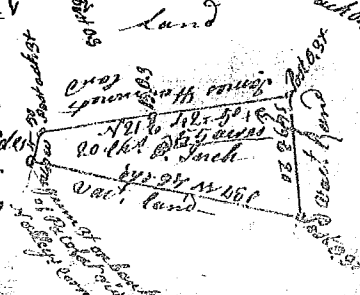

149 Recorded 19th Janry. 1786.