

State of S^c Carolina

Pursuant to a warrant from
John Thomas Esq. Commissioner of locations
dated the 3^d of Dec^r 1785, I have admeasured
and laid out unto John Corner a tract of
six hundred and sixteen acres of land
situate in Nine by Six District, on the branches
of Rocky Creek of Enoree river, and branches
of Lorri Creek of Needy river, and hath
such shape, Marks, buttings and boundings
as the above Plat represents,

Survey^d 16th Dec^r 1785.

by John C. Kilpatrick
D^y.

Recorded 2^d Jan^y 1786,

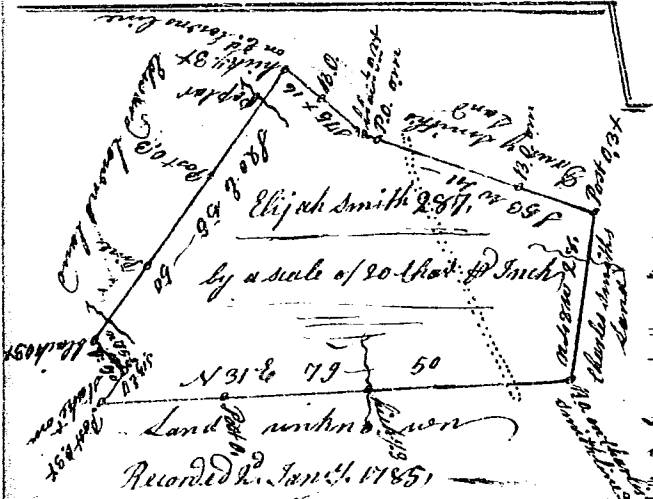
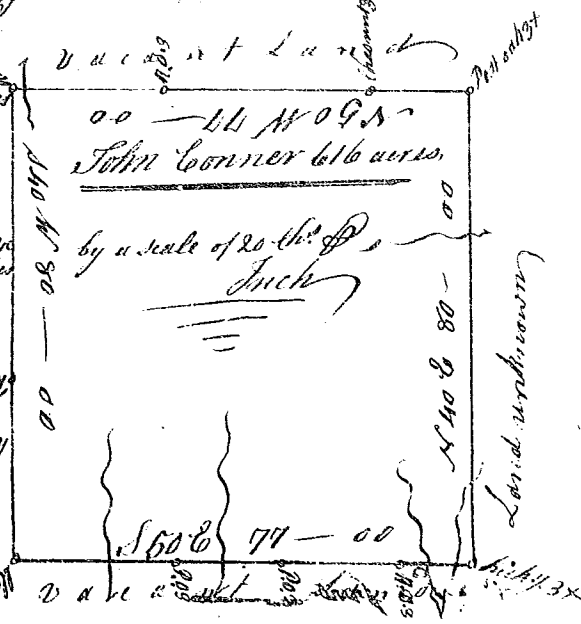

State of S^c Carolina Pursuant to a warrant
from John Thomas Esq. Commissioner of locations
granted 21st Oct^r 1785, I have admeasured and
laid out unto Elijah Smith a tract of land con-
taining two hundred and eighty seven acres
situate in 9th District, east of the Indian bound-
ary line, on the branches of fair forest & Sity-
fash, bounded on the Nth by Charles Smiths land
Sth by Drury Smiths land, Sth by Edwards
Lorris's land, Est by land unknown, and hath
such shape and Marks as the above Plat repre-
sents, Survey^d 22nd Oct^r 1785 Jesse Connell D^y.

State of S^c Carolina Pursuant to a
warrant from John Thomas Esq. Com-
missioner of locations dated 3^d Dec^r 1785,
I have admeasured and laid out
unto Uriah Corner a tract of five
hundred and eighty nine acres of
land, situate in 9th District, on
both sides of bushy creek of Enoree
river, and hath such shape, Marks,
buttings and boundings as the above
Plat represents, Survey^d 3^d Dec^r 1785
John C. Kilpatrick D^y.

Recorded 2^d Jan^y 1786,

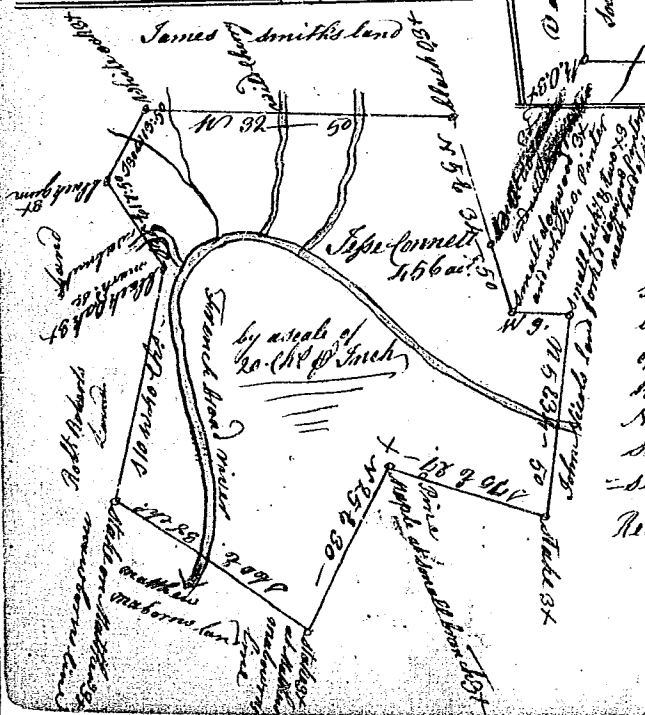
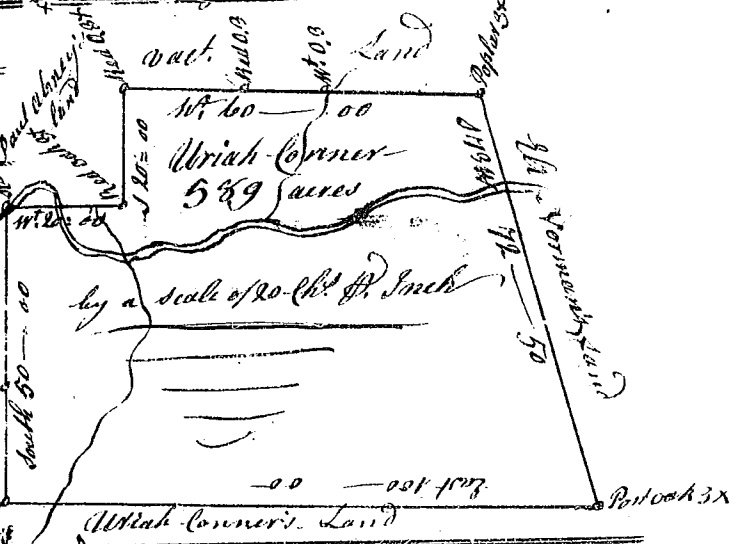

State of south Carolina,
Pursuant to a warrant from John Thomas Esq.
Commissioner of locations dated 5th Nov^r 1785,
I have admeasured and laid out unto Jesse Connell
a tract of land containing four hundred and fifty
six acres, situate in 9th District on both sides of pine
broad river, above Matthew Mabourns land & west
of Indian boundary line, bounded Est by Robert
Roberts's land, Nth by Jas Smiths land, Wth by John
Nicols land, Sth by Mabourns land, and hath
such form and Marks as the above Plat repre-
sents, Survey^d 14th Nov^r 1785 Jesse Connell D^y.

Recorded 2^d Jan^y 1786,