

State of South Carolina Pursuant to warrant from John Thomas Esq. Commissioner of Locations dated the 26th October 1785 I have admeasured and laid out unto Jesse Connell a tract of six hundred and Twenty one acres of land situate in ninety six District on both sides of French Broad River including Indian old field on both sides said River, and hath such shape, Marks, buttings and boundings as the above Plat represents, Surveyed 9th Nov. 1785, Recorded 11th Nov. 1785.

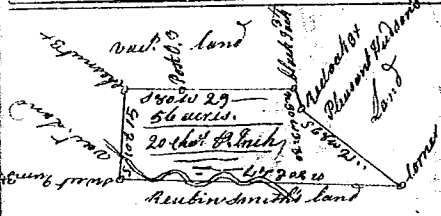

State of South Carolina 96 District N. of Saluda M. d. boundary Pursuant to warrant from John Thomas Esq. Commissioner of Locations dated the 8th Sept. 1785 I have admeasured and laid out unto Joseph Woodall a tract of fifty six acres of land, situate on Rocky-creek waters of Enoree River, bounded W. by Pleasant Hudson's land, N. E. by Reubensmith's land bounded on all other sides by vacant Land, and hath such shape, form and Marks as the above Plat represents, Surveyed the 18th Oct. 1785, by James Wofford D.S. Del. Joseph Woodall, Recorded 19th Nov. 1785.

State of S. Carolina 96 District N. of Saluda East of the Old Boundary Pursuant to a warrant from John Thomas Esq. C. L. Dated the 11th Nov. 1785. I have Admeasured & laid out unto James Gilbert a tract of land containing Two Hundred & fifty acres Situate lying & being on Diskins Creek the waters of Enoree River. Bounded N. by Cordele Bushfield, W. by Richard Foster's & others, S. by William Gilbert's East by 200 yds. Williams lands, & every way by 20 lines & hath the such shape form & marks as the above Plat represents. Surveyed the 12th Nov. 1785 Recorded 15th Nov. 1785 Del. the owner J. James Wofford D.S.

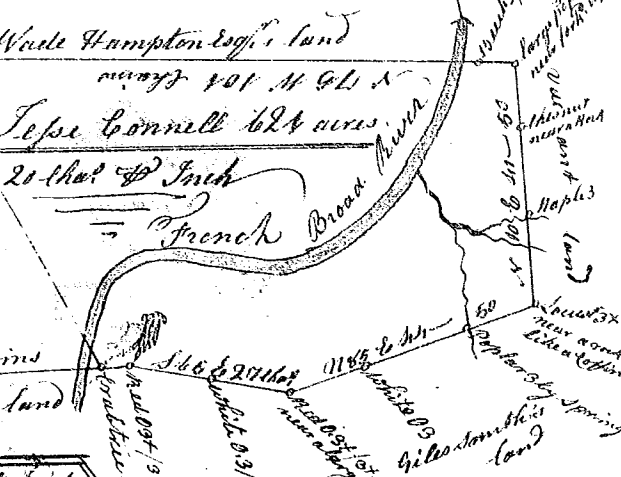
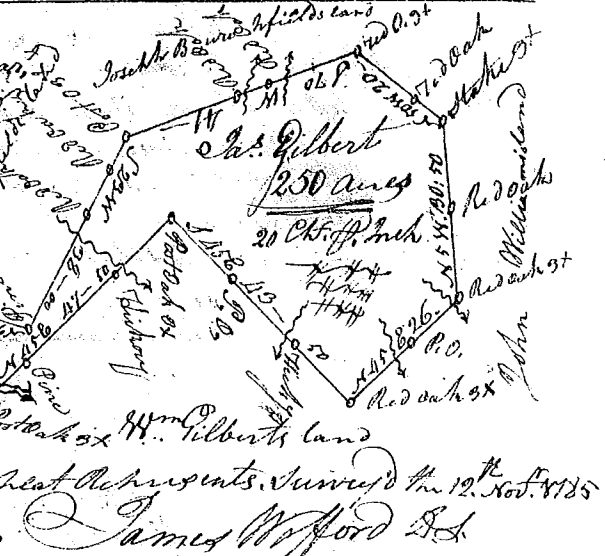

State of S. Carolina Pursuant to warrant from John Thomas Esq. Commissioner of Locations in 96 District N. of Saluda dated the 12th Nov. I have Admeasured & laid out unto John Edwards a tract of Three Hundred & eighty three acres of land Situate in ninety six District below the Ancient Boundary on a Branch of Broad River called Indian Creek, Bounded on all sides as are above mentioned & hath the such shape form & marks as the above Plat represents Surveyed this 19th Oct. 1785 Recorded the 16th Nov. 1785 John Hunter D.S. Del. the owner John Edwards

