

State of South Carolina,

Pursuant to a warrant from John Thomas Esq. Commissioner of locations Dated the 26th day of Oct. 1785, I have admeasured and laid out unto Giles Smith 319 acres of land, situate in Ninety six district, on both sides of French broad River, including Indian old fields on both sides of said River, and hath such shape, Marks, buttings and boundings as the above Plat represents, Survey 3. Nov. 1785, Recorded 9th Nov. 1785, — by Joseph Whitner D.S.

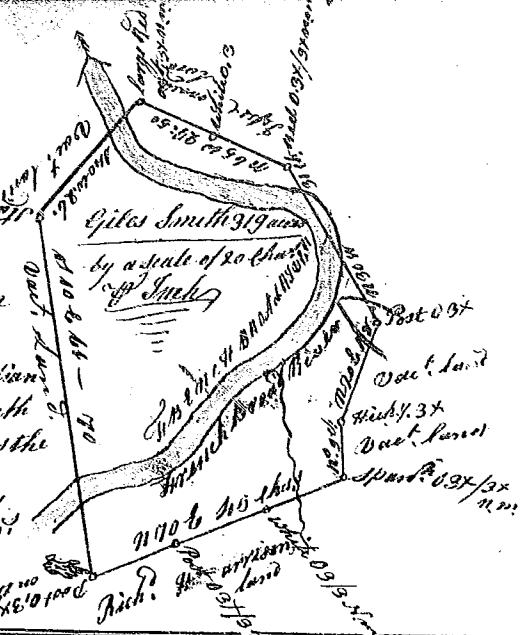

State of S. Carolina Pursuant to a warrant laid down by a from John Thomas Esq. Commis. of locati. State of 20. Oct. 1785, I have admeasured and laid out unto Simon Needer a tract of one hundred and thirty acres of land, situate in 96 District below the ancient boundary, on Kings creek, bounded NW. by Needer John goods and Charles Kings lands, Part towards S. by Mulikin Monroes, Part towards SW. by William Naylor's land, all other sides by vacant land and hath such shape, and Marks as the above Plat represents, Survey 28. Oct. 1785, Recorded 9 Nov. 1785, — by Phil. Waters D.S.

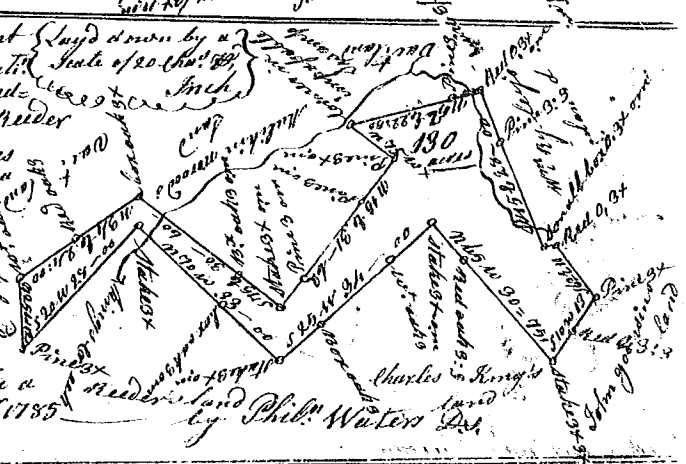

State of S. Carolina Pursuant to a warrant from John Thomas Esq. of loc. dated 15. Sept. 1785 I have admeasured and laid out unto William Naylor a tract of one hundred and thirty acres of land on Kings creek waters of Enoree, and hath such shape and Marks buttings and boundings as the above Plat represents 3. Oct. 1785, Recorded 9th Nov. 1785, — Phil. Waters D.S.

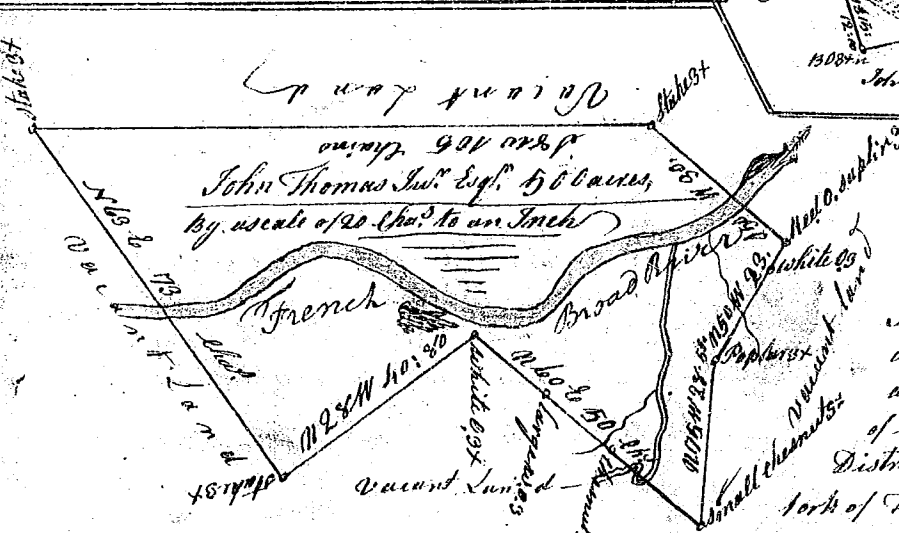
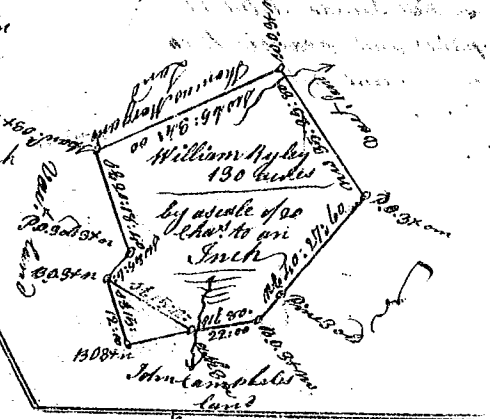

Pursuant to a warrant from John Thomas Esq. Commissioner of locations Dated the 15th Oct. 1785, I have admeasured and laid out unto John Thomas Esq. a tract of five hundred acres of land, situate in Ninety six District, on both sides of the East fork of French broad River, all sides on vacant land, — and, hath such shape, Marks, Buttings and boundings as the above Plat represents, Survey 9. Nov. 1785, Recorded 10th Nov. 1785, — by Joseph Whitner D.S.

State of South Carolina. Pursuant to a warrant from John Thomas Esq. Commissioner of locations dated the 15th Oct. 1785, I have admeasured and laid out unto John Thomas Esq. a tract of five hundred acres of land, situate in Ninety six District, on both sides of the East fork of French broad River, all sides on vacant land, — and, hath such shape, Marks, Buttings and boundings as the above Plat represents, Survey 9. Nov. 1785, Recorded 10th Nov. 1785, — by Joseph Whitner D.S.