

State of S^c Carolina, Pursuant to a Warrant from John Thomas Esq^r Commissioner dated 18 June 1785, I have admeasured and laid out unto William Oneal a tract of land containing three hundred and fifty three acres in 96 Dist^t on waters of Bushriver, and hath such shape, Marks, Buttings and Boundings as the above Plat Represents, Survey^d 15 July 1785, Phil^l Waters Esq^r Recorded 13th Oct^r 1785

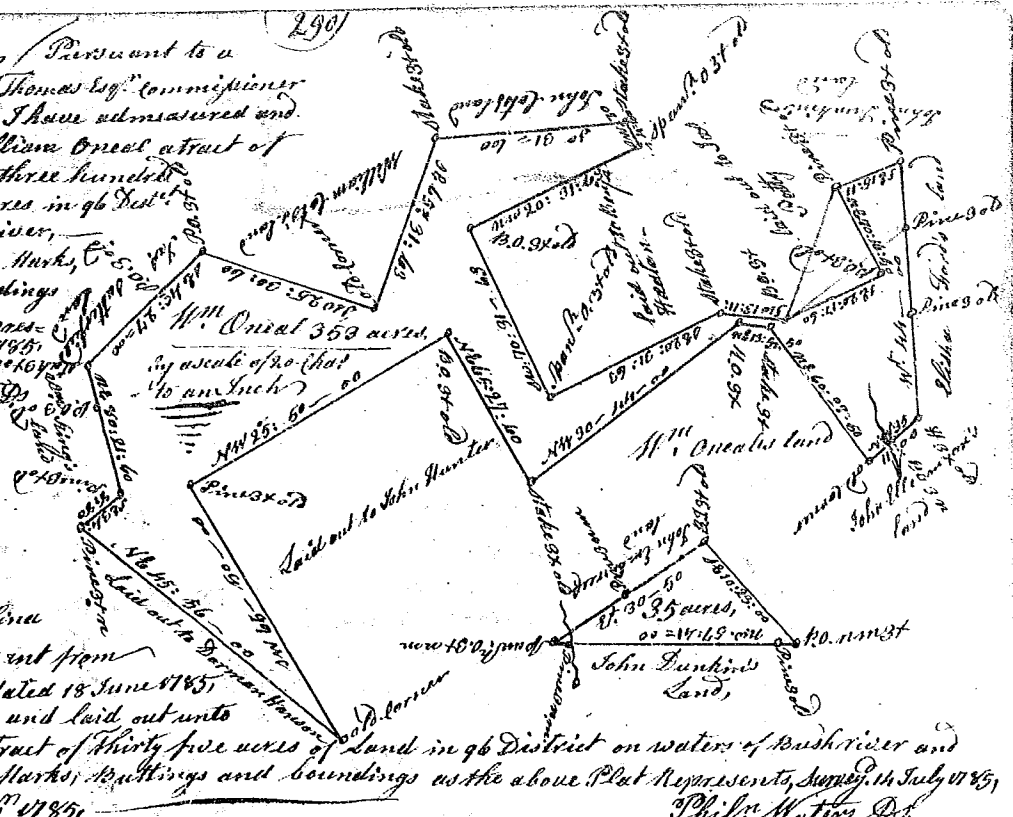

State of South Carolina Pursuant to a warrant from John Thomas Esq^r dated 18 June 1785, I have admeasured and laid out unto William Oneal a tract of thirty five acres of Land in 96 District on waters of Bushriver and hath such shape, Marks, Buttings and Boundings as the above Plat Represents, Survey^d 14 July 1785, Recorded 13th Oct^r 1785, Phil^l Waters Esq^r

State of S^c Carolina Pursuant to a warrant from John Thomas Esq^r Commissioner of Locations dated 9 Aug^t 1785, I have admeasured and laid out unto Robert Lee a tract of Land containing two hundred and twenty acres, Situate in Ninety six part^s on the branches of Pacolat^e R^{iv} east of the Indian boundary line and hath such shape, form and Marks as the above Plat Represents, Survey^d 22 Sept^r 1785 by Jesse Connell Esq^r Recorded 13th Oct^r 1785

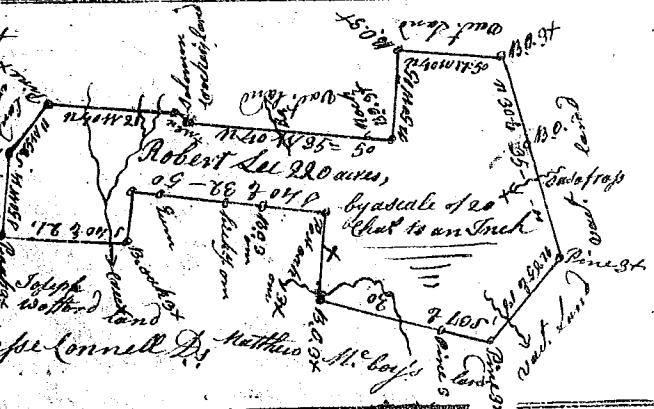

State of S^c Carolina Pursuant to a warrant from John Thomas Esq^r dated 17 April 1785, I have admeasured and laid out unto Nelson Dunkin a tract of two hundred and fifty acres of land, in 96 District on waters of Bushriver, and hath such shape, Marks, Buttings and Boundings as the above Plat Represents, Survey^d 16 June 1785 Joseph Wright Esq^r Recorded 13th Oct^r 1785



State of South Carolina, Pursuant to a warrant from John Thomas Esq^r dated the 25th July 1785, I have admeasured and laid out unto Marmaduke Maypole a tract of two hundred and ten acres of land Situate in 96 District on waters of Bushriver, and hath such shape, Marks, Buttings and Boundings as the above Plat Represents, Survey^d 25th Aug^t 1785 by Joseph Wright Esq^r Recorded the 11th Oct^r 1785

