

State of South Carolina N. Saluda, below the Indian Boundary,

Pursuant to a warrant from John Thomas Esq. Commissioner of locations, I have admeasured and laid out unto James Abrams a tract of one hundred and twenty one acres of land, situate on a small branch of Dumars Creek, bounding N. on land laid out to Col. Kirkland, W. by James Abrams's land, all other sides on vacant land, and hath such shape and marks as the above Plat represents, SURVEY, 10 Aug. 1785, Recorded the 27th Oct. 1785,

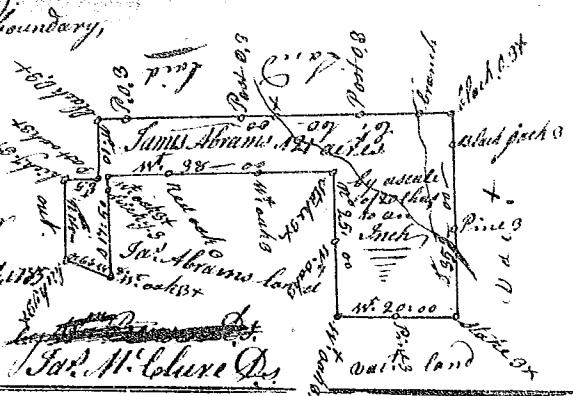

John Thomas Esq. Commissioner of locations

State of South Carolina, Ninety Six District,

Pursuant to a warrant from John Thomas Esq. Commissioner of locations N. Saluda River, I have admeasured and laid out unto Henry Davis a tract of land containing fifty acres, situate on Enoree River bounding N. & W. on said river, W. on Jacob Duckett's land, and hath such shape and marks as the above Plat represents, SURVEY, 8 Aug. 1785, Recorded the 8th Oct. 1785,



John Thomas Esq. Commissioner of locations

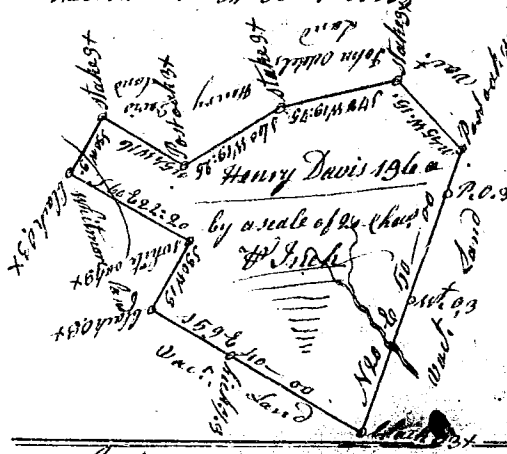

State of South Carolina, Pursuant to a warrant from John Thomas Esq. Commissioner of locations in 96 District N. Saluda River I have admeasured and laid out unto Henry Davis a tract of one hundred and ninety six acres of land lying on a small branch of Enoree River, below the Indian boundary, bounding W. on John Odell's land S. & E. on Whitmores land, all other sides on vacant land, and hath such shape and marks as the above Plat represents, SURVEY, the 9th Aug. 1785, Recorded 28 Oct. 1785, John Thomas Esq. Commissioner of locations

State of S. Carolina, Pursuant to a warrant from John Thomas Esq. Commissioner of locations dated the 3 Sept. 1785, I have admeasured and laid out unto Haglin Langston a tract of three hundred and seventy four acres, situate in Ninety six District, above the old boundary line on both sides of Richland Creek of Needy River, and hath such shape, marks, cuttings and boundings as the above Plat represents, SURVEY, 27 Sept. 1785, Joseph Whitner D. S. Recorded 10 Oct. 1785,

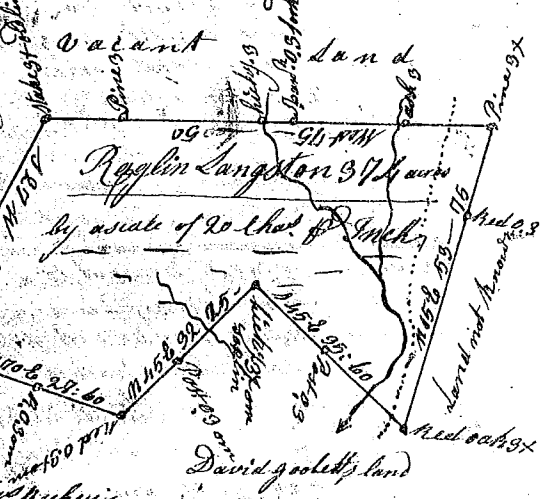

State of S. Carolina, Pursuant to a warrant from John Thomas Esq. Commissioner of locations dated 3 Sept. 1785, I have admeasured and laid out unto Haglin Langston a tract of nineteen acres of land situate in Ninety six District above the old boundary on both sides of a branch of Richland Creek of Needy River, and hath such shape, marks, cuttings and boundings, as the above Plat represents, SURVEY, 27th Sept. 1785, By Joseph Whitner D. S. Recorded 10th Oct. 1785,

State of S. Carolina, Union County, Pursuant to a warrant from John Thomas Commissioner of locations in 96 District N. Saluda, I have admeasured and laid out unto Henry Nequire a tract of one hundred and fifty acres of land, situate in 96 District on Hughes Creek, bounded N. on land laid out to Mary Nequire, N. & E. on James Mt. Crains land and S. on Henry Nequire's land, all other sides on vacant land, and hath such shape and marks as the above Plat represents, SURVEY, 30 Sept. 1785, W. Gaston D. S. Recorded 17th Oct. 1785, Del. Samuel Smith

