

State of S. Carolina Pursuant to a ²⁷⁹

Warrant from John Thomas Esq. Com. of Locations dated 4th Sept. 1785, I have admeasured and laid out unto Thomas Mays a tract of land containing Three hundred acres, situate on the North side of Fairforest Creek on Rocky Creek a branch of Fairforest in 96 District. Bounded N^o by land laid out for Lackey & Bell, and an old line all other sides vacant land, and hath such shape and Marks as the above Plat Represents, Surveyed this 25th Sept. 1785 by And^o Thomson Esq. Recorded 23rd Sept. 1785.



D. Sul.

State of S. Carolina 96 District N^o of Saluda, East of the old Boundary line. Pursuant to a warrant from John Thomas Esq. Com. of Locations dated the 7th July 1785, I have admeasured & laid out unto William Thomas (son of John) a tract of 150 acres of land, situate lying & being on the branches of Mores Creek of Enoree River, Bounded Southwardly by Sa m^e C^o B^oincy & W. W. W. hills land & on other sides Vacant & hath such shape form & marks as the above plat Represents. Surveyed this 10th August 1785 by James Wofford Esq. Recorded 20th Sept. 1785.

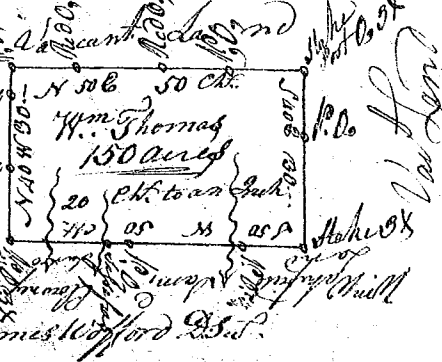

State of South Carolina Pursuant to a warrant from John Thomas Esq. Com. of Locations in 96 District N^o of Saluda. I have admeasured & laid out unto Nathaniel Gordon a tract of two hundred acres of land, Bounded on a small branch of the Hunting fork of Indian Creek, in Newberry County, Having such shape & marks, Bounding & B^oundings as the above plat Represents, Surveyed this 12th Aug. 1785, Robert Hanna Esq. Recorded 29th Sept. 1785.

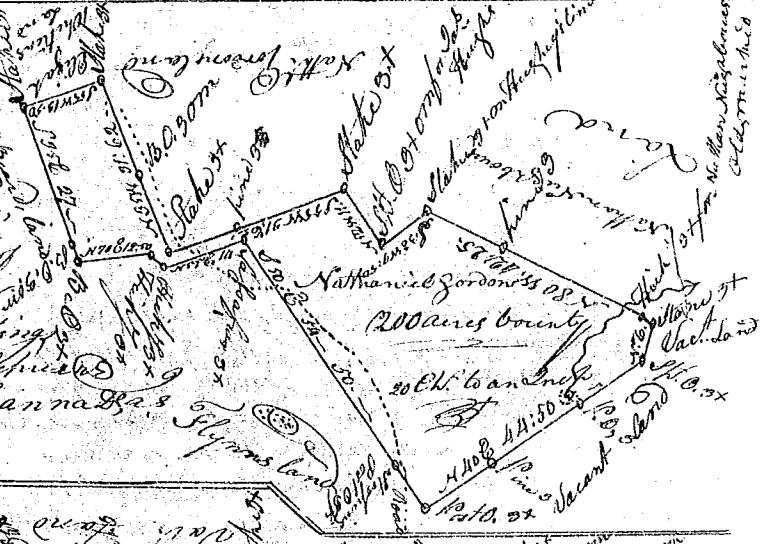

State S. Carolina Pursuant to a warrant from John Thomas Esq. Com. of Locations in 96 District N^o of Saluda. I have admeasured & laid out unto Nathaniel Gordon a tract of One Hundred Eighty acres of land, On the S^o fork of Duncan's Creek in Laurens County, Having such shape, marks, Bounding and B^oundings as the above plat Represents. Surveyed this 25 July 1785.



Recorded this 29th of September 1785

Robert Hanna Esq. Deput.