

State of S^c Carolina 96 district East of (200) the old boundary line between Tygar and Enoree Rivers, Pursuant to a warrant from John Thomas Esq. Commissioner of locations, Dated 20 July 1785, I have admeasured and laid out unto Sathiel Heaton a tract of land containing one hundred and fifty acres, lying on a small branch of Enoree River, and hath such Shape, Marks, buttings, and Boundings, as the above Plat Represents, Survey, 25 July 1785, Recorded 5th Sept. 1785, by And^r Thomson D^r.

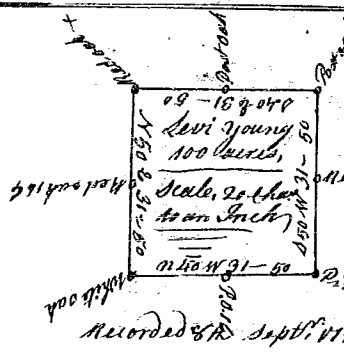

Pursuant to a warrant from John Thomas Esq. Commissioner of locations, for 96 district 96 side of Saluda River, I have admeasured and laid out unto Levi Young, a tract containing one hundred acres of land situate in ninety six district the north side of Saluda River, on Marchbanks Branch, Bounded on all sides on Vacant Land, and hath such Shape and Marks as the above plat Represents, Survey, 11th July 1785, by Bullback D^r.

State of S^c Carolina 96 district East of the ancient boundary line, Pursuant to a warrant from John Thomas Esq. Commissioner of locations dated the 20th July 1785, I have admeasured and laid out unto John Hunt a tract of land containing two hundred acres, situate on the south side of Tygar River, on the small branches of Jamies Creek, bounded S & E by Jonathan Simard's land, all other sides Vacant Land, and hath such Shape and marks as the above Plat Represents, Survey, 1st day of Aug. 1785, Recorded 8 Sept. 1785, by And^r Thomson D^r.

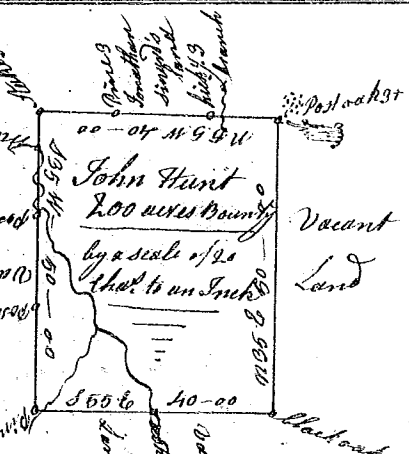

State of S^c Carolina Pursuant to a warrant from John Thomas Esq. Commissioner of locations I have admeasured and laid out unto John Cain a tract of 185 acres of land, situate in Union County 96 district below the ancient limits, on two small branches running into Tygar River, butting and bounding W by land laid out to Charles King D^r by John Pearson, John Townson, and Bernard Young, S & E by Matthew Kelly, N by Vacant Land, and hath such Shape and Marks as the above Plat Represents, Survey, the 22 day July 1785, Recorded 8 Sept. 1785, by John Townson D^r.



State of South Carolina Pursuant to a warrant from John Thomas Commissioner of locations I have admeasured and laid out unto John Cain a tract of 173 acres of land, situate in Union County 96 dist^{ct} below the ancient limits, on a small branch of Enoree river, butting & bounding S & E on land laid out for Abel Pearson and Robt Watkins, N by Matthew Kelly, NW by John Townson & Verance Pearson, and hath such Shape and marks as the above plat Represents, Survey, 20th July 1785, Recorded 9th Sept. 1785, by Abel Pearson D^r.



State of South Carolina Pursuant to a warrant from John Thomas Esq. Commissioner of locations, I have admeasured and laid out unto John Cain a tract of 69 acres of land, situate in Union County 96 dist^{ct} below the ancient limits, on a small branch running into Enoree river butting and bounding E on land laid out to Sam Townson & on North side of Enoree all other sides on Vacant Land, and hath such Shape and Marks as the above Plat Represents, Survey, the 25th July 1785, Recorded the 9th Sept. 1785, by Abel Pearson D^r.

