

State of S. Carolina Pursuant to a warrant (212) from John Thomas Esq. Lt. dated the 6th August 1785. I have admeasured & laid out unto Andrew Rogers a tract of One Hundred & Eighty two Acre of Land on a branch of Dunbar Creek below the old boundary bounding the same on lands formerly held by William Taylor Esq. on the East of Andrew Rogers & West on St. Rogers & John Harveys & hath such shape & marks as the annexed plat represents.

Surveyed this 9th August 1785
 Recorded this 25th August 1785
 Delivered to Andrew Rogers

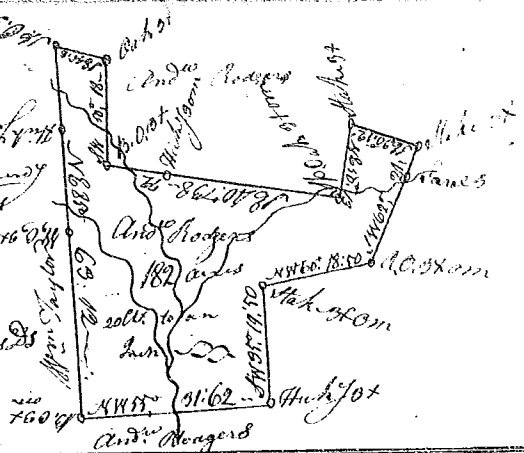

State of S. Carolina Pursuant to a warrant from John Thomas Esq. Com. Locations, I have admeasured & laid out unto Archelus Kenedy a tract of 34 Acres of Land situate in 96 District in Union County below the ancient boundary on the S. Side of Logar River & hath such shape marks & Boundings as the annexed plat represents. Surveyed this 24 August 1785
 Recorded this 25th August 1785 Del. Sam. Cooper

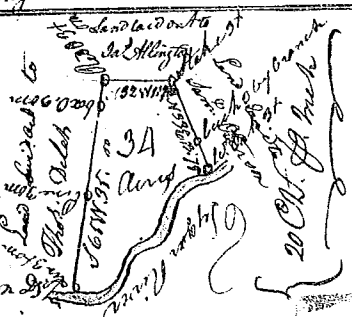

State of S. Carolina. 96 District East of the Old Boundary Pursuant to a warrant from John Thomas Esq. Com. Locations (Date 23rd August 1785. I have admeasured & laid out unto William Young a tract of land containing One Hundred & Seventy two Acres of Situation in Union County in Laurens County on both sides of Serbins Creek a branch of Enoree River & hath such shape marks & Boundings as the annexed plat represents. Surveyed this 24 August 1785
 Recorded this 25th Aug 1785
 Delivered to William Young

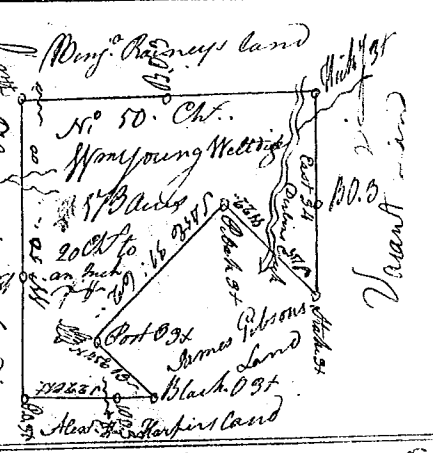

State of South Carolina Pursuant to a warrant from John Thomas Esq. Com. Locations (Dated August 17th 1785. I have admeasured & laid out unto Archelus Kenedy a tract of Two Hundred & Thirty Two Acre of Land. Situate in Union County & in 96 District below the ancient limits on three small branches of Enoree River & hath such shape marks & Boundings as the annexed plat represents. Surveyed this 24 Aug 1785
 Recorded this 26 Aug 1785
 Del.

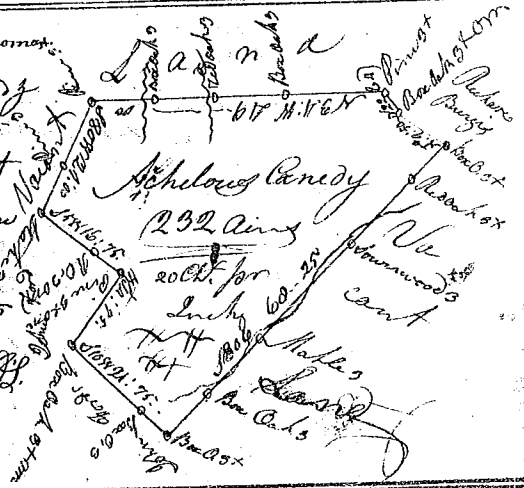

State of S. Carolina Pursuant to a warrant from John Thomas Esq. Lt. I have admeasured & laid out unto Robert Smith a tract of 300 Acres of Land situate in 96 District on the forks of Fanning's Creek Waters of Broad River & hath such shape marks & Boundings as the annexed Plat represents. Surveyed this 18th July 1785
 Recorded this 26th Aug 1785
 Del. Mary M. Jones takes this 26th away

