

State of South Carolina Pursuant to a warrant (206) from John Thomas Esq. I have admeasured & laid out unto Abel Pearson a tract of 183 acres of land, situation in 96 District Union County, On Enore River, Below the old Boundary Boundary W. by Enore River, N. by Enore River & John Isaac East by Abel Pearson & John Isaac Division, & hath such shape & marks as the annexed Plat Represents, Surveyed this 21<sup>st</sup> July 1785.

Recorded 15<sup>th</sup> Aug. 1785  
 Abel Pearson

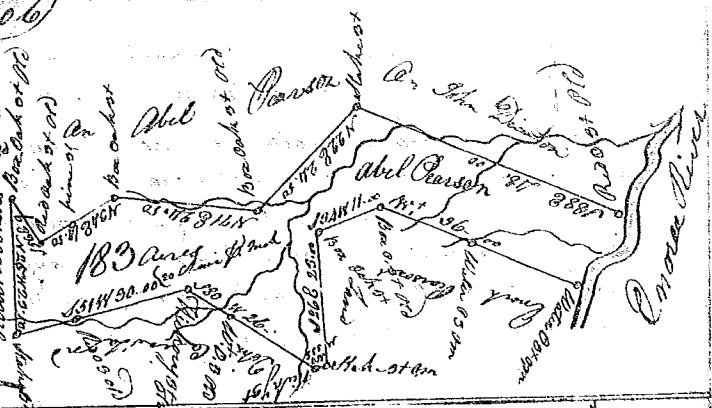

State of South Carolina Pursuant to a warrant from John Thomas Esq. Comr. of the Court of Sessions dated the 8<sup>th</sup> of August 1785 I have admeasured & laid out unto David James a tract of Land containing fourteen acres & two by seven Acres, situate in vicinity in District East of the present Boundary, on Sycamore Creek of Lawsons Fork of Parlate River, and hath such shape, marks, & boundaries as they above Plat Represents to Surveyed this 11<sup>th</sup> of August 1785.

Recorded this 15<sup>th</sup> of Aug. 1785  
 Wm. Benson Esq.  
 Surveyor for the County

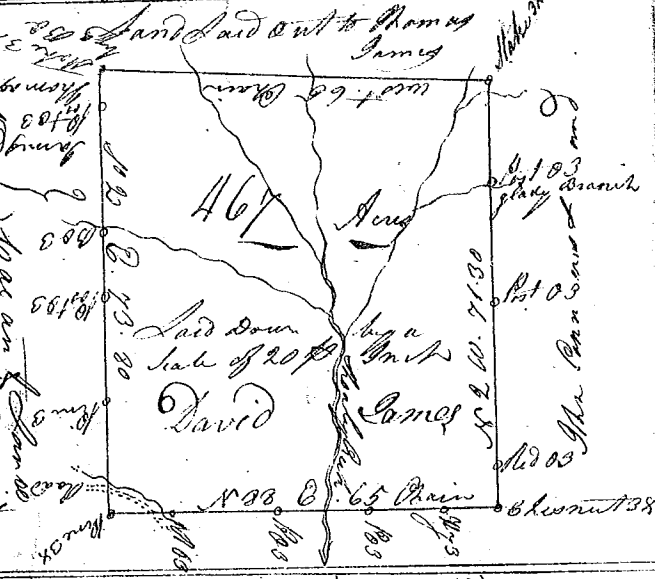

South Carolina Pursuant to a Warrant from John Thomas Esq. Comr. bearing date the 29<sup>th</sup> July 1785. I have admeasured & laid out unto Mary Horton a tract of land on Island Creek Waters of Broad River containing 640 Acres, situate in 96 District N. of Saluda, bounded N. by Lands of Daniel McDaniels S.W. by vacant Land & lands of Thomas Siding East by vacant Land, & hath such shape form & marks as the annexed Plat Represents, Surveyed this 12<sup>th</sup> Aug. 1785.

Recorded this 16<sup>th</sup> Aug. 1785  
 Laska Bullock Esq.  
 Surveyor

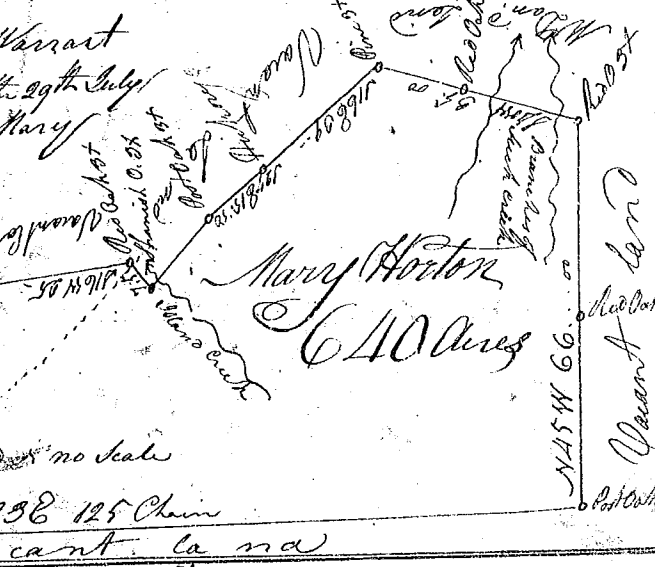

State of South Carolina 96 District Pursuant to a Warrant to Me Directed by John Thomas Esq. Comr. I have admeasured & laid out unto Hannah Horton a tract of Land containing six thousand & seven hundred acres, situate lying & being in 96 Dis. N. of Saluda, Below the old Boundary, On Cherokee Creek, bounded N. by an old Line all other sides on vacant Land & hath such shape & marks as the annexed Plat Represents, Surveyed this 10<sup>th</sup> Aug. 1785.

Recorded the 16<sup>th</sup> August 1785  
 Laska Bullock Esq.  
 Surveyor

