

State of S^c Carolina

(264)

Pursuant to a warrant from John Thomas Esq. Commissioner of locations, dated the 30 day of June 1785, I have admeasured and laid out unto John Miller tract of Two hundred and fifteen acres of land situate in ninety six district on both sides of Mush Creek of Tygar river, and hath such shape, Markes, butings and boundings as the above Plat Represents, Survey: the 2^d July 1785,

Recorded 18th Aug^t. 1785 by George Salmon D^s.

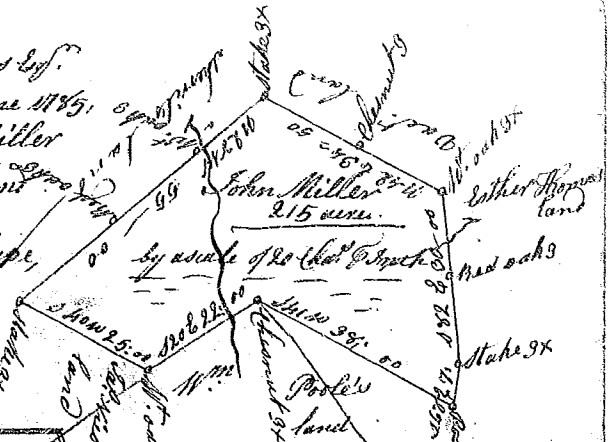

State of S^c Carolina

Pursuant to a warrant

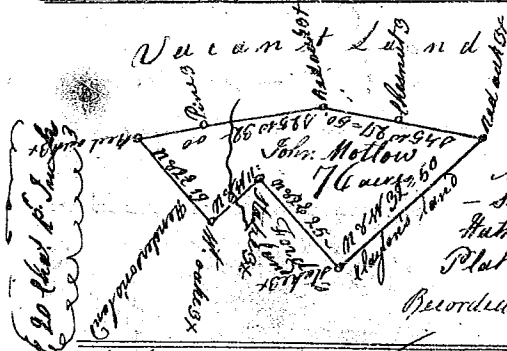

from John Thomas Esq. Commissioner of locations dated 21st day of June 1785, I have admeasured and laid out unto John Mollow tract of seventy six acres of land, situate in ninety six district on a branch of Checharod river of Saluda, and hath such shape, Markes, butings and boundings as the above Plat Represents, Survey: 20th July 1785,

Recorded 12th Aug^t. 1785 by George Salmon D^s.

State of S^c Carolina Pursuant to a warrant from John Thomas Commissioner of locations dated the 9th day of June 1785, I have admeasured and laid out unto Samuel Harper tract of one hundred acres of land, situate in ninety six district on both sides of South Pacolat river, and hath such shape, Markes, butings and boundings as the above Plat Represents, Survey: 23 July 1785, George Salmon D^s.

Recorded 18th Aug^t. 1785

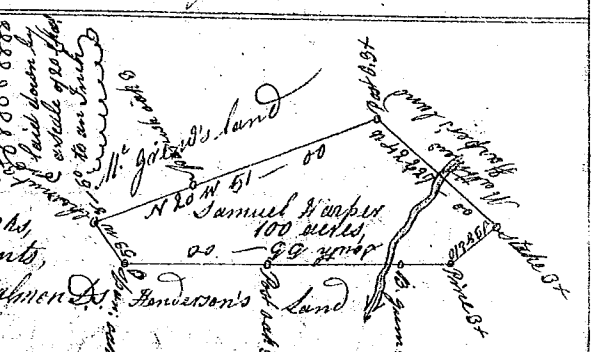

State of S^c Carolina Pursuant to a warrant from John Thomas Commissioner of locations I have admeasured and laid out unto Philip Aubrey tract of four hundred & eighty acres of land, situate in ninety six district on the waters of Tygar river Bounding N.W. on land laid out to Wm. Carleton & Hill's land & Aubrey Noland's land, S.E. on Jeremiah ocain's land on Wm. Hill's land & land laid out for Wm. Carleton, S.W. on Jeremiah ocain & N.E. on Aubrey Noland's land, and hath such shape and Markes as the above plat Represents, Survey: 10th of Aug^t. 1785 by Geo. Glenn D^s.

Recorded 12th Aug^t. 1785

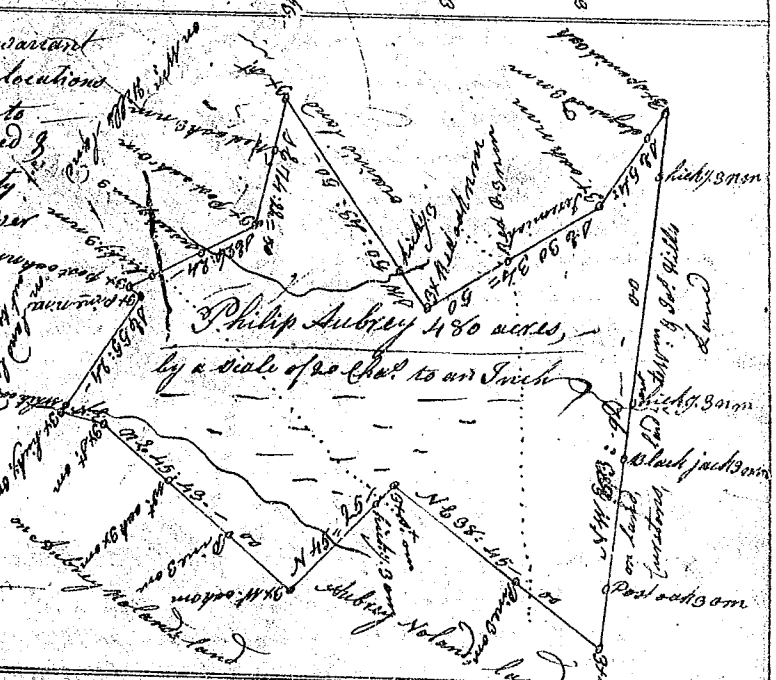

State of S^c Carolina Pursuant to a warrant from John Thomas Esq. Commissioner of locations dated 15th June 1785, I have admeasured and laid out unto John Justice, Sr. tract of ninety five acres of land, situate in ninety six district on both sides of Beaverdam Creek of Enoree river, and hath such shape, Markes, butings and boundings as the above plat Represents, Survey: 29th July 1785, by John Young Esq. D^s.

Recorded the 12th Aug^t. 1785

