

State of S. Carolina 96 District on the West side of the ancient Boundary line Pursuant to a Warrant from John Thomas Esq. Com. of Locations Dated the 27th May 1785 I have Admeasured & laid out unto Joseph Reed a tract of Land containing Three Hundred & thirty Acres lying on both sides of Rocky Creek a branch off Ruddy River Bounded to the S. E. by Land laid out to Jos Reed NW by Nathaniel Reids Land all other sides on Vacant Land. & hath such Shape & marks as the above plat Represents.

Surveyed this 31st May 1785. Andrew Thomson Esq. Recorder the 8th August 1785.

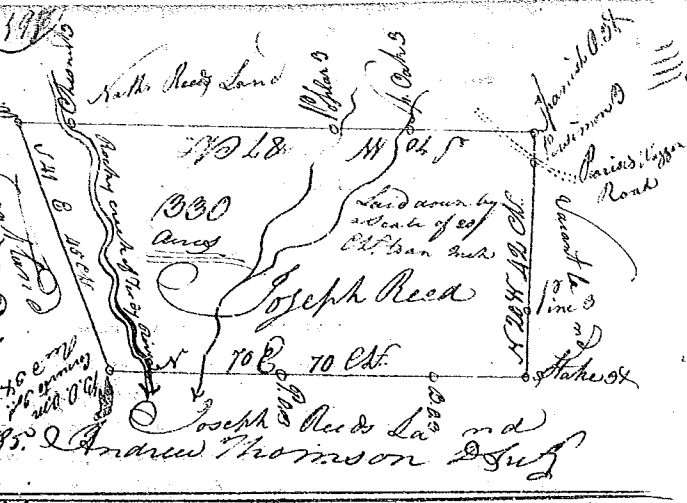

State of S. Carolina Ninety six District N. of Saluda East of the Old Boundary line Pursuant to a Warrant from John Thomas Esq. Com. of Locations Dated the 14th day of June 1785. I have Admeasured & laid out unto Elisha Garland a tract of 640 Acres of Land Situate lying & being on the N. side of Ferguson's Creek Waters of Ruddy River Bounded by James Peairs Land East by Old Lines all other sides by Vacant Land. & hath such Shape & marks as the annexed plat Represents. Surveyed this 15th June 1785.

W. Wofford Esq. Recorder the 8th Aug. 1785. Elisha Garland

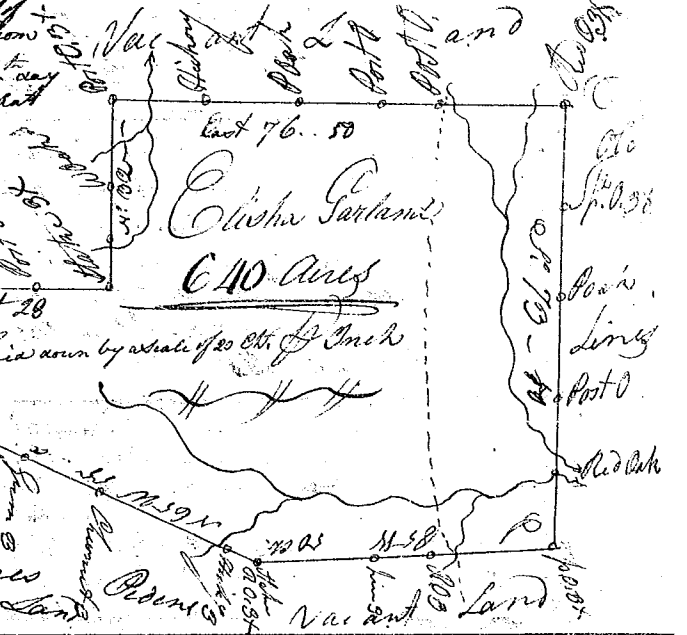

State of South Carolina 96 District On the East side of the ancient Boundary line on the S. side of Fairforest Creek, Pursuant to a Warrant from John Thomas Esq. Com. of Locations for 96 District N. of Saluda Dated the 21st May 1785. I have Admeasured & laid out unto Sam Archibald a tract of Land containing One Hundred & twenty Acres Situate lying & being on the S. side of Fairforest above mentioned & on the Branches of R. Creech Bounded Westly by Andrew May's Land S. by Sam. Patterson Land & hath such Shape & marks as the annexed plat Represents. Surveyed this 20th May 1785. Recorded this 8th of August 1785.



State of South Carolina 96 District On the West side of the ancient Boundary Pursuant to a Warrant from John Thomas Esq. Com. of Locations Dated the 27th May 1785. I have Admeasured & laid out unto Nathaniel Reed a tract of Land containing One Hundred & twenty Acres lying on Rocky Creek, Bounded E. by Joseph Reed's Land all other sides Vacant Land & hath such Shape & marks as the annexed plat Represents. Surveyed this 27th day of June 1785. Andrew Thomson Esq. Recorder this 8th day of August 1785.



State of South Carolina Pursuant to a Warrant from John Thomas Esq. Com. of Locations Dated the 28th May 1785. I have Admeasured & laid out unto Robert Milliken a tract of One Hundred & twenty Acres of Land Situate in 96 District on the S. side of R. Creek & hath such Shape marks Outlines & Boundings as the Annexed plat Represents. Surveyed the 25 June 1785. Recorded the 8th August 1785. George Salmon Esq.