

State of S. Carolina Pursuant to a Warrant (191)  
 from John Thomas Esq. Comr. of Locations in 96 District N<sup>o</sup>  
 of Saluda River, I have admeasured & laid out unto Robert Gilliam  
 a tract of Two Hundred & forty three acres on a small  
 branch of Saluda River the Indian Boundary Bounding  
 N.E. on Saml. Proctors land 548 on land laid out to Saml.  
 Myatt and William Diegenonland W on George Kileys  
 S.W. on James Maysonland all other sides on vacant  
 Land & hath such shape & marks as the annexed plat  
 represents. Surveyed the 28 July 1785  
 Recorded the 2<sup>d</sup> August 1785 Robert Hannan Esq.

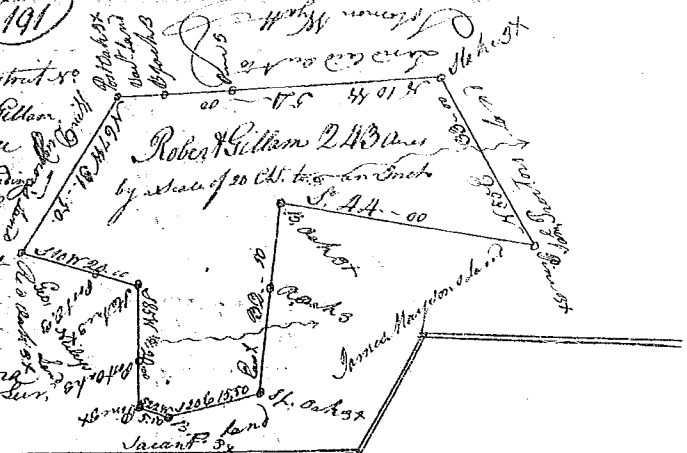

State of S. Carolina Pursuant to a Warrant  
 from John Thomas Esq. Comr. of Locations  
 in Ninety six District N<sup>o</sup> of Saluda  
 I have admeasured & laid out unto  
 John Gray a tract of three hundred  
 and twenty five acres of  
 Land on Dumans creek in  
 Laurens County. Having  
 such shape marks & Bittings  
 & Bounding as the annexed plat Repre-  
 sents. Surveyed the 1<sup>st</sup> August 1785  
 Recorded the 2<sup>d</sup> August 1785 Robert Hannan Esq.  
 & delivered to John Gray

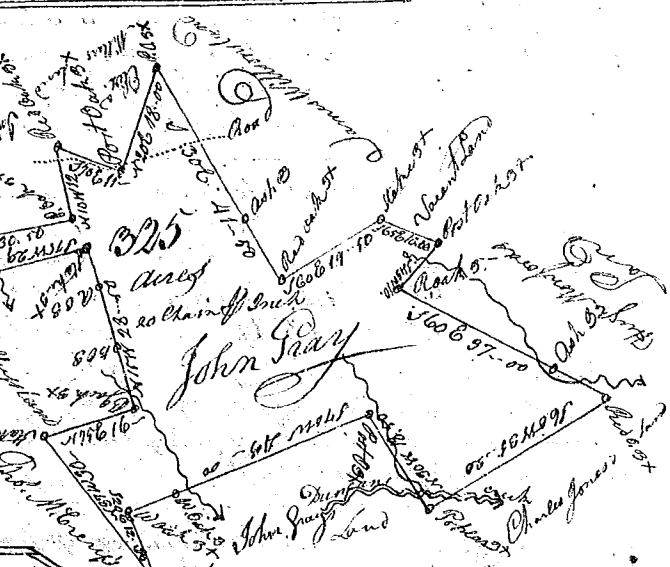

State of S. Carolina Pursuant to a Warrant  
 from John Thomas Esq. Commissioner of Locations in 96 District N<sup>o</sup> of  
 Saluda River, I have admeasured & laid out unto Doctor George Ross a  
 Tract of one hundred acres of land on Saluda River County & on a small  
 branch of Dumans Creek, Bounding N.W. & N.E. on George Ross's Land & part  
 on Elias Craigs land all other sides Vacant & hath such shape & marks  
 as the annexed plat represents. Surveyed the 11<sup>th</sup> May 1785  
 Recorded the 2<sup>d</sup> August 1785 Robert Hannan Esq.

State of South Carolina Pursuant to a Warrant from John  
 Thomas Esq. Comr. of Locations in 96 District N<sup>o</sup> of Saluda River  
 I have admeasured & laid out unto James Caldwell a Tract of two  
 Hundred & fifty five acres of land on the head fork  
 of the Little fork of Deepdy River above the Indian Boundary  
 Bounding N.E. on land laid out to Robert Gilliam all other  
 sides on Vacant Land & hath such shape & marks as the annexed  
 plat represents. Surveyed the fifth day of July 1785  
 Recorded the 2<sup>d</sup> August 1785 Robert Hannan Esq.

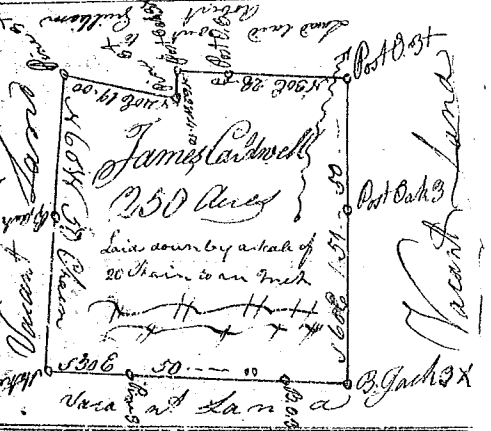

State of S. Carolina Pursuant to a Warrant from  
 John Thomas Esq. Comr. in 96 District N<sup>o</sup> of Saluda River  
 I have admeasured & laid out unto James Caldwell a  
 Tract of 250 Acres of land on a small branch of the  
 Deepdy fork of Deepdy River above the Indian Boundary  
 Bounding N.W. on John Ryglers land S.E. on land laid out  
 to Robert Gilliam all other sides on vacant Land &  
 hath such shape & marks as the annexed plat represents  
 Surveyed the fifth day of July 1785 Robert Hannan Esq.  
 Recorded the 2<sup>d</sup> August 1785

