

State of South Carolina Pursuant to a Warrant from John Thomas Esq. Commissioner of Locations for 96 District. I have admeasured & laid out unto Capt. Daniel McEluff a tract of Land containing two hundred acres situated in the first precinct & hath such shape & marks as the annexed plat represents. Surveyed this 17th June 1785. Recorded the 1st day of June 1785. R. Hopkins Del.

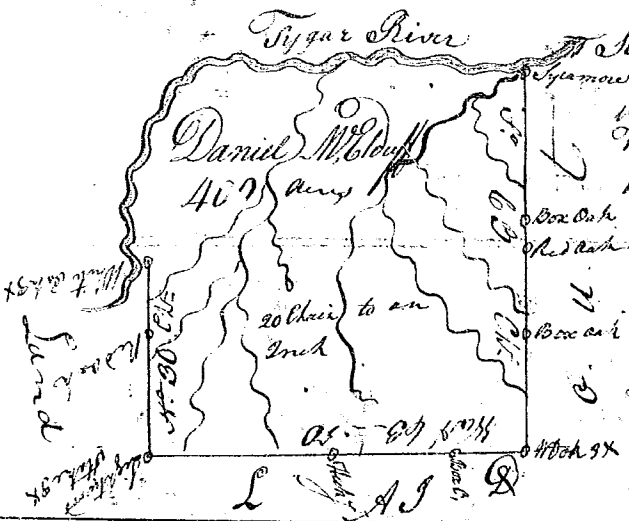

Pursuant to a Warrant from John Thomas Esq. Commissioner of Locations for 96 District. I have admeasured, and laid out unto Capt. Daniel McEluff a tract of Land containing four hundred acres situated in the District aforesaid, hath such shape form & marks as the annexed plat represents. Surveyed this 17th June 1785. R. Hopkins Del. Recorded the 2nd day of August 1785.

State of South Carolina Pursuant to a warrant from John Thomas Esq. Commissioner of Locations in 96 District of Saluda. I have admeasured &

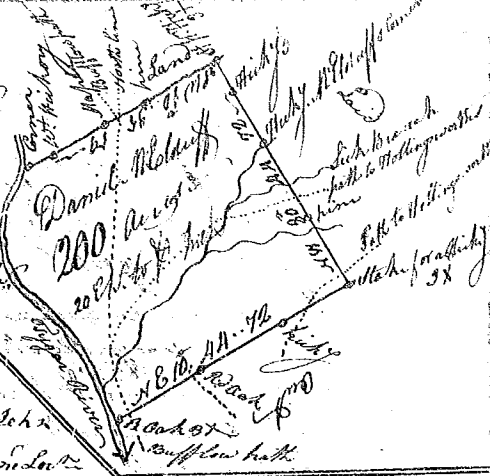
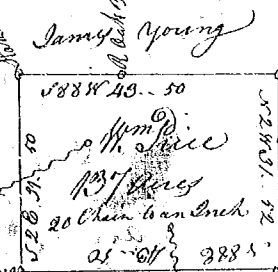

Laid out unto William Price a tract of One Hundred & Thirty seven acres of Land on the Branch of Millers fork of Duncan's creek in Laurens County. Bounding East and South on land laid out to James Young W. on Patrick Bryan's Land S. on Wm. Price's Land & hath such shape & marks as the annexed plat represents. Surveyed the 22nd July 1785. Recorded the 2nd day of August 1785. Robert Hanna Del.

State of South Carolina Pursuant to a warrant from John Thomas Esq. Commissioner of Locations in 96 District No. of Saluda. I have admeasured & laid out unto William Price a Tract of Ninety acres of Land in Laurens County on a small Branch of Duncan's creek. Bounding NW part on Wm. Hurdlefield's part. W part on Thomas H. H. land & part on William Williams's land NE part on Patrick Bryan's & part on land laid out to William Price and hath such shape & marks as the above Plat represents. Surveyed the 23rd May 1785. Recorded this 2nd day of August 1785. by Robert Hanna Del.

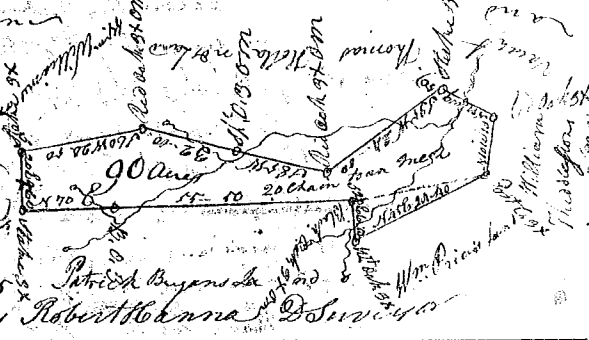

State of South Carolina Pursuant to a warrant from John Thomas Esq. Com. of Locations in 96 District N. side Saluda. I have admeasured & laid out unto James Adair a tract of One Hundred & forty four acres of Land on Enoree River in Laurens County. Bounding N. E. on said River NW on land laid out to Wm. Miller all other sides vacant land & hath such shape & marks as the annexed plat represents. Surveyed the 15th June 1785. Recorded on the 2nd day of August 1785. R. Hanna Del.

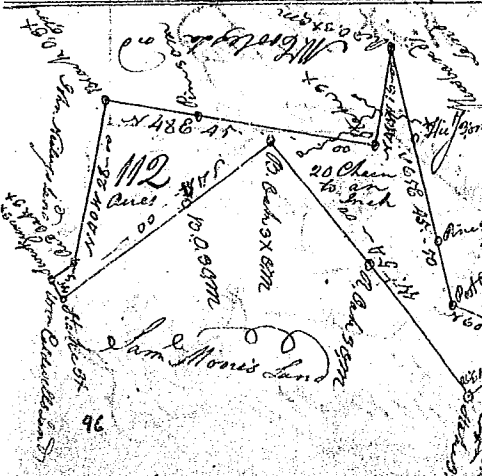
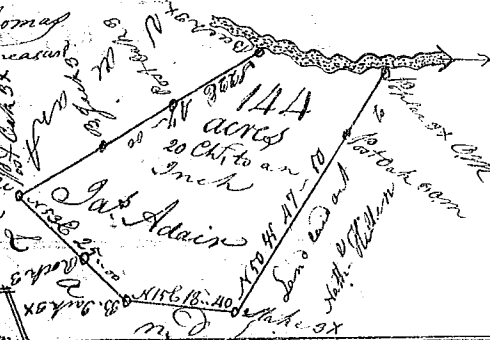

State of South Carolina Pursuant to a Warrant from John Thomas Esq. Commissioner of Locations in 96 District No. of Saluda. I have admeasured & laid out unto Robert Selham a tract of One Hundred & twelve Acres of Land on the a little creek a Branch of Little River, Below the Indian Mountain. Bounding NW on Saml. Moores Land NE on a M. Coos's Land SE on Wm. Young's Land & Land W. on Elizabeth Williams's Land & on W. on Saml. Moores & William Calcutt's Land and hath such shape & marks as the annexed plat represents. Surveyed the 29th day of July 1785. Recorded the 2nd day of August 1785. Robert Hanna Del.