

State of S^c Carolina. Pursuant to a
 Warrant from John Thomas Esq. Com^r of
 Locations Dated the 2nd July 1785. I have
 admeasured & laid out unto Isaac Horton
 a Tract of Land containing Six Hundred
 and Forty Acres. Situate in 96 District
 N^o of Saurida River & below the Old Boundary
 On the Waters of Thicketty Creek -
 Bounded on the N & West
 by Matthias M^r Bee's Land N^o by
 Vacant Land East by George Taylor
 & by Vandy M^r Bee & hath such Shake
 & marks as the above Plat Represents
 Survey'd this 6th July 1785
 D. Hopkins Deput^y
 Recorded the 30th July 1785

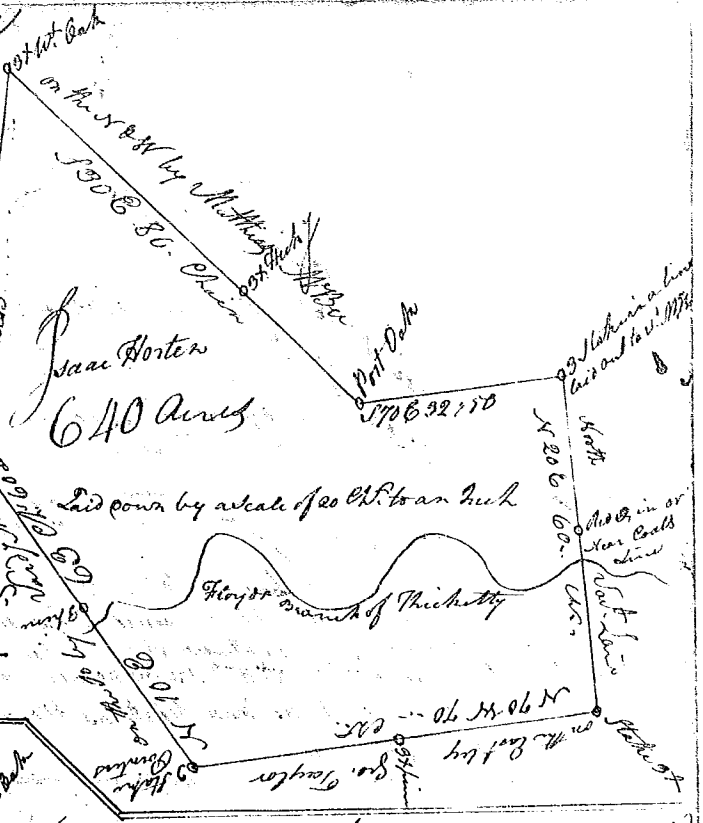

Land laid out in N^o Carolina
 N 20 E 80 Chain
 Elizabeth M^r Bee
 640 Acres
 Laid down by a scale of
 20 Chain to an Inch
 Survey'd this 6th July 1785
 D. Hopkins Deput^y
 Recorded the 30th July 1785

State of S^c Carolina. Pursuant to a Warrant
 from John Thomas Esq. Com^r of Locations Dated the 2nd
 July 1785. I have admeasured & laid out unto Elizabeth
 M^r Bee a Tract of 640 Acres of Land. Situate in 96
 District N^o of Saurida River & below the Old bound-
 ary. Bounded on the N^o by N^o Carolina's outland
 on the East by Elizabeth M^r Bee's Land West by
 Vacant Land & hath such Shake & marks as
 the Annex'd Plat Represents Survey'd this 6th July 1785
 D. Hopkins Deput^y
 Recorded the 30th July 1785

State of S^c Carolina. Pursuant to
 a Warrant from John Thomas Esq. Com^r
 of Locations Dated I have admeasured
 & laid out unto Mary M^r Bee a Tract of
 Six Hundred & forty Acres of Land Situate
 in 96 District N^o of Saurida River. on the Waters
 of Thicketty Creek. Bounded N^o by Isaac M^r Bee
 West by Lucy M^r Bee. all other sides by
 Vacant Land & hath such Shake
 & marks as the Annex'd Plat Represents
 Survey'd this 2nd day of July 1785
 D. Hopkins Deput^y
 Recorded the 30th July 1785

