

State of S. Carolina. Pursuant to a

Warrant dated the 11<sup>th</sup> June 1785. from John Thomas Esq. Com<sup>rs</sup> of Locations & side Saluda. I have admeas<sup>d</sup> & laid out unto Aaron Guyton a Tract of One Hundred & Eighty five Acres of Land Situate in 96<sup>th</sup> District Below the Ancient Boundary Between Broad River & Abitong Creek Bounding on all sides on Vac. Land & hath such shape & marks as the above plat Represents. Survey'd this 19<sup>th</sup> day of June 1785. Recorded the 12<sup>th</sup> July 1785.

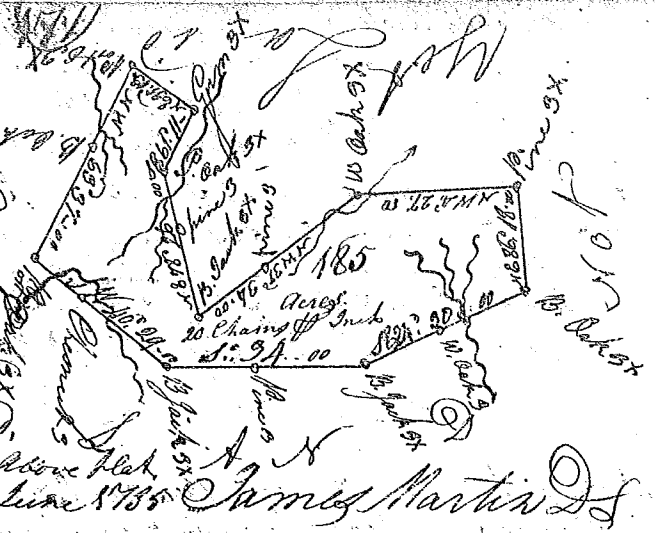

James Martin Esq.

State of South Carolina. Pursuant to a warrant from John Thomas Esq. Com<sup>rs</sup> of Locations & side Saluda dated the 11<sup>th</sup> June 1785. I have admeasured & laid out unto Moses Guyton a Tract of One Hundred & Sixty eleven acres of Land Situate in 96<sup>th</sup> District Below the Ancient Boundary on Abitong Creek Bounding on the South on Lark's Land & West on John Aratons Land & North on Labittory all other sides on vacant Land & hath such shape & marks as the above plat Represents. Survey'd this 19<sup>th</sup> June 1785. Recorded the 12<sup>th</sup> July 1785.



Aaron Guyton Paid the first 1/3 of his own & Moses Guyton's Fee.

State of South Carolina. Pursuant to a Warrant dated the 22<sup>nd</sup> April 1785 from John Thomas Esq. Com<sup>rs</sup> of Locations & side Saluda. I have admeasured & laid out unto Robert Gault a Tract of Seventy four Acres of Land Situate in 96<sup>th</sup> District Below the Ancient Boundary on the East Side of Pacolet River on Gault's branch Bounding on the West on Whorters & Gault's Land & on Arvies all other sides vacant & hath such shape & marks as the above plat Represents. Survey'd this 22<sup>nd</sup> day of April 1785. Recorded the 12<sup>th</sup> July 1785.

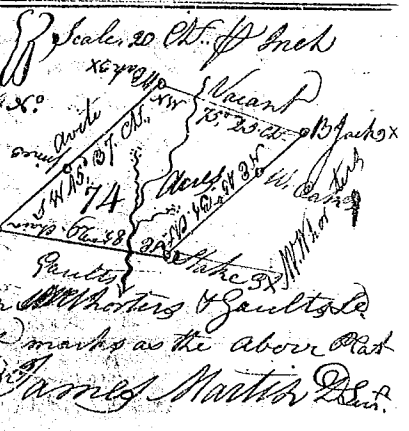

S. Carolina. Pursuant to a Warrant from John Thomas Esq. Com<sup>rs</sup> of Locations & side Saluda dated 3<sup>rd</sup> May 1785. I have admeasured and laid out unto Robert Montgomery a Tract of 200 Acres of Land Situate in Ninety six District Below the Ancient Boundary on Quincey's branch 1<sup>st</sup> side Broad River Bounding on the East on Cat. Kennedy & West on Kennedy all other sides vacant Land & hath such shape & marks as the above plat Represents. Survey'd this 3<sup>rd</sup> day of May 1785. Recorded the 12<sup>th</sup> July 1785.

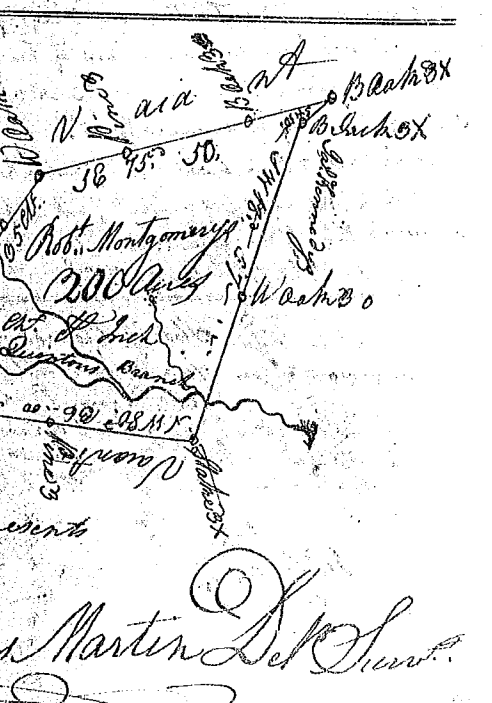

James Martin Esq.