

State of South Carolina 96 District side Saluda (1785)

Pursuant to a warrant from John Thomas Esq^r Com^r Locations, dated the 21st day of June 1785. I have admeasured & laid out unto Matthew Sanderson a tract of one hundred & ninety acres of land situate lying and being on the S^e side of Tygar River & bound N^e by S^e River, N^w by Wm. Duncans S^e by land call^d Meek's Land all other sides vacant land. I hath such shape form & marks as the annex^d plat represents

Survey^d this 21st day of June 1785 by Jas. Wofford Esq^r Recorder 24th June 1785 & Deliv^d to Mr. Allen



State of South Carolina Ninety six District

Pursuant to a warrant from John Thomas Esq^r Com^r Locations dated the 21st day of April 1785. I have admeasured & laid out unto Charles Moore a tract of land containing two hundred acres situate lying & being N^e of Saluda a branch of being Creek of Tygar River and bound N^e by Wm. Moore's land West by David Anderson's land all other sides on vacant land and hath such shape form & marks as the annex^d plat represents

Survey^d this 12th April 1785 by Jas. Wofford Esq^r Recorder the 24th June 1785 D^o Wm. Allen

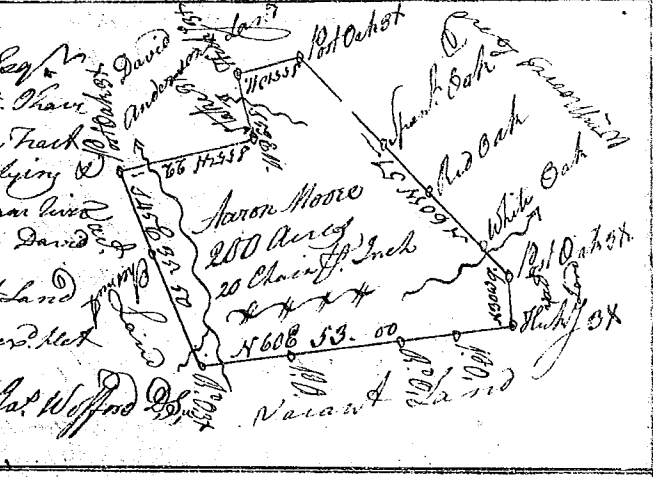

State of S^c Carolina

Pursuant to a warrant from John Thomas Commissioner of Locations, dated 10th April 1785, I have admeasured and laid out unto Jonathan Harris a tract of land containing three hundred & eighty five acres situate in 96 District on a branch of Chickety called Bullschoy fork East of the Indian Boundary bounded S^e & W by Patrick Moore's Land Est by Wm. Duncans & all other sides on vacant land & hath such shape & marks as the annex^d plat represents

Survey^d the 16th April 1785 by Jesse Cornell Esq^r Recorder 24th June 1785 by Jesse Cornell Esq^r 1st Lt. Colonel

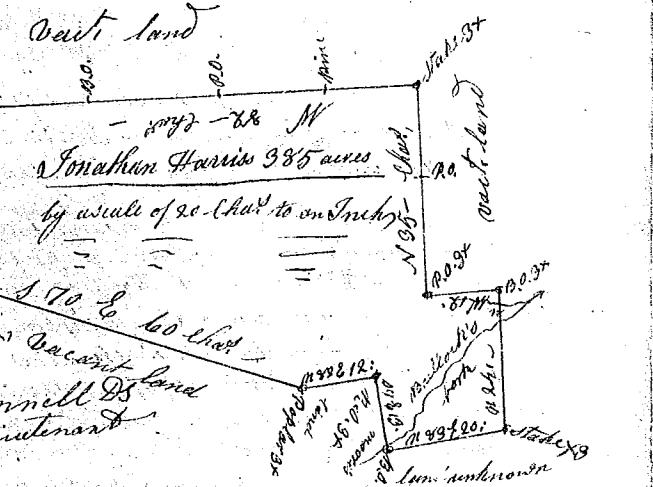

State of S^c Carolina Pursuant to a warrant from John Thomas Commissioner in 96 District N^e side Saluda I have admeasured and laid out unto Edward Misgrove a tract of seventy five acres of land on the S^e side of Enoree River in Lawrence County bounding N^e on S^e Enoree River, SW & SE on Edward Garrett's land, SW on a county survey, NE on land laid out to Will Barry, and hath such shape and marks as the above plat represents

Survey^d the 10 day of May 1785. Recorded the 25th June 1785 Robt. Hanna D^o.



Pursuant to a warrant from John Thomas Commissioner of Locations I have admeasured and laid out unto John Proud a tract of sixty acres of land situate in Lawrence County, ninety six district below the Indian Boundary on the south side of Enoree River, bounded N^e on said River, and bounded on all sides on vacant land laid out, and hath such shape and marks as the above Plat represents

Survey^d the 13th June 1785, J^o McClure D^o, Recorder 25th June 1785

