

State of S<sup>c</sup> Carolina 96 district W. side the old boundary line  
 Pursuant to a warrant from John Thomas Commissioner  
 of locations dated 24 May 1785, I have admeasured  
 and laid out unto John Thomas Esq. a tract of land of one  
 hundred and forty acres, situate in the forks, between  
 Broad & Saluda Rivers, on the south side of the 5<sup>th</sup> forke  
 of Tugger River, bounded N.E. by said river, S.W. by said  
 John Thomas's land, as A. Ann Roberts's land, all other sides  
 Vacant land, and hath such shape and Marks as the above  
 Plat represents, Survey'd the 26<sup>th</sup> May 1785,  
 Recorded 2<sup>d</sup> June 1785, Andrew Thomson Esq.

115

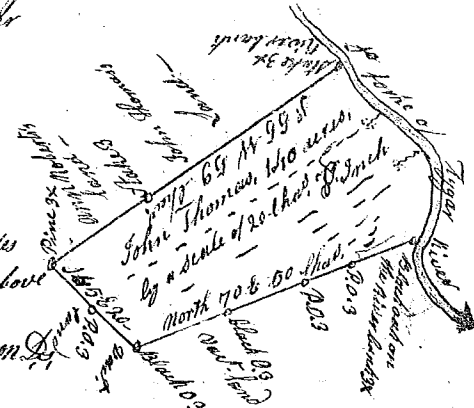

State of S<sup>c</sup> Carolina 96 district W. side of the old boundary,  
 Pursuant to a warrant from John Thomas Commissioner  
 of locations dated 24 May 1785, I have admeasured and  
 laid out unto Isaac Reed a tract of Two hundred acres of  
 land, on the north side of Reedy River & head branches of Rocky  
 Creek, bounded N.E. by Daniel Rogers's land, all other sides  
 Vacant land, and hath such shape and Marks as the above  
 Plat represents, Survey'd 24 May 1785,  
 Recorded 2<sup>d</sup> June 1785, Andrew Thomson Esq.

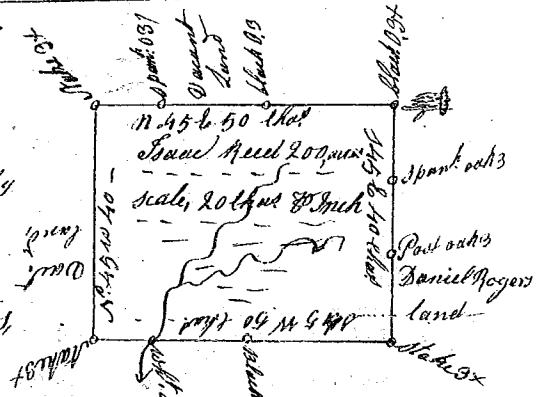

State of S<sup>c</sup> Carolina 96 district west of the old line,  
 Pursuant to a warrant from John Thomas Commissioner of locations  
 dated 16 Sept<sup>r</sup> 1784, I have admeasured and laid out unto John  
 Justice a tract of Two hundred acres of land on the County  
 as a soldier in an Independent Company, between the N<sup>o</sup> &  
 Middle fork forke of Tugger River, bounded S.E. by William  
 Barton's land, all other sides Vacant land, and hath  
 such shape and Marks as the above Plat represents,  
 Survey'd 5 Nov<sup>r</sup> 1784,  
 Andrew Thomson Esq.

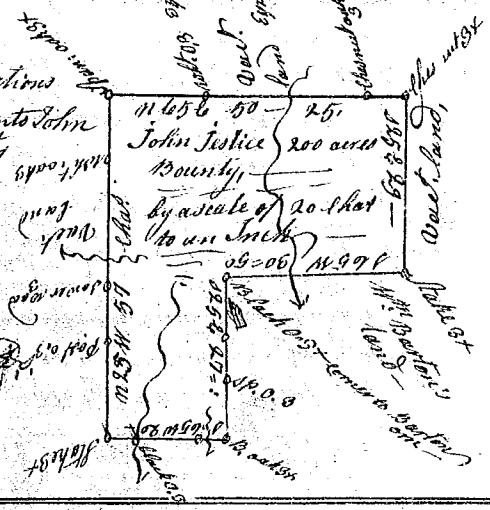

State of S<sup>c</sup> Carolina 96 dist<sup>t</sup> W. old boundary line  
 Pursuant to a warrant from John Thomas Com-  
 missioner of locations dated 22 May 1785, I have  
 admeasured and laid out unto James M. Elhenny  
 a tract of one hundred acres of land, on the North side  
 of the North fork of Saluda River, bounded E. by  
 Jeremiah Kephel's land, westerly by said J. M. Elhenny's  
 land, all other sides Vacant land, and hath such  
 shape and Marks as the above Plat represents,  
 Recorded 2<sup>d</sup> June 1785, Andrew Thomson Esq.

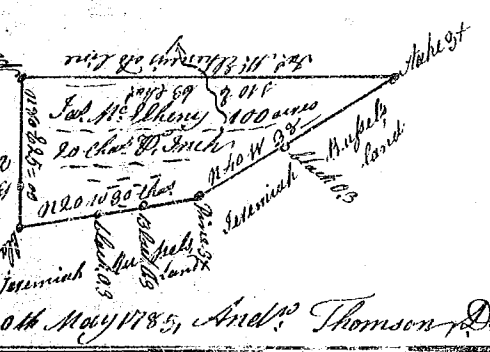

State of South Carolina: Pursuant to a warrant from John Thomas Esq.  
 Commissioner of locations in 96 District N<sup>o</sup> side Saluda River, I have  
 admeasured & laid out unto William Cunningham a tract of one  
 hundred & thirteen acres of land, on a branch of Crooked Creek call'd  
 Samuels's fork, bounded S<sup>o</sup> and N<sup>o</sup> on land the owner unknown & Rob<sup>t</sup>  
 Cunninghams land S<sup>o</sup> of & behind on some youngs & vacant lands, and round  
 hath such shape & marks as the annex'd Plat represents

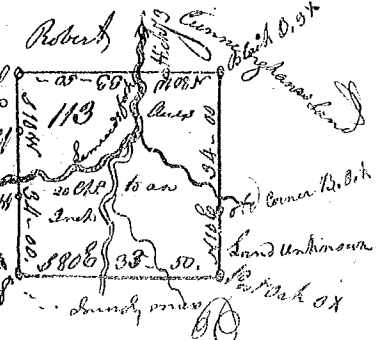

Survey'd the 25<sup>th</sup> April 1785 by Robert Hanna Esq.  
 Recorded the 6<sup>th</sup> June 1785 at Delmar to J<sup>r</sup> Geer