

State of South Carolina 9th District West of old boundary line
 Pursuant to a warrant from John Thomas Commissioner of locations dated the 5th May 1785, I have admeasured and laid out unto James Forester a tract of Two hundred and sixty nine acres of land, on both sides of the meadow fork of musk creek, a branch of Sugar River bounded S.E. by land laid out by order of Bayles Earle, the owner unknown, and hath such shape and Marks as the above Plat represents,
 Surveyed 5th May 1785 Andrew Thomson, D.S.
 Recorded 4th day June 1785

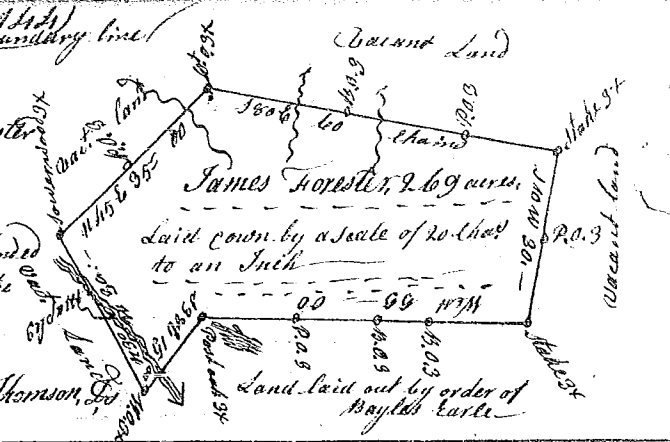

South Carolina, District
 Pursuant to a warrant from John Thomas Commissioner of locations to me dated 17th May instant, I have laid out a tract of land unto William Strother containing six hundred and forty acres, situate on Broad River, binding N.E. on land laid out unto Churles Sims, S.W. on Pinkneys and James Thomas's lands, S. on lands laid out unto Howelin Threewits, and has such shape Marks and form as the above Plat represents, Surveyed 27th May 1785,
 Recorded 4th day June 1785, by James Winn D.S.

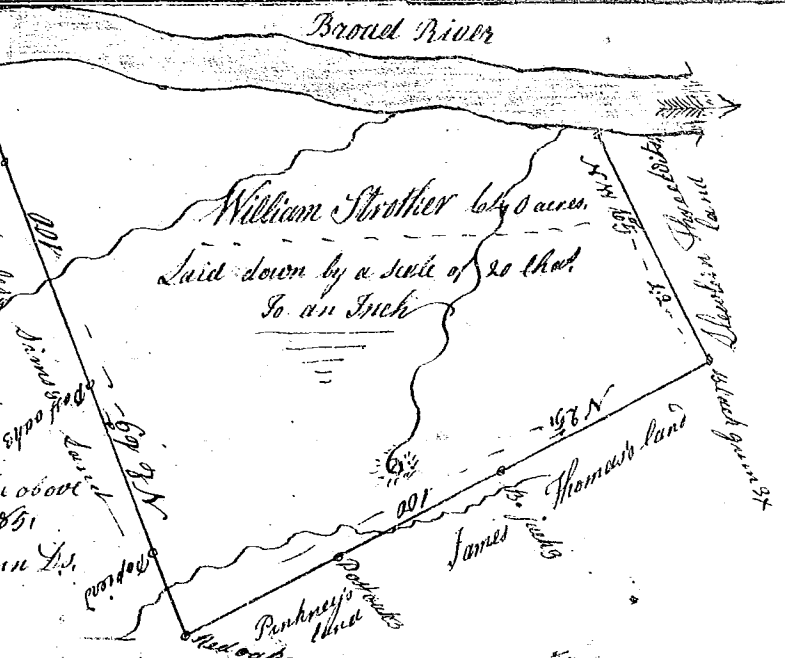

State of South Carolina 9th District West of old line.
 Pursuant from John Thomas Commissioner of locations dated 10th May 1785, I have admeasured and laid out unto Mary Vernon a tract of one hundred and two acres, lying on the south fork of the Three forks of Sugar River, bounded S.W. by William D. Thomas's land, all other sides by Vacant land, and hath such shape and Marks as the above Plat represents, Surveyed 10th May 1785,
 Recorded 2d June 1785, by Andrew Thomson D.S.

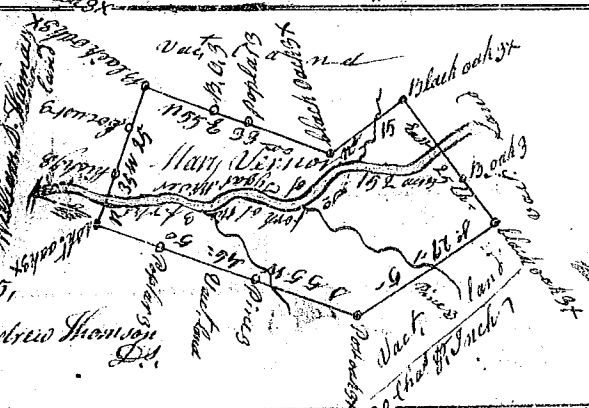

State of South Carolina, 9th District East side of the old boundary line
 Pursuant to a warrant from John Thomas Commissioner of locations for the north side of Saluda River dated 25th Febry 1785, I have admeasured and laid out unto David Paden a tract of one hundred and forty four acres of land lying on the north side of the north fork of Sugar River, on both sides of mill creek, bounded N. by John Pottens's land, E. & S. by Nathaniel Miller's land, west by John Nicolls's land, and hath such shape and Marks as the above Plat represents,
 Surveyed 8th April 1785
 Recorded 2d June 1785, by Andrew Thomson D.S.

