

South Carolina, Pursuant to a warrant from John Thomas Commissioner of locations for 96<sup>th</sup> district N. Side Saluda River, I have admeasured and laid out unto James Southern a tract of land containing two hundred and three acres, situate in the district of ninety six on the waters of the golden grove creek and reedy river, and hath such form and marks, butings and boundings as the above plat represents. Surveyed 4<sup>th</sup> April 1785, Recorded the 3<sup>rd</sup> May 1785. Lewis D.

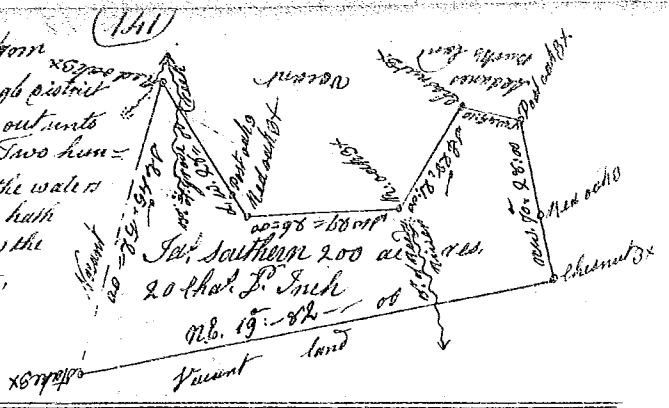

State of South Carolina, Pursuant to a warrant from John Thomas Com: of locations for 96<sup>th</sup> district N. Side Saluda dated 30 March 1785, I have admeasured and laid out unto Meredith Blackburn a tract of land containing two hundred and eighty five acres situate in the district of 96 on the golden grove creek, branches of saluda river, and hath form and marks, butings and boundings as the above Plat represents. Surveyed 2<sup>nd</sup> April 1785, Recorded 3<sup>rd</sup> May 1785. Lewis D.

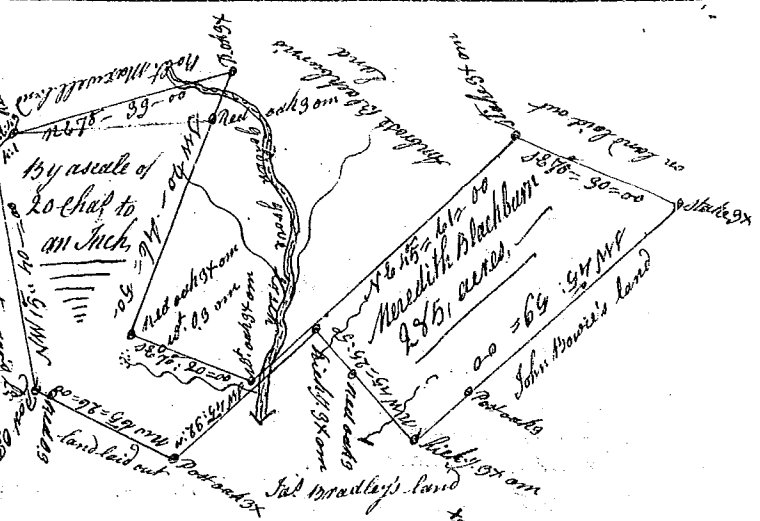

South Carolina Pursuant to a warrant from John Thomas Commissioner of locations for ninety six district N. Side Saluda River dated 30 March 1785, I have admeasured and laid out unto Meredith Blackburn a tract of land containing one hundred and eighty four acres situate in said district N. Side Saluda River, and hath form and marks, butings & boundings as the above Plat represents. Surveyed 2<sup>nd</sup> April 1785, Recorded 3<sup>rd</sup> May 1785, Lewis D.

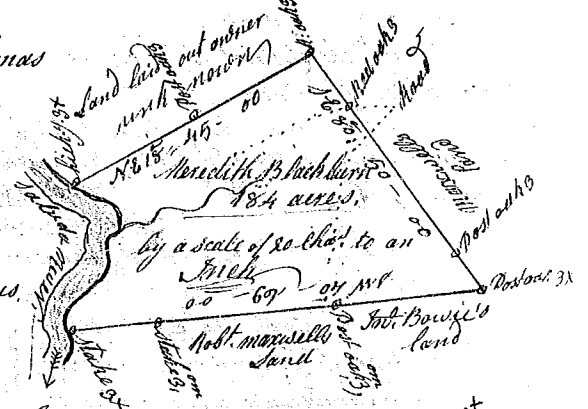

South Carolina Pursuant to a warrant from John Thomas Commissioner of locations for ninety six district N. Side Saluda River dated 30 March 1785, I have admeasured and laid out unto Meredith Blackburn a tract of land containing one hundred & ten acres in said district, on the N. Side Saluda River bounding SW by said river, all other sides Vacant land and hath such form and marks as the above Plat represents. Surveyed 4<sup>th</sup> April 1785, Recorded the 3<sup>rd</sup> May 1785, Lewis D.

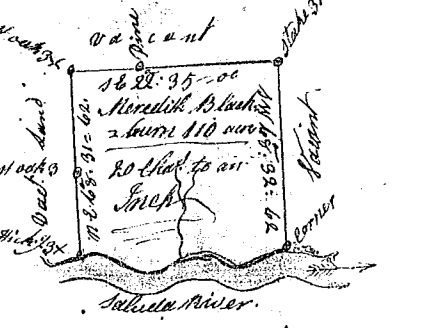

South Carolina Pursuant to a warrant from John Thomas Commissioner of locations for ninety six district N. Side Saluda River, I have admeasured and laid out unto Joseph Meglocklin a tract of land containing sixty acres, situate in the district of ninety six on Prince's Creek Branch of Enoree River, and hath such form and marks, butings and boundings as the above Plat represents. Surveyed 6<sup>th</sup> April 1785, Recorded the 3<sup>rd</sup> May 1785, Lewis D.

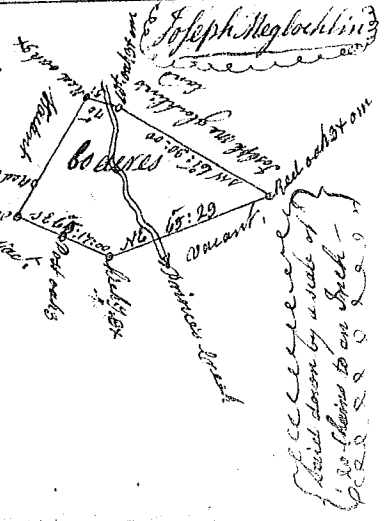

Handwritten note: 'Laid down by a scale of 20 chad to an inch'.