

State of S^c Carolina
 Pursuant to a warrant from John Thomas Esq^r Commissioner of Locations dated the 2^d day of April 1785 I have admitted and laid out unto John Turnbough a tract of three hundred and seventy three acres in Ninety six district west of the old boundary line, on Enoree River, bounding on all sides on Vacant Land, and hath such shape and Marks as the above Plat Represents
 Recorded 20th May 1785,
 Survey 15th April 1785, by W^m Benson De

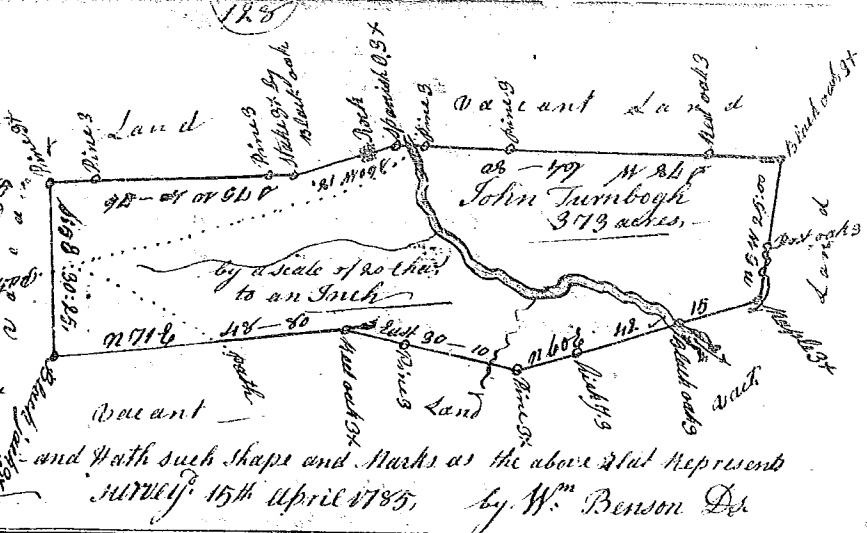

State of S^c Carolina,
 Pursuant to a warrant from John Thomas Esq^r Commissioner of Locations dated 14 April 1785, I have admitted and laid out unto John Anderson a tract of four hundred & forty four acres of land, in Ninety six district west of the ancient Boundary or the meadow dam of Enoree River, bounding N^e on land laid out to Samuel Earle, N^e or to John Parsons, all other sides on Vacant Land, and hath such shape and Marks as the above Plat Represents, Survey 15 April 1785
 W^m Benson De.
 Recorded the 20th May 1785.

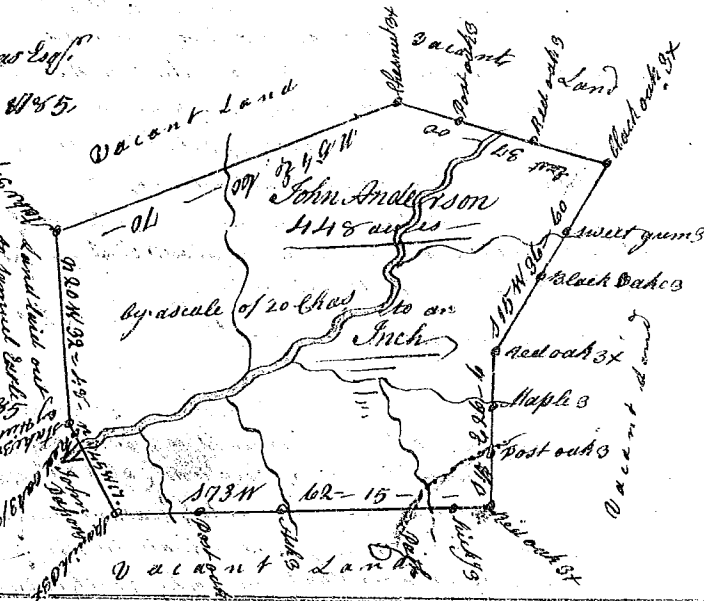

State of South Carolina 96 Dist.
 Pursuant to a warrant from John Thomas Commissioner of Locations for the District N^e of Saluda River, I have surveyed and laid out unto Hugh Moore a tract of land containing 340 acres situate above the ancient Boundary line on both sides of Enoree River bounded S^wardly by Peggy Lewis's land E^wardly by Robert Princes land N^ewardly by said Princes Land, NW wardly by said Princes and Tubs Land, and Westwardly by Tubs Land and has such shape & Marks as the above Plat Represents
 Survey 4th May 1785 James Hubert De.
 Recorded 20th May 1785.

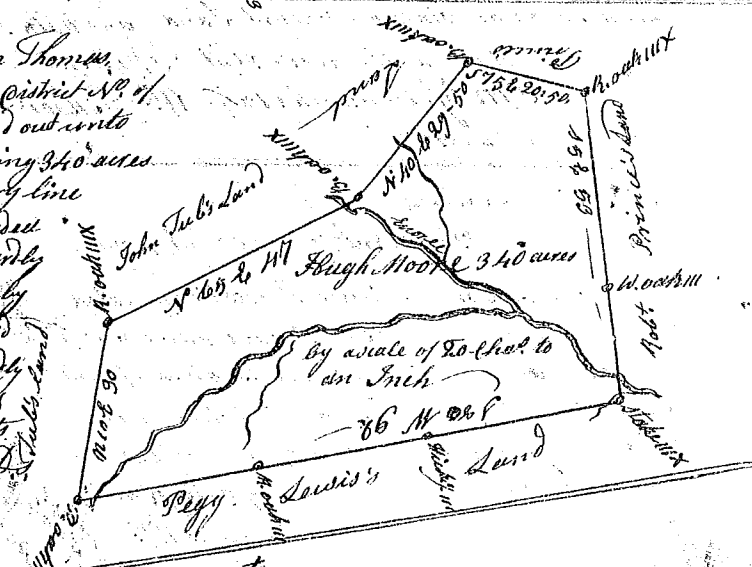

State of S^c Carolina 96 Dist.
 Pursuant to a warrant from John Thomas Esq^r Commissioner of Locations for the Dist^{ct} N^e of Saluda River, I have surveyed and laid out unto William French a tract of 270 acres of land, above the ancient boundary line on Moores branch of Enoree, including Moores Improvement N^e of a ridge of mountains, bounded on all sides by Vacant Land, and has such shape and Marks as the above Plat Represents.
 Survey 14 April 1785 J^o Sealborn De.
 Recorded 20 May 1785.

