

State of South Carolina / Pursuant to a warrant from John Thomas Commissioner of Locations dated 22 day of April 1785, I have admeasured and laid out unto James Tubbs a tract of land containing Two Hundred acres, in ninety six district west of the ancient Boundary, on Canals branch of Chickaroe River bounding NW on land laid out to Tho^s Council, all other sides on Vacant Land, and hath such shape and Marks as the above Represents.

Survey, the 2^d May 1785. W^m Benson D^s.

Recorded 19th May 1785,

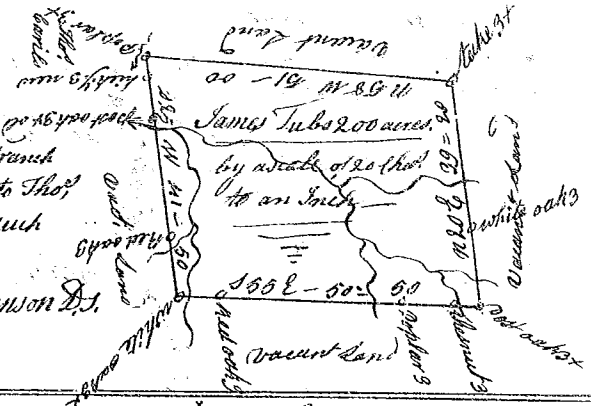

State of South Carolina / Pursuant to a warrant from John Thomas Commissioner of Locations dated the 10th day of febr^y 1785, I have admeasured and laid out unto Joseph Logan a tract of Land of Two hundred and six acres, situate in ninety six district west of the ancient Boundary on the Branches of Hoopers Creek and branches of Spuntans Creek of Saluda River, Bounding N.E. & NW on Land laid out to Joseph Bridges, all other sides on Vacant Land, and hath such shape and Marks as the above plat Represents, Survey, 10th April 1785

Recorded 19th May 1785,

W^m Benson D^s.

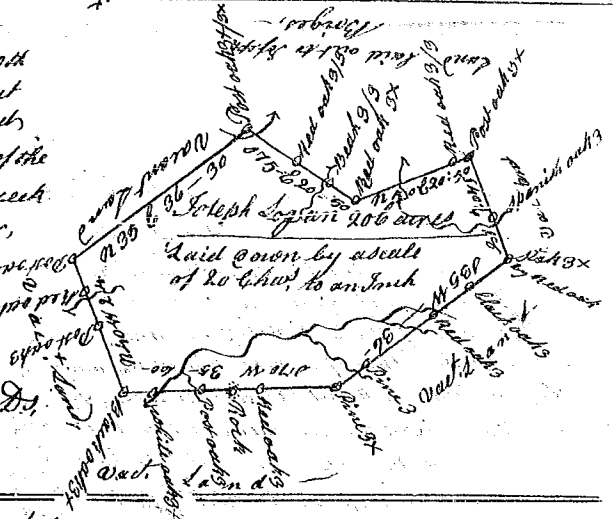

State of South Carolina / Pursuant to a warrant from John Thomas Commissioner of Locations dated 15th March 1785, I have admeasured and laid out unto Pleasant Hudson a tract of one Hundred acres of land, situate in ninety six district west of the ancient Boundary on Rocky Creek of Enoree River Bounding on all sides on Vacant Land, and hath such shape and Mark as the above plat Represents.

Survey, 2^d March 1785 W^m Benson D^s.

Recorded 19th May 1785,

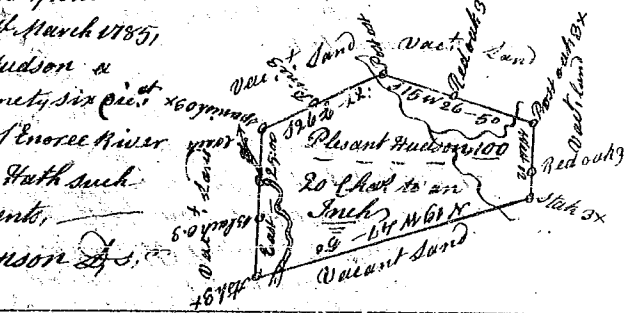

State of South Carolina,

Pursuant to a warrant from

John Thomas Commissioner of Locations, dated the 17th day of March 1785, I have admeasured and laid out unto Hugh Lewis a tract of Land containing Two hundred and thirteen acres in ninety six district, West of the ancient Boundary, on Clayton's branch of Muddy River Bounding N.E. & S.E. on land laid out to W^m Young, S.E. to Ann Esley's S.W. to Frances Clayton, all other sides on Vacant Land, and hath such shape and Marks as the above plat Represents.

Survey, 17 April 1785. W^m Benson D^s.

Recorded 10th May 1785,

