

State of South Carolina 9th District East of the old Boundary
 Pursuant to a warrant from John Thomas Esq^r Commissioner
 of Locations dated 27th Feb^r 1785, I have
 admeasured and laid out unto William Ray tract
 of Land containing Two hundred acres, lying on
 both sides of Durbin Creek a branch of Enore River
 Bound N^o by Thomas Jones's Land, S^o by Patrick Cun-
 ingsham's Land, all other sides Vacant Land, and
 hath such shape and Marks as the above Plat represents
 Survey^d the 17th March 1785,
 Recorded 13th May 1785, by Andrew Thomson D^s.

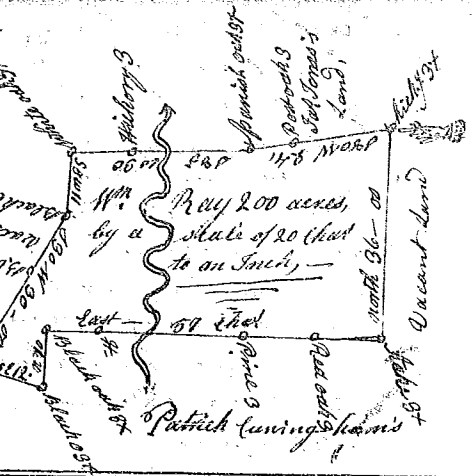

State of S^o Carolina 9th District West of the old Boundary line
 Pursuant to a warrant from John Thomas Esq^r Commissioner
 of Locations dated 5th March 1785, I have admeasured and
 laid out unto John Beales, a tract of Land containing Two
 Hundred acres, lying on both sides of Enore River, bounded
 on all sides by Vacant Land, and hath such shape and
 Marks as the above Plat represents,
 Survey^d the 17th March 1785,
 Recorded 14th May 1785, by Andrew Thomson D^s.

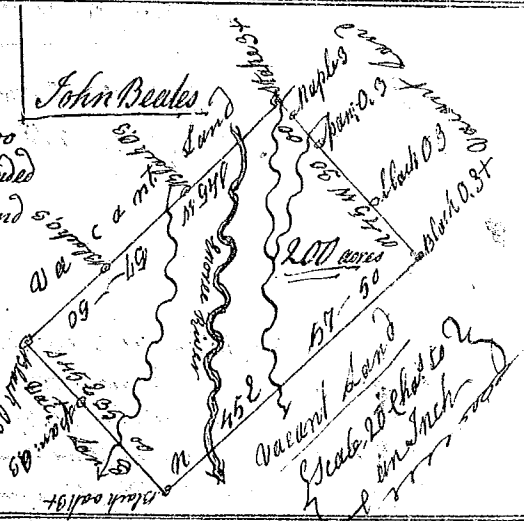

State of S^o Carolina 9th District East of the old Boundary line,
 Pursuant to a warrant from John Thomas Commissioner
 of Locations dated the 17th March 1785, I have admeasured and
 laid out unto John Wheelchel, a tract of Land containing
 Two hundred acres, lying on both sides of London Bridge
 Creek a branch of broad River, including the said John
 Wheelchel's Improvement, bounded on all sides by Vacant Land,
 and hath such shape and Marks as the above plat represents,
 Survey^d the 16th March 1785 Andrew Thomson D^s.
 Recorded the 14th May 1785,

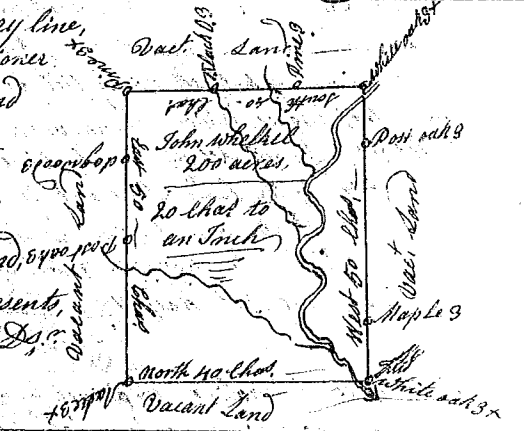

State of S^o Carolina 9th District East of the old Boundary line,
 Pursuant to a warrant from John Thomas Esq^r
 Commissioner of Locations dated the 24th March 1785,
 I have admeasured and laid out unto James Boardman
 a tract of Land containing one Hundred and ninety
 Two acres, on a branch call Harris's Creek a branch
 of fair forest, bounded S^W. by George Storey's Land N^W.
 by Rich^d. Couss's Land E^{ast} by Samuel Simpsons Land
 and hath such shape and Marks as the above Plat represents,
 Survey^d the 10th May 1785, Andrew Thomson D^s.
 Recorded the 14th May 1785,

