

State of S^c Carolina - Ninety Six District (AM)
 East of the Ancient Boundary Line
 Pursuant to a warrant from John Thomas Esq^r
 Comm^r of Locations bearing Date the 18th March
 1785. I have admeasured & laid out unto
 William Clayton a Tract of Land containing 494 acres
 four Hundred & Ninety seven Acres lying
 on the small branches of Two Mile Creek waters
 of Enoree River, bounding to the S.E. on Corn
 Crows Land West by Hendricks Land, & hath
 such shape marks & Boundaries as the
 annexed Plat Represents

Survey^d this 10th day of April 1785
 Andrew Thomson D^y
 Recorded the 13th day of May 1785

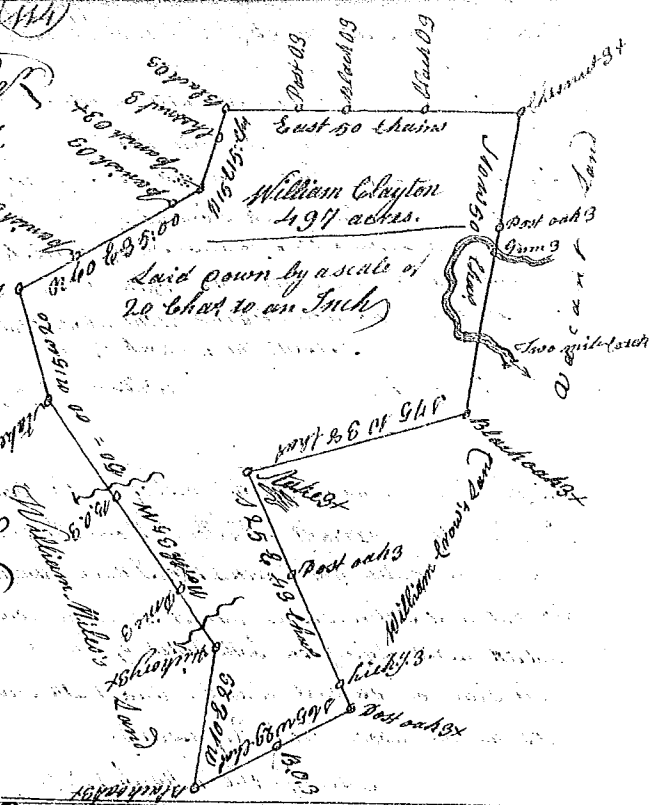

State of S^c Carolina 96 District East of the old
 Boundary line, Pursuant to a warrant
 from John Thomas Commissioner of Locations
 dated 21 day of Oct^r 1784, I have admeasured
 and laid out unto David Qualls a tract
 of Land containing Three hundred and thirty
 Three acres, lying on the N side of Enoree
 River, on a branch called Rocky field creek
 a branch of Enoree River, bounded SW by Benjamin
 Kilgore's Land N by an old Line the owners was
 unknown & by lands laid out to William Willson, and
 hath such shape and Marks as the above Plat Represents

Survey^d the 19th February 1785
 Recorded the 13th May 1785 by Andrew Thomson D^y

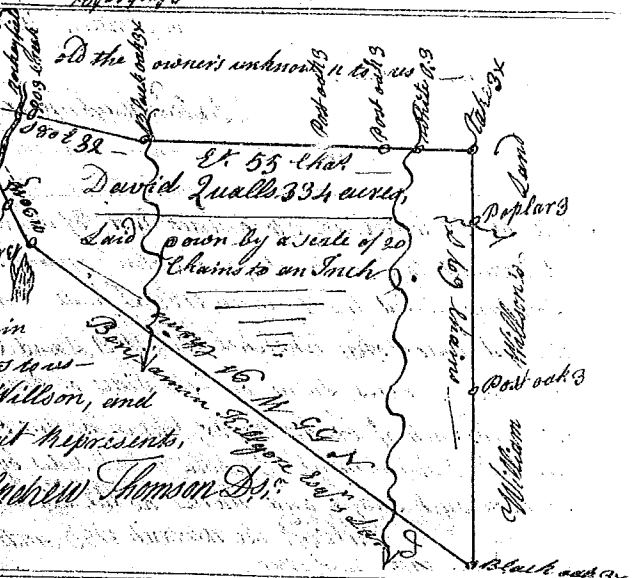

State of South Carolina, 96 District E^t of the old boundary
 Pursuant to a warrant from John Thomas Esq^r
 Commissioner of Locations dated 13th Feby 1785 I have
 admeasured and Laid out unto William Willson
 a tract of Land of 252 acres on the south side
 of Enoree River on Abner's Creek, bounded to the
 W by David Qualls Land S.E. by John Redman
 Land, all other side Vacant Land and hath
 such shape and Marks as the above Plat Represents

Survey^d the 11th April 1785
 Recorded the 13th May 1785 by Andrew Thomson D^y

