

State of South Carolina Pursuant 100

To a warrant from John Thomas Esq. Com. Locations in 96 District N. Saluda River Dated the 25th March 1785 I have admeasured and laid out unto John Hall a Tract Containing one Hundred & Ninety Acres of Land, below the Ancient Boundary line Situate in 96 District on Needy River & Bounding S. on S. River N.W. on Arthur Durham East on Sam. & Wiggins Lands & all other sides on vacant lands & hath such form & marks as the annexed plat Represents

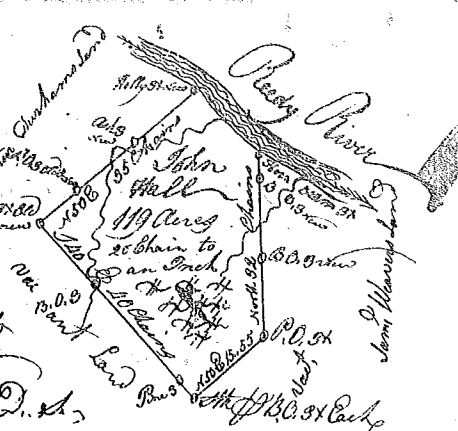

Recorded the 11th May 1785

John Bowce D. S.

State of South Carolina

Pursuant to a warrant from John Thomas Esq. Commissioner of Locations in Ninety six District N. Saluda River Dated the 29th day of March 1785 I have admeasured & laid out unto John Hall a Tract Containing 100 Acres of Land Below the Ancient Boundary line Situate in 96 District on the N. side of Saluda river Bounding S. S.W. & S.E. by S. River all other sides vacant land & hath such shape & marks as the above plat Represents. Survey, 12th April 1785

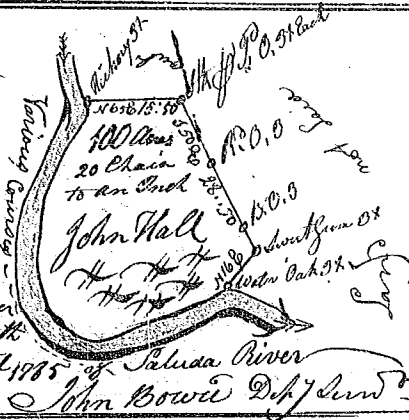

Recorded the 11th May 1785

John Bowce D. S.

State of South Carolina

Pursuant to a warrant from John Thomas Esq. Commissioner of Locations dated the 1st day of Jan'y 1785 I have admeasured and laid out unto William Young a tract of land containing four hundred and thirty nine acres, situate in Ninety six District, west of the ancient Boundary, on Saluda River, Bounding N.W. & S.W. on land laid out to James Clayton N.W. on land unknown, N.E. to Sam. Clayton and Swardly by said River, on all other sides on vacant Land, and hath such shape and marks as the above plat Represents.



Recorded the 11th May 1785

by W. Benson D. S.

State of South Carolina

Pursuant to a warrant from John Thomas Esq. Commissioner of Locations for Ninety six District N. Saluda River, dated the 5th Jan'y 1785, I have measured and laid out unto James Mayson Esq. a tract of fifty acres of land, situate in Ninety six District on the North side of Saluda River, Bounding S.W. on said River East on Samuel Proctor's Land, N.E. and N.W. on Col. Esleigh's Land, and hath such shape and marks as the above plat Represents

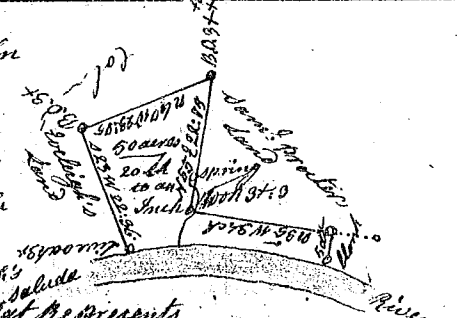

Recorded 11th May 1785

Survey, 3rd March 1785 by Harwood Jones D. S.

State of S. Carolina

Pursuant to a warrant from John Thomas Esq. Com. of Locations Dated the 28th Jan'y 1785. I have admeasured & laid out unto Solomon Kemp a Tract of Ninety five acres of Land Situate in Ninety six District West of the Ancient Boundary on Enae River, Bounding S.W. on land laid out to Henry Benson N.W. to Malcolm Carnegy on all other sides on Vacant Land, & hath such shape & marks as the Annexed plat Represents. Survey, this 11th day of Feb'y 1785

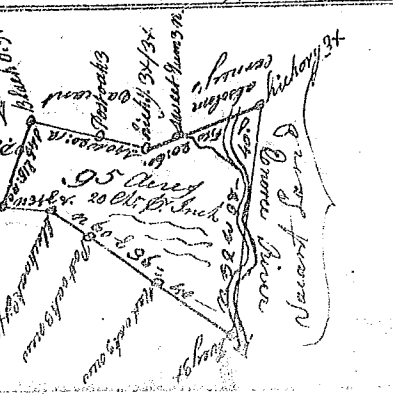

Recorded the 12th of May 1785

W. Benson D. S.