

State of S<sup>c</sup> Carolina 9<sup>th</sup> District East of the old boundary line

Pursuant to a warrant from John Thomas Esq<sup>r</sup> Commissioner of Locations dated the 11<sup>th</sup> of Dec<sup>r</sup> 1784. I have admeasured and laid out unto William Fowler a Tract of Land containing Three Hundred acres lying on the S<sup>c</sup> side of Snow Creek & on both sides of Snow Creek bounded to the South by land laid out for James Curry W<sup>y</sup> by land laid out for James Moore N<sup>o</sup> 28<sup>th</sup> by Holloway Rivers land & hath such shape & marks as the above plat represents. Survey this 10<sup>th</sup> Jan<sup>y</sup> 1785  
Recorded the 18<sup>th</sup> April 1785  
By Andrew Thomson Esq<sup>r</sup> Deliv<sup>d</sup> to W<sup>m</sup> Fowler

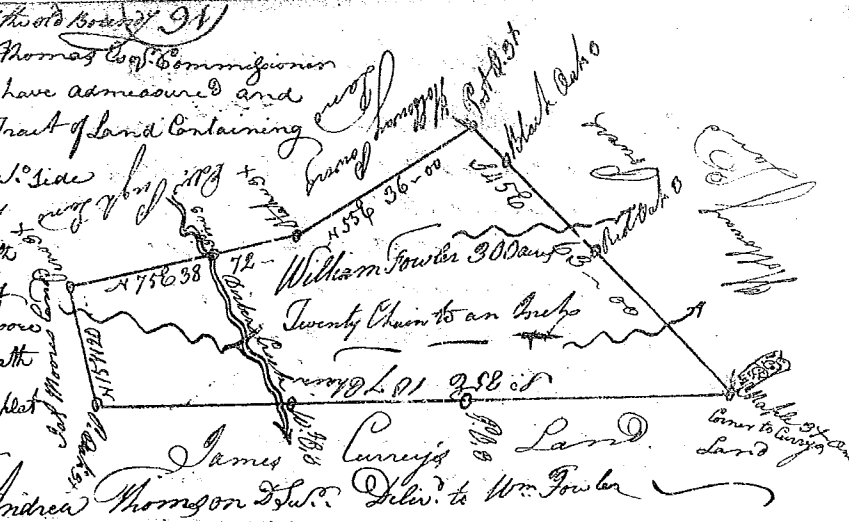

State of South Carolina 9<sup>th</sup> District  
Pursuant to a warrant from John Thomas Esq<sup>r</sup> Commissioner of Locations for the district of the S<sup>c</sup> side of Saluda River, I have surveyed and laid out unto Thomas James a tract of Land containing Two hundred and seventy acres situate below the ancient boundary line, on both sides of Shoey Creek of Laurin's Fork, bounded N<sup>o</sup> by John Bellinger's land S<sup>o</sup> by Thomas James's land W<sup>o</sup> by Lewis Turner's land & John Conner's land, on all other sides by Vacant Land, and has such shape and marks as the above Plat represents.  
Survey: the 22<sup>nd</sup> of March 1785  
by James Seaborn D<sup>s</sup>  
Recorded: 19<sup>th</sup> April 1785

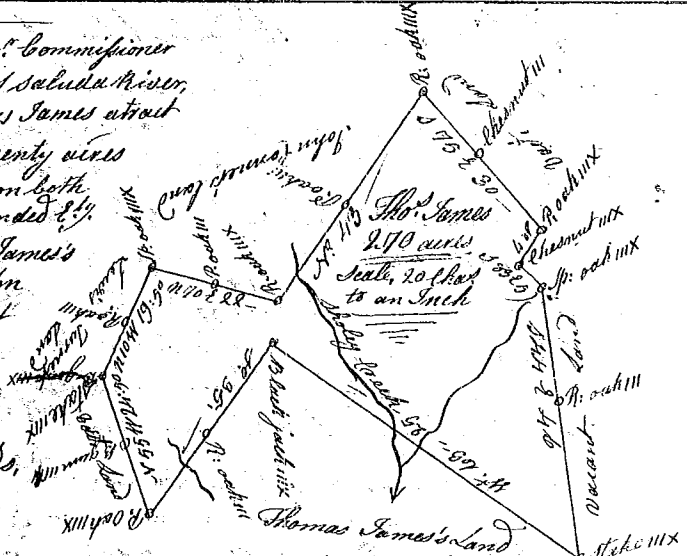

State of S<sup>c</sup> Carolina 9<sup>th</sup> Dist. East of the ancient boundary line  
Pursuant to a warrant from John Thomas Commissioner of Locations dated the 2<sup>nd</sup> day of Dec<sup>r</sup> 1784, I have admeasured & laid out unto Hugh Holland a Tract of Land containing Three Hundred & thirty two Acres situate lying & being on Buffalo Creek a branch of Sawford's, bounded to the South by Richard Rowntree's land to the East by Little's land all other sides Old lines & hath such shape & marks as the Annexed Plat represents  
Survey: this first day of Jan<sup>y</sup> 1785  
By Andrew Thomson Esq<sup>r</sup>  
Recorded the 19<sup>th</sup> April 1785



State of South Carolina Pursuant to a Warrant from John Thomas Esq<sup>r</sup> Com<sup>r</sup> of Locations in Ninety two District N<sup>o</sup> Side Saluda River; I have admeasured & laid out unto William Griffin a Tract of Ninety two Acres of Land on a branch of Cassons Creek of Little River below the Indian Boundary, bounded S<sup>o</sup> W<sup>o</sup> on Smith's land S<sup>o</sup> & N<sup>o</sup> on James Waldrop's land N<sup>o</sup> W<sup>o</sup> on W<sup>m</sup> Welch's land & hath such shape & marks as the Annexed Plat represents  
Survey: this 4<sup>th</sup> day March 1785  
Recorded the 19<sup>th</sup> April 1785  
Deliv<sup>d</sup> to John Army

