

State of South Carolina 78

Pursuant to a Warrant from John Thomas Esq. Comr. Location in 96 District N. Saluda River Dated the 20th of Feb. 1785. I have admeasured & Laid out unto John Hall's Trust Containing Two Hundred Acres of Land, Situate in 96 District Below the Ancient Boundary, on Walnut Creek a branch of Saluda River, Bounding W by Moore Land & on S by Vacant Land All Other sides Vacant & hath such Shape & marks as the annexed Plat Represents Survey'd this 16th March 1785 by Wm Bowie Esq. Recorded the 24th March 1785. Ditto to John Hall

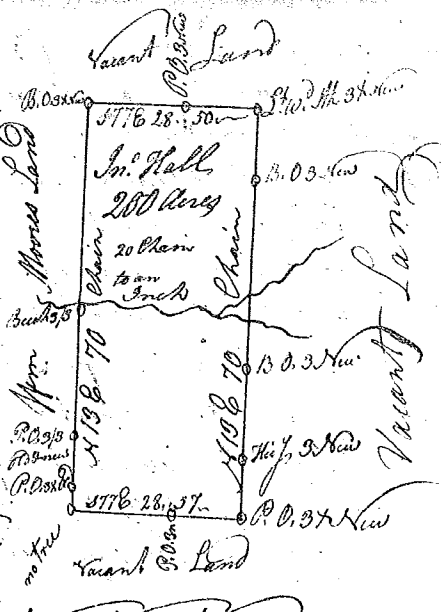

State of S^c Carolina

Pursuant to a warrant from John Thomas Esq. Commissioner of Locations in Ninety six District N. Saluda River, Dated 22. Nov. 1784, I have admeasured and laid out unto Josiah Duckett's tract of Land containing one hundred and sixty five acres on the south side of Enoree River below the Indian Boundary in said District bounded NW and SW by said River SE on land laid out the owners unknown, and N by Vacant Land and hath such Shape and Marks as the above Plat Represents recorded 25th March 1785. Survey'd 29 Jan. 1785 Robt Hanna Esq.

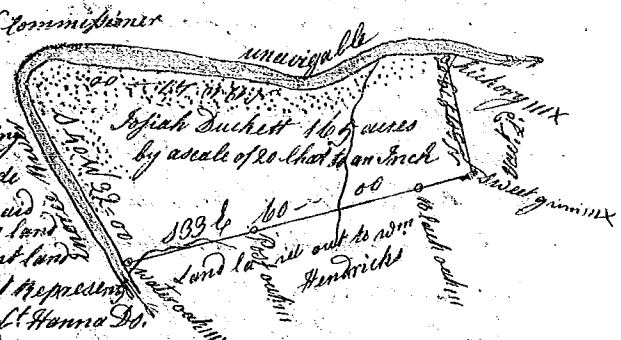

State of S^c Carolina

Pursuant to a Warrant John Thomas Esq. Commissioner of Locations dated the 31 day of December 1784. I have Admeasured and laid out unto Gabriel Benson a Tract of Three Hundred Acres of Land Situate in Ninety six District East of the Ancient Boundary, on the Head Branch of Fair Forest Creek and on the Branches of the North Fork of the North fork of Tyger River, Bounding to the SW & NW on land granted to John Pines SE & NW on land on known and on all other sides on Vacant Land and hath such Shape and Marks as the above Plat Represents Survey'd this 10 day of January 1785 Wm Benson, Esq.

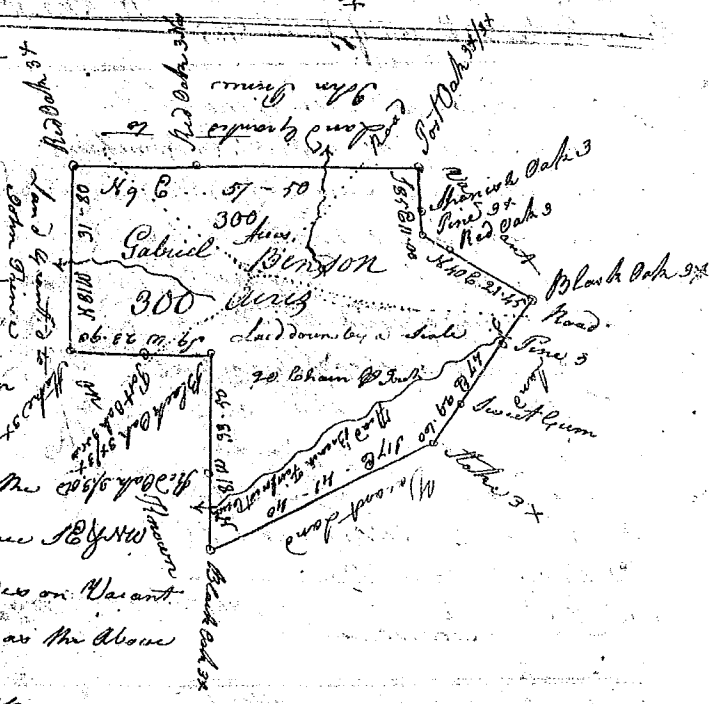

Recorded the 29th March 1785