

State of South Carolina Pursuant to a (11)

Warrant from John Thomas Esq. Commissioner of Locations dated the 3<sup>rd</sup> day of Feb<sup>r</sup> 1785. I have admeasured & laid out unto Marson Cox Smithson a Tract of land in the District of 96, containing Two hundred & thirty seven acres East of the ancient Boundary on the N Fork of Tyger River bounding to the NW on land laid out to Wm. Mather N E & S E on land unknown S E to John Smithson and by the the various courses of the R. River, and hath such shape and marks as the annexed plat represents  
 Recorded 18<sup>th</sup> March 1785 Survey: this 12<sup>th</sup> Feb<sup>r</sup> 1785 Wm Benson Surveyor

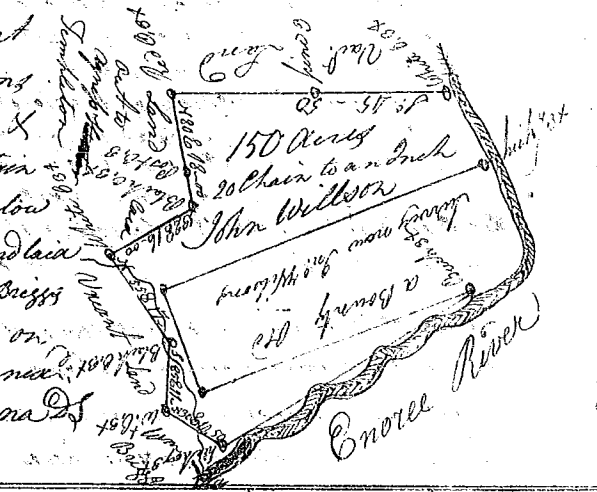

State of South Carolina Pursuant to a warrant from John Thomas Esq. Commissioner of Locations in 96 District N. Saluda River, I have admeasured & laid out unto John Willson a Tract of land containing one hundred & fifty acres on Enoree River below the Indian Boundary, bounding N E & S E part on land laid out to Agnes Tomplaton & part on land laid out to M<sup>r</sup> Briggs & S E & NW on an old County Survey & all other sides on vacant land & hath such shape & marks as the annexed plat represents, Survey: this 6<sup>th</sup> Jan<sup>y</sup> 1785, Robert Hanna Surveyor  
 Recorded the 18<sup>th</sup> March 1785



State of S. Carolina Pursuant to a warrant from John Thomas Esq. Com<sup>r</sup> Locations in 96 District N. Saluda I have admeasured & laid out unto John George a Tract of land containing 21 acres on Enoree River below the Indian Boundary, bounding SW on Sm. Georges NE on land laid out to Edw. Garrett & hath such shape & marks as the annexed plat represents, Survey: this 16<sup>th</sup> Jan<sup>y</sup> 1785 Robert Hanna Surveyor  
 Recorded the 18<sup>th</sup> March 1785



State of S. Carolina Pursuant to a warrant from John Thomas Esq. Commissioner of Locations in 96 District N. Saluda I have admeasured & laid out unto John George a Tract of land containing twenty five acres, on Enoree River below the Indian Boundary, bounding NE on land claimed by John George all other sides vacant, & hath such shape & marks as the annexed plat represents, Survey: this 17<sup>th</sup> Jan<sup>y</sup> 1785 Robert Hanna Surveyor  
 Recorded the 18<sup>th</sup> March 1785

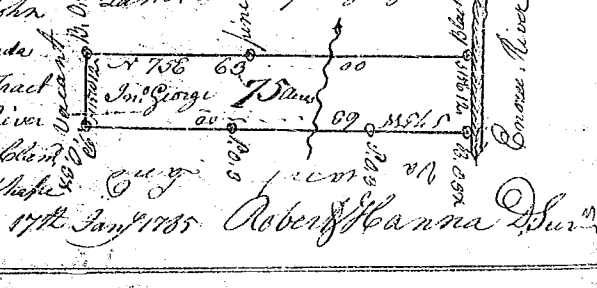

State of S. Carolina 96 District East of the ancient Boundary. Pursuant to a warrant from John Thomas Esq. Com<sup>r</sup> of Locations dated the 27<sup>th</sup> Jan<sup>y</sup> 1785 I have admeasured & laid out unto Richard James a Tract of land containing four hundred & forty acres situate lying & being on both sides of Ferguson's Creek waters of Tyger River, bounding to the N E by James Wofford land S E by Wm. Reeves land all other sides vacant & hath such shape & marks as the annexed plat represents, Survey: this 17<sup>th</sup> Feb<sup>r</sup> 1785

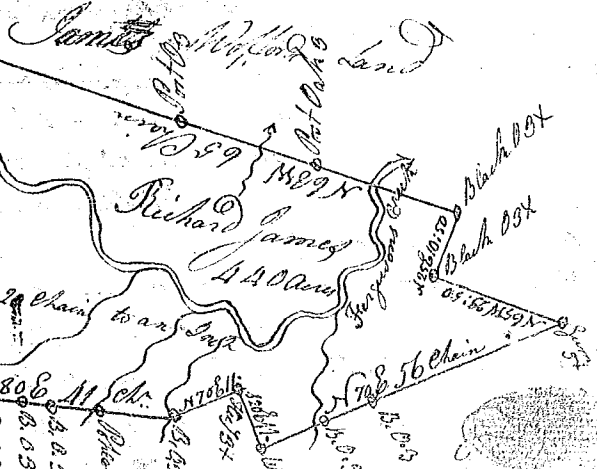

Recorded 18<sup>th</sup> March 1785 Andrew Thomson Surveyor