

State of S^c Carolina Pursuant to a warrant from John Thomas
 Commissioner of Locations dated the 28th Sept^r 1784, I have admeas-
 ured and laid out unto John Fields a tract containing 196 acres
 of Land, situate in Ninety six district on a branch of Abbeville Creek
 called Stunn's branch below the ancient boundary line, bounded
 N on Roger Murphy W on Shindzer Starns and land laid out
 E on land laid out E on land laid out, all other sides on
 vacant land, and hath such shape and Marks as the annexed
 Plat represents, Survey^d the 22nd Oct^r 1784, Johnⁿ Downs
 Esq.

Recorded the 5th March 1785

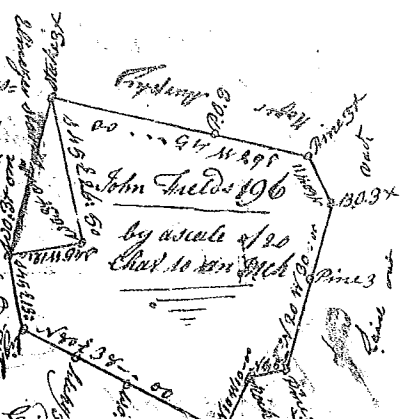

State of S^c Carolina Pursuant to a warrant from John
 Thomas Esq^r Commissioner of Locations dated 28th Sept^r 1784
 I have admeasured and laid out unto John Fields a tract
 containing 125 acres of Land, situate in Ninety six district
 on a branch of Abbeville Creek called Ritchey's branch below
 the ancient boundary line, bounded W on Samuel
 Scott and Patrick Cunningham's land E on Roger
 Murphy and John Sims's land, all other sides on lands
 laid out, and hath such shape and Marks as the
 above Plat represents

Survey^d the 21st of Oct^r 1784
 Recorded the 5th March 1785



State of S^c Carolina Pursuant to a warrant from
 John Thomas Esq^r Com^r Locations, I have admeasured &
 Laid out unto Peter Inlow a tract of two Hundred acres
 of Land, situate in Ninety six District, lying on the waters
 of Beaver Dam bounding N.E. by land laid out to John Stidom
 all other sides on vacant land (hath such shape & marks
 as the annexed Plat represents, Survey^d the 19th Nov^r 1785
 by D. Hopkins Esq

Recorded the 5th March 1785

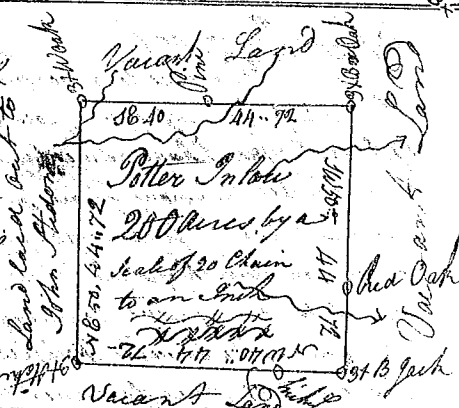

State of south Carolina,
 Pursuant to a warrant from John Thomas
 Esq^r Commissioner of Locations in Ninety six district
 North side Saluda river, I have admeasured and laid
 out unto Thomas Todd a tract of one Hundred acres
 of Land, on Tygar River below the ancient boundary
 bounding S.W. by S.W. on land belonging to the heirs
 of Ruben Young and Edward Ormick, N.E. on Pat Sample
 and all other sides on Thomas Todd's land
 and hath such shape and Marks as the above
 Plat represents, Survey^d the 27th Feb^r 1785,
 by Robert Hancock Esq

Recorded 7th March 1785, De^d. Edw^d. Hackett

