

State of North Carolina

Pursuant to a Warrant from John Thomas Esq. Commissioner of Locations dated the 8th day of October 1784 I have admeasured and laid out unto Elizabeth a Tract of Five Hundred Acres of Land Situate in Ninety Six District East West of the Ancient Boundary on the Branches of Monkey Creek & Conocer River bounding on all sides on Vacant Land and that such Shape and Mark as the Above Plat Represents

Surveyed this 9th day of October 1784
 Reversed the 23rd of February 1785 Wm Benson Esq

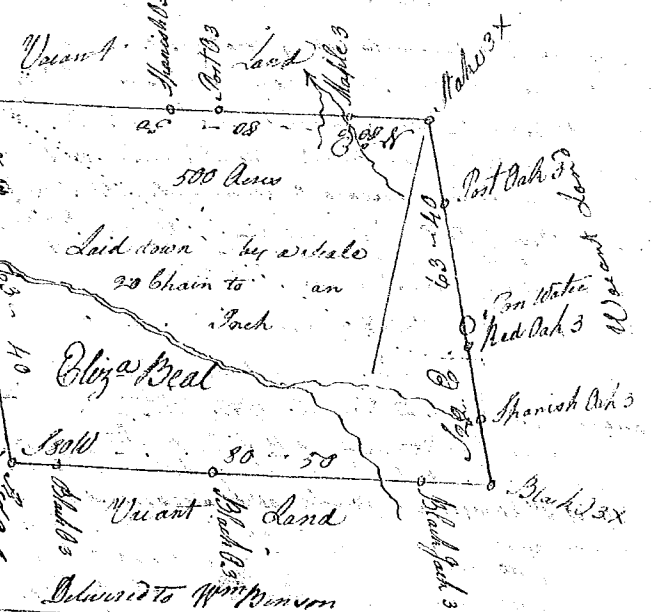

State of North Carolina Pursuant to a Warrant From John Thomas Esq. Commissioner of Locations dated the 8th day of October 1784 I have admeasured and laid out unto George Hite a Tract of Five Hundred Acres of Land Situate in Ninety Six District NW the Ancient Boundary On the North of Saluda River Bounding South on the S. P. Pica Co on Land laid out to Mary Manning and all other sides on Vacant Land and that such Shape and Mark as the Above Plat Represents

Surveyed the 12th of October 1784
 Reversed the 28th February 1785 Wm Benson Esq

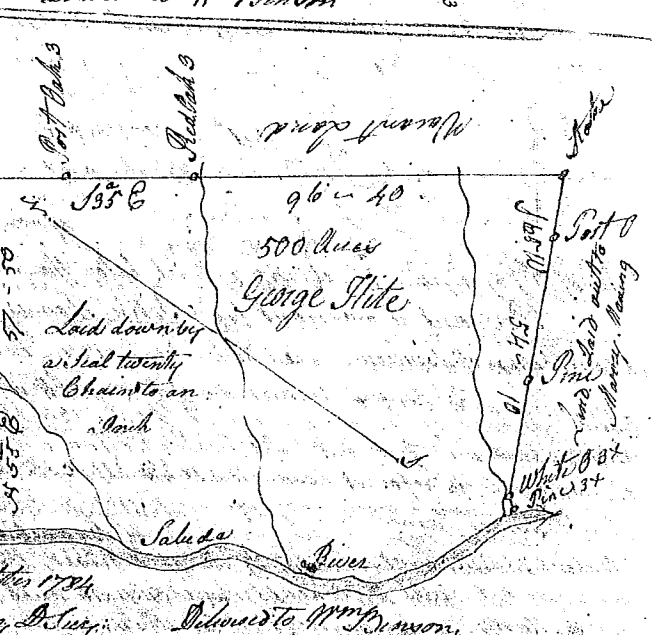

State of North Carolina Pursuant to a warrant from John Thomas Esq. Commissioner of Locations dated the 8th day of October 1784 I have admeasured and laid out unto Mary Manning a Tract of five Hundred Acres of Land Situate in 96 District NW of the Ancient Boundary On the Branches of the Beaver arm of Saluda River Bounding to the West on land laid out to Elizabeth and to the West on land laid out to David Henshaw on all other sides on Vacant Land & that such Shape and Mark as the annexed Plat Represents

Surveyed this 10th day of October 1784
 Reversed the 28th Feb 1785
 Delivered to Wm Benson Esq

