

State of S^c Carolina Pursuant to a warrant from John Thomas Esq^r Commissioner of Locations dated the 2^d Nov^r 1784, I have admeasured and laid out unto Edward Prince a Tract of land containing six hundred and forty acres, lying on both sides of Speaches Creek a branch of fair forest, bounded SW by Gilbert Prince's land, all other sides vacant land & hath such shape and Marks as the annexed Plat Represents, Survey^d the 10th Nov^r 1784.

by Andrew Thomson D^s
 recorded 16th Febr^y 1785.

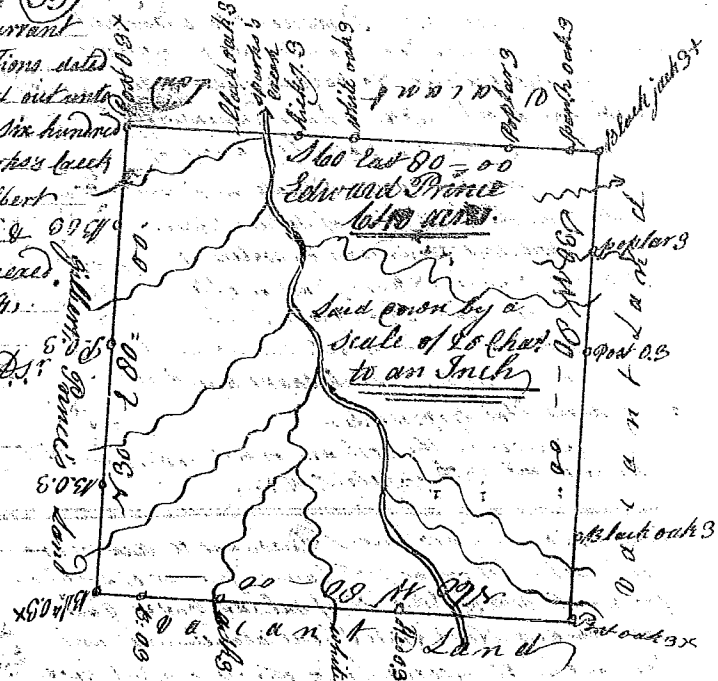

State of S^c Carolina Pursuant to a warrant from John Thomas Commissioner of Locations dated 17th Nov^r 1784, I have admeasured and laid out unto Benj^m Clarke a tract of five hundred and seventy eight acres of land, situate in ninety six District East of the ancient boundary on the branches of the N^e fork of Sugar Creek, bounding SW on Thomas Davis, land, on all other sides on Vacant Land & hath such shape and Marks as the annexed Plat Represents, Survey^d the 11th Jan^y 1785.

by W^m Benson D^s
 recorded 16th Febr^y 1785.

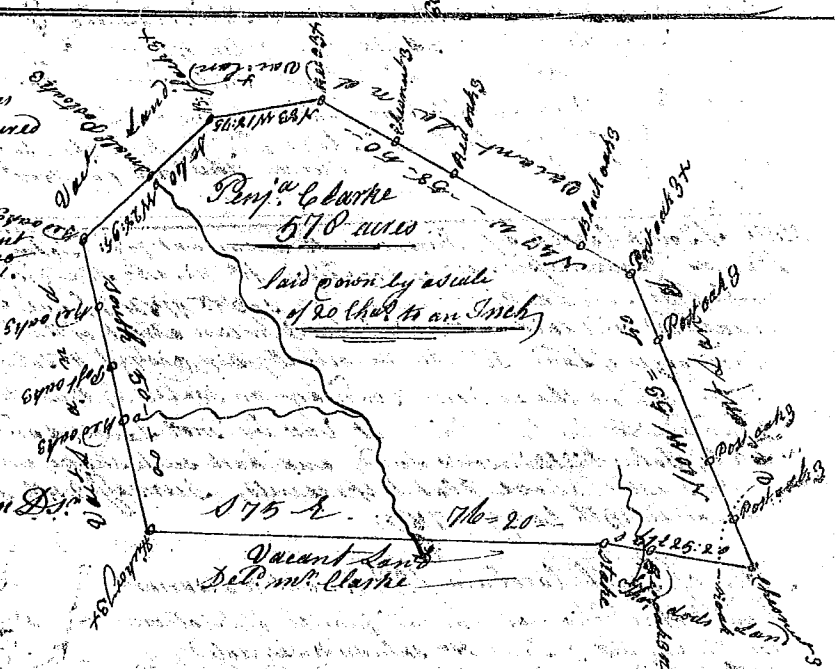

State of S^c Carolina Pursuant to a warrant from John Thomas Commissioner of Locations for Ninety six District N^e Saluda River dated 31st day of Oct^r 1784, I have admeasured and laid out unto Morile Hortman a tract of one hundred and fifty acres of land, situate in Ninety six District N^e side Saluda River below the ancient boundary on waters of Cannons Creek, bounded N^e by Schneiders land, East by 100 Summers, S by Heblers land, E by 100 Summers land, and hath such shape and Marks as the above Plat Represents, Survey^d the 11th Nov^r 1784.

by Phil^l Waters D^s
 recorded 16th Febr^y 1785.



State of S^c Carolina Pursuant to a warrant from John Thomas Commissioner of Locations for Ninety six District N^e Saluda River dated 3rd day Oct^r 1784, I have admeasured and laid out unto George Clark a tract of one hundred and fifty acres of land below the ancient boundary on head of Cam Creek waters of big Saluda, bounded N^e by Sal Schneiders land N^e by 100 Summers land, S^w by John Lates land & E on John Hagers land, and hath such shape and Marks as the above Plat Represents, Survey^d the 11th Oct^r 1784.

by Phil^l Waters D^s
 recorded 16th Febr^y 1785.

