

State of S^c Carolina Pursuant to a warrant from John Thomas Commissioner of Locations dated the 21st Sept^r 1784 I have admeasured and laid out unto Richard Jewell a tract of Land containing Five hundred and ten acres situated in 96 District on a branch of Little River called the beaver dam branch Below the ancient boundary line bounded N^o on William Dewart's land N^o on Daniel Ogborn & Sophie Annals land W^o on land claimed by one Hails & Sons & E^o on Holingsworth's land, and laid out and hath such shape and marks as the annexed Plat represents
 Survey^d the 5th Dec^r 1784 Southⁿ Downs D^o
 Recorded 31 Jan^y 1784.

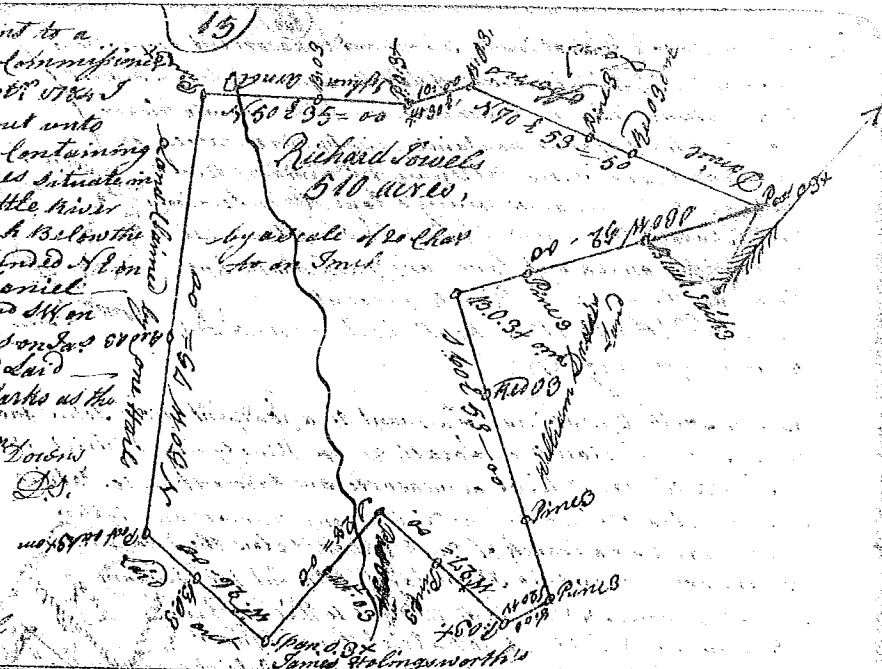

Deliver to Rich^d Jewell

State of S^c Carolina Pursuant to a warrant from John Thomas Esq^r C^o L^o dated the 10th Nov^r 1784 I have admeasured and laid out unto Pateff Jewel a Tract of Land containing 250 acres situated in 96 District on the waters of Little River Below the ancient boundary. Bounded on all sides as above specified and hath such shape and marks as the above plat represents
 Survey^d the 2nd Dec^r 1784 By Cont^r John Downs D^o
 Recorded the 3rd Jan^y 1785

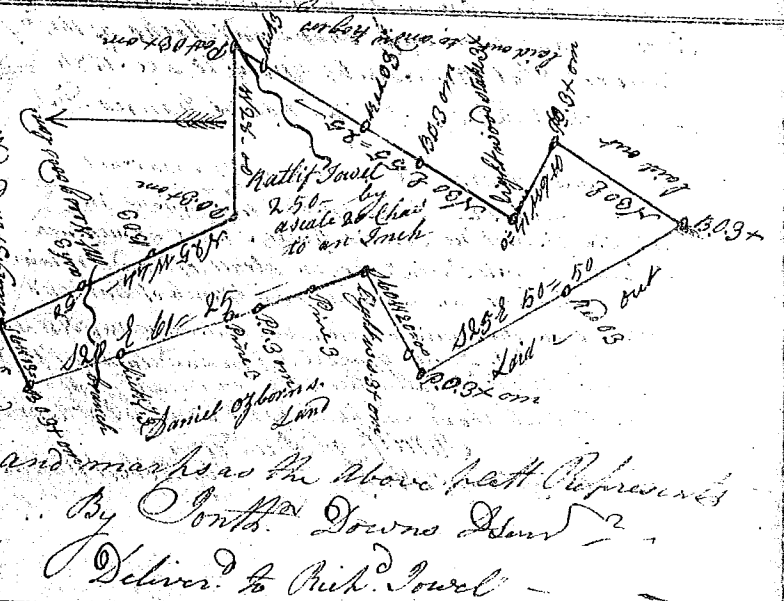

Deliver to Rich^d Jewell

State of S^c Carolina Pursuant to a warrant from John Thomas Commissioner of Locations, Dated 10th May 1784, I have admeasured and laid out unto Pateff Jewel a tract of Land containing 250 acres situated in 96 District on a branch of Little River called beaver dam below the ancient boundary line, bounded on all sides as above specified, and hath such shape and marks as the annexed Plat represents,
 Survey^d the 20th May Dec^r 1784 Southⁿ Downs D^o
 Recorded 31 Jan^y 1785
 Deliv^d Rich^d Jewell

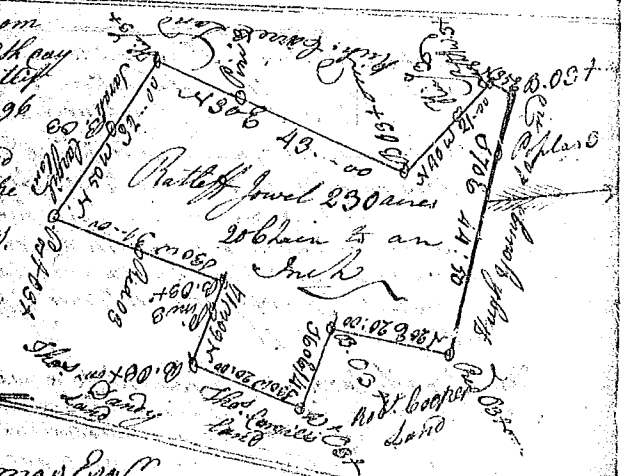

State of S^c Carolina Pursuant to a warrant from John Thomas Esq^r Com^r L^o in 96 District N^o 14th Sec^o. I have admeasured and laid out unto John Hunter a Tract of Land containing Ninety seven acres on a Branch of Middle Creek Below the Indian Boundary Bounding N^o on Land laid out to Joseph Baker Esq^r on Land laid out to Rich^d Jewell on Land laid out to Wm^m Williamson N^o on Land laid out partly to Robert Pickett & part on Land laid out to James Nicholas & hath such shape & marks as the annexed Plat represents
 Survey^d the 10th Jan^y 1785
 Recorded the 31st Jan^y 1785
 Deliver to Nath^l Hunter

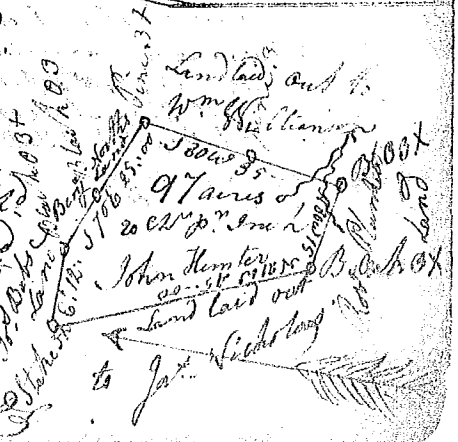

Robert Scarborough