

Pursuant to a warrant from John Thomas Esq^r Clerk
 of the District N. of Salisbury dated the 16th July 1787 I have accompanied
 and laid out unto Graaff & Sabel & Braselmann a tract of 934 Acres
 and situated in Spartanburg County on Horse Creek, by 2 small
 Branches of the Middle Sugar River, bounding by line Run 15th of S. by land surveyed for Graaff
 Sabel & Braselmann & vacant and hath such form and marks as the above
 shall represent. Surveyed the 19th July 1787. Including an Iron ore hill
 Recorded the 6th Feb^y 1788
 Wm. P. Thomas Esq^r

Pursuant to a warrant
 from John Thomas Esquire, Clerk
 of the District N. of Salisbury
 Dated the 16th July 1787. I have accompanied
 and laid out unto Graaff, Sabel and
 Braselmann a tract of one thousand
 acres of land, situated on Horse Creek
 and other branches of Middle Sugar River
 in Spartanburg County. Bounding by
 a line Run 15th by the ancient Survey
 line, all other sides vacant and hath
 such form and marks as the above
 shall represent. Surveyed the 18th July 1787.
 164

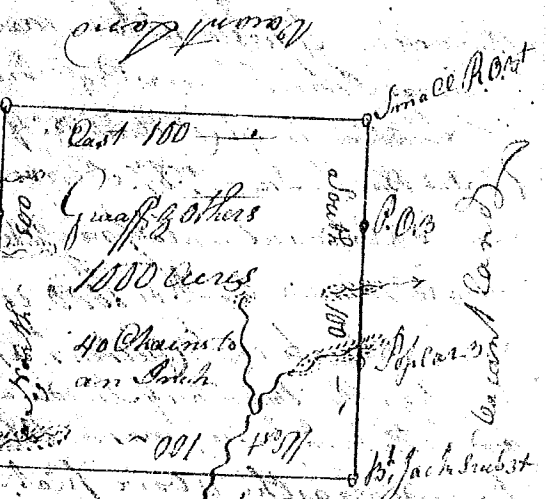

Recorded the 6th Feb^y 1788

Wm. P. Thomas Esq^r