

State of South Carolina Ninety six District on the East side of the Ancient Boundary line Pursuant to a warrant from John Thomas Esq. Commissioner of Locations for the North side of Saluda River Bearing date the 21st July 1784, I have measured and laid out unto William Kennedy a Tract of land containing Three Hundred acres, lying on Browns Creek, Bounded to the South by James Bogens land to the West by W^m M^r Juphins land to the West by Col. Thomas Brandon's land all other sides Vacant Land & hath such shape & marks as the Annexed Plat Represents

Surveyed the 7th Augst 1784. Certified by me
 Recorded the 1st Jan^y 1785.

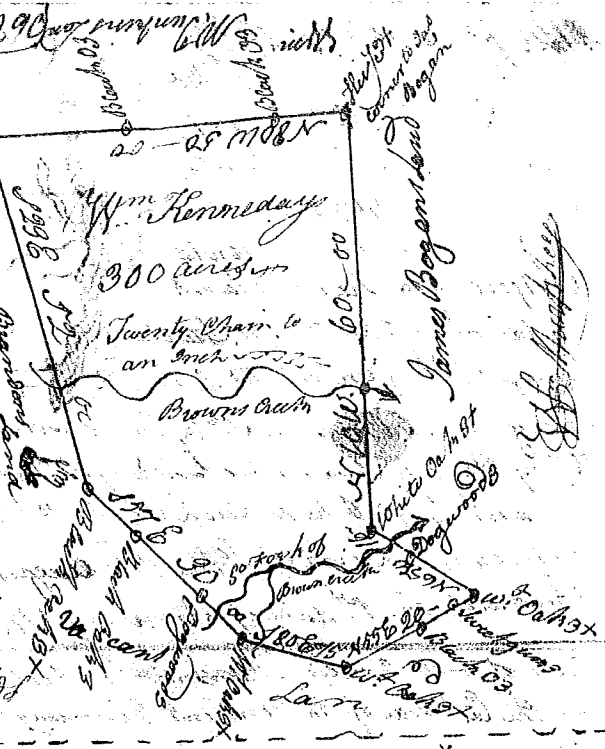

State of South Carolina Ninety six District, on the East side of the Ancient Boundary line, on the waters of Broad River Pursuant to a warrant from John Thomas Esq. Commissioner of Locations Bearing date the 21st July 1784, I have measured

and laid out unto William Kennedy a Tract of land containing one Hundred & Thirty five acres lying on Browns Creek a Branch of Broad River, Bounded to the East by the said W^m Kennedys land all other sides Vacant Land, and hath such shape & marks as the above Plat Represents Surveyed Augst 7th 1784 Certified under the hand of Andrew Thomson Esq.

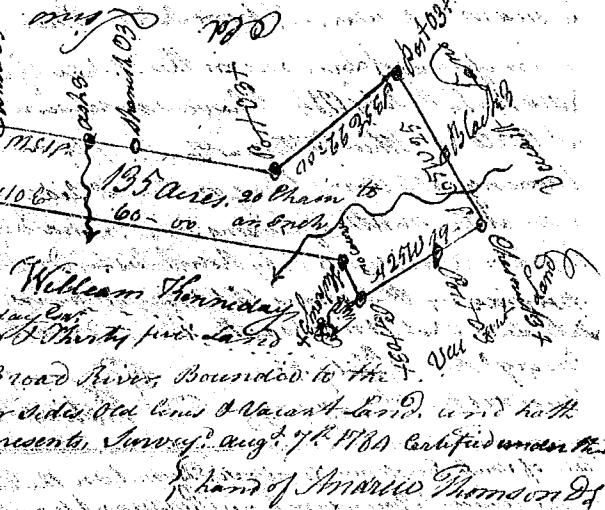

State of South Carolina 96 District on the East side of Ancient Boundary Pursuant to a warrant from John Thomas Esq. Commissioner of Locations Bearing date the 3rd Augst 1784, I have measured & laid out unto James Wofford a Tract containing two Hundred acres lying on both sides of Fergusons Creek Bounded Easterly by County Land Northwardly by Old lines Southwardly by Nimrod Houses land, all other sides Vacant Land & hath such shape and marks as the above Plat Represents Surveyed the 2nd Augst 1784

Recorded the 1st Jan^y 1785
 Deliv^d to said Wofford by order

