

State of S^c Carolina

Pursuant to a warrant from John
 Thomas Esq^r Com^r of Locations
 Commissioned dated the 11th Oct. 1784 I
 have measured & laid out unto James
 Henderson a Tract containing three hun-
 dred & thirty acres of land, situate in
 Ninety six District on Little America Branch
 of the Santee Below the Ancient Boundary
 Bounded N^w on Charles Smiths land East
 on Big Survey North on land laid out
 and half S^w side shape & marks as the
 annexed plat represents, Survey the
 6th day Dec^r 1784 for North Down D^s
 Recorded the 27th Dec^r 1784
 Deliv^d to Joshua Arnold

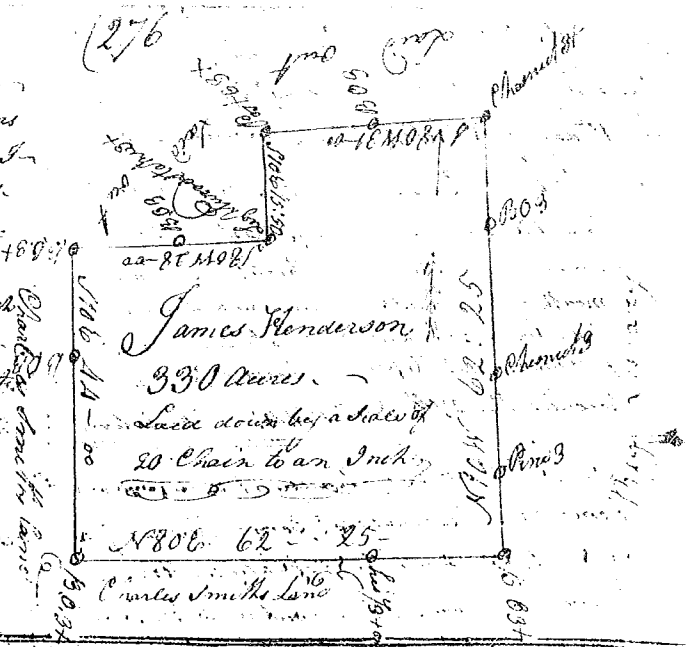

State of S^c Carolina

Pursuant to a warrant from John
 Thomas Esq^r Com^r of Locations dated
 the 11th Oct. 1784 I have measured
 and laid out unto James Henderson a
 Tract containing 297 acres of land
 situate in Ninety six District and
 Branch of Little River call^d Simmons
 Creek Below the Ancient Boundary
 Bounded N^w on James Hendersons
 & Charles land N^e on Samuel Hendersons &
 half S^w side shape from & marks as the an-
 nexed plat represents, Survey the 11th day
 Dec^r 1784
 Recorded the 27th Dec^r 1784
 Deliv^d to Joshua Arnold

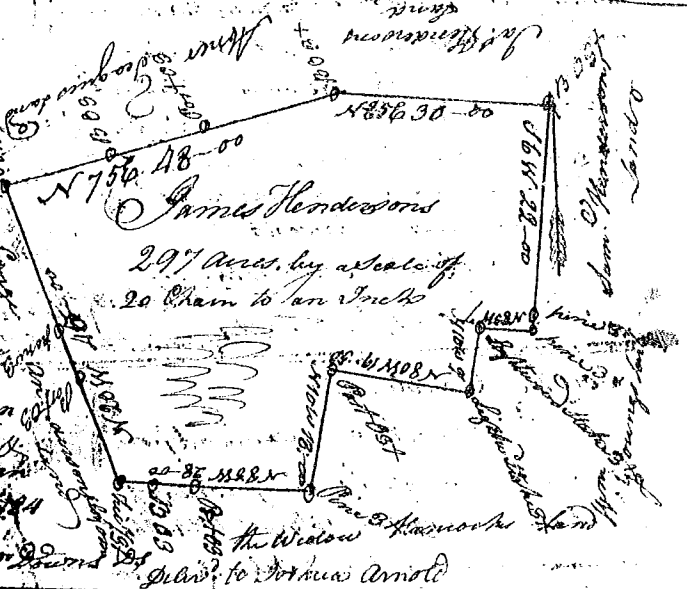

State of S^c Carolina, Pursuant to a warrant from John

Thomas Esq^r Com^r of Locations dated the 8th day of Nov. 1784
 I have measured and laid out unto Robert Franks a
 Tract containing 640 acres, situate in Ninety six Dist^r
 on a Branch of the Santee creek call^d Govealls Branch Below
 the ancient Boundary, Bounded N^w on James Gowan and
 John Townsland W^o on a Big Survey
 and Joshua Arnolds land and all
 other sides vacant land & half
 S^w side shape and marks as
 the annexed plat represents,
 Survey the 5th day
 of Dec^r 1784

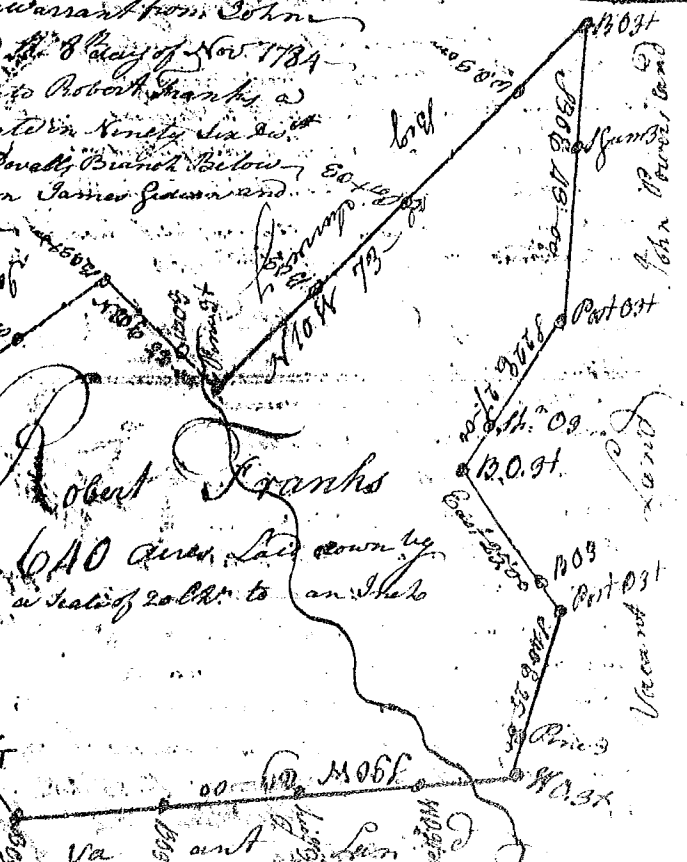

North Down D^s
 Recorded the 27th
 Dec^r 1784
 Deliv^d to Joshua Arnold