

State of South Carolina
 Pursuant to a warrant from John
 Thomas Esq. Commissioner of Locations dated the
 19th day of August 1784. I have admeas. 80 100
 surd & laid out unto Wm Garrison
 a tract of land containing three hun
 dred & three acres, situate in Ninety
 six District East of the old Boundary, & on
 on the south side of Broad River, & on
 both sides of Cass Creek of S. River bound
 on E. on said river & James Philipps land
 on James Sumner's land on West side, all
 other sides on Vacant Land, and hath
 such form & marks as the annexed plat
 represents, Surveyed the 20th Aug. 1784
 Geo. Salmon D.S.

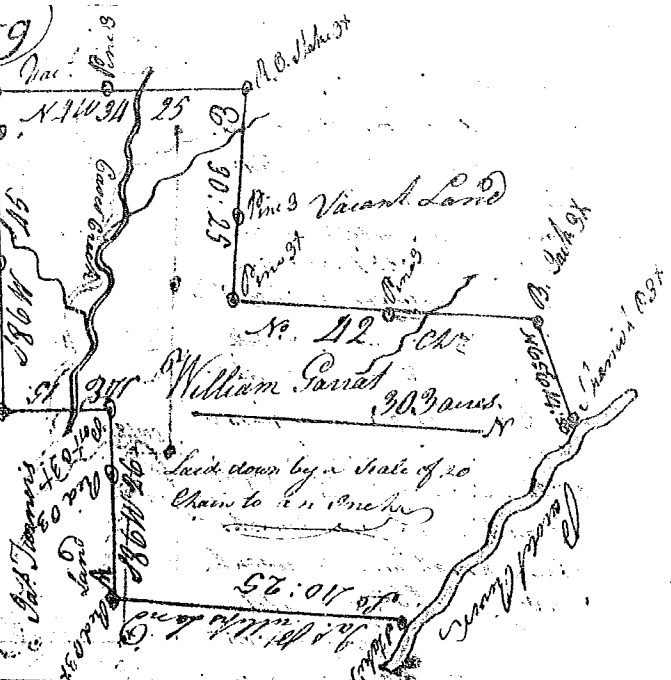

State of South Carolina
 Pursuant to a warrant from John
 Thomas Esq. Commissioner of Locations
 dated the 17th day of Aug. 1784. I have
 admeasured & laid out unto Reubin
 Dubois a tract of land containing
 six hundred & forty acres, situate
 in Ninety six District East of the
 old Boundary, on both sides of Broad
 River, bounding N. on Thomas Warrens
 land & S. on James G. & on Wm Garrison's
 land & Vacant all other sides on
 Vacant Land, & hath such form
 & marks as the annexed plat
 represents, Surveyed the 25th day
 of August 1784
 George Salmon D.S.
 Recorded the 17th Dec. 1784

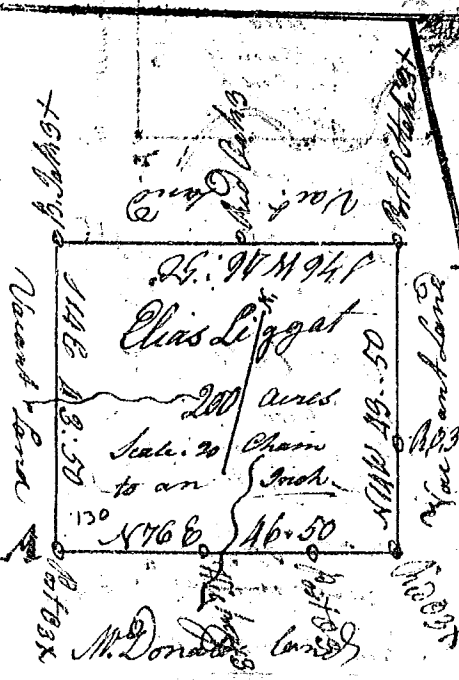
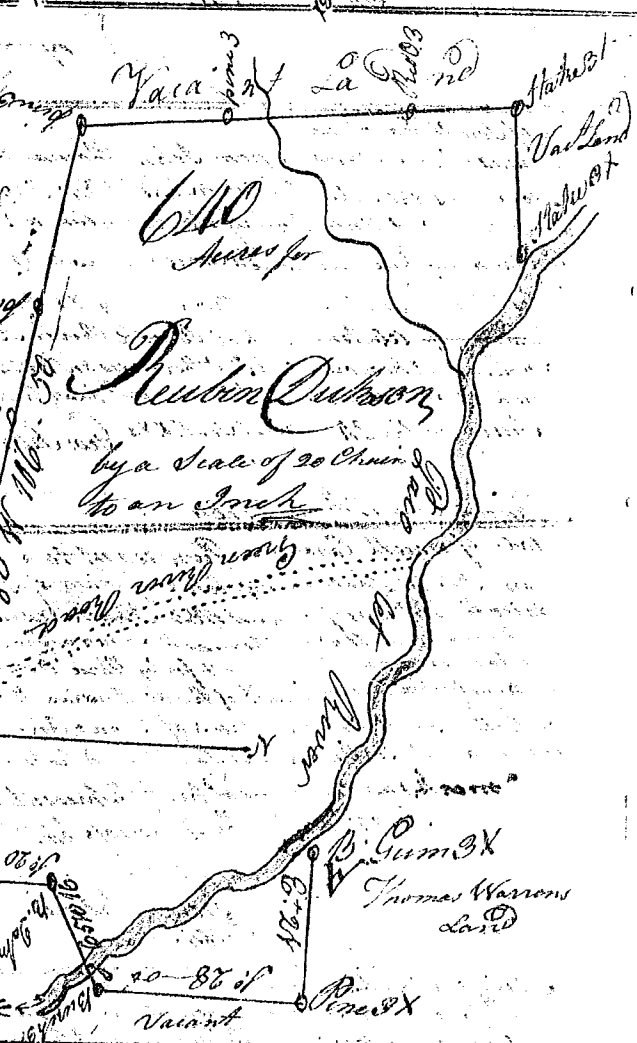

State of South Carolina, pursuant to a warrant from John
 Thomas Esq. Commissioner of Locations dated the 17th day of Aug.
 1784. I have admeasured on & laid out unto Elias Leggat a tract
 of land containing two hundred acres, situate in Ninety
 six District East of the old Boundary on the branches of Broad
 creek of Broad River bounding N. on M. Donalds land
 all other sides on Vacant land, and hath such form and
 marks as the annexed plat represents, Surveyed the 25th Aug. 1784
 Recorded the 17th Dec. 1784
 George Salmon D.S.