

State of South Carolina

Pursuant to a warrant from John Thomas Esq. Com. of Locations dated the 14th day of Sept. 1784. I have admeasured & laid out unto David Robinson a tract of land containing two hundred and fifty acres situate in Ninety six District East of the old Boundary on both sides of Gibbins creek of Thickety waters of Broad River. Bounding on all sides on Vacant land, and hath such form & marks as the annexed plat represents. Surveyed the 23rd day of Sept. 1784

George Salmon Esq. Surveyor

Recorded the 16th Dec. 1784

(257) 150 100 100 100

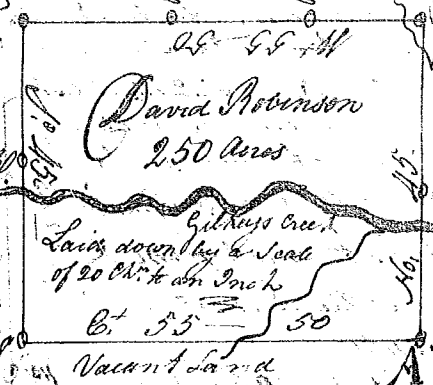

State of South Carolina

Pursuant to a warrant from John Thomas Esq. Com. of Locations dated the 14th day of Sept. 1784. I have admeasured and laid out unto John Thompson Junr a tract of land containing three hundred & fifty eight acres situate in Ninety six District East of the old Boundary on both sides of Gibbins creek and Polecat Branch of Thickety waters of Broad River. Bounding N.E. by John Thompsons land E. by John Thompsons land S. by Vacant Land and West by such form and marks as the annexed plat represents. Surveyed the 21st day of Sept. 1784

George Salmon Esq. Surveyor

Recorded the 16th day of Dec. 1784

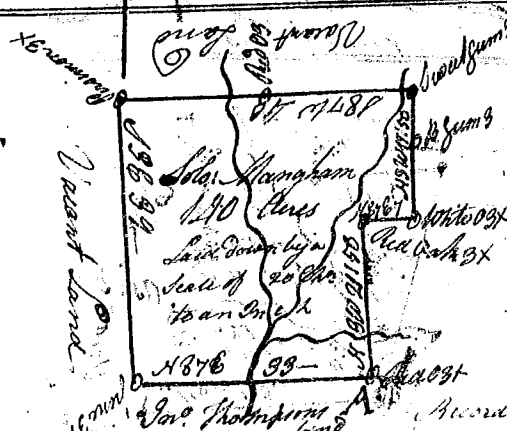
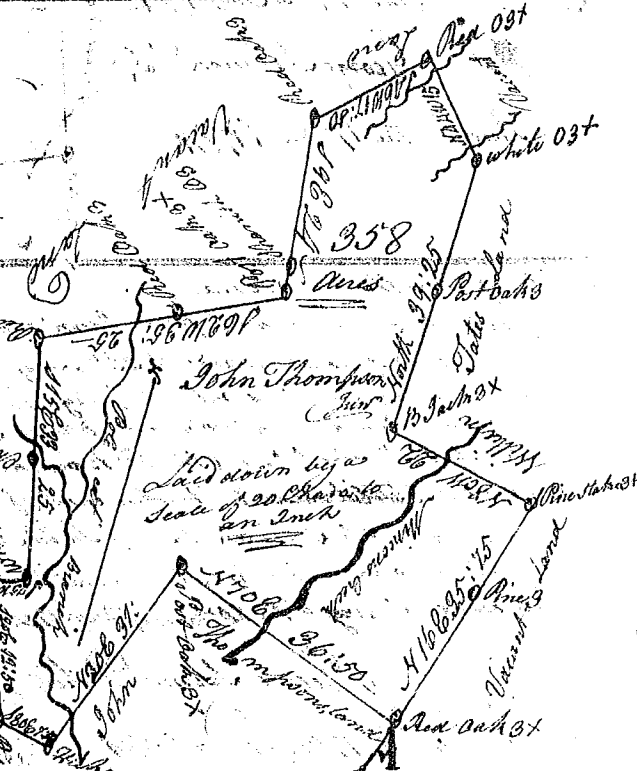

State of South Carolina Pursuant to a warrant from John Thomas Esq. Com. of Locations dated the 14th day of Sept. 1784 I have admeasured & laid out unto Solomon Mangham a tract of land containing 140 acres, situate in 96 District East of the old Boundary, on both sides of Joneses branch of Thickety creek of Broad River. Bounding on land laid out for John Thompson Junr. all other sides on vacant land & hath such form & marks as the annexed plat represents. Surveyed the 22nd day of Sept. 1784

George Salmon Esq. Surveyor

Recorded the 16th Dec. 1784

State of South Carolina Pursuant to a warrant from John Thomas Esq. Com. of Locations dated the 14th day of Sept. 1784 I have admeasured & laid out unto John Thompson Junr a tract of land containing 100 acres, situate in 96 District East of the old Boundary, on both sides of a branch of Thickety creek waters of Broad River. Bounding E. on John Thompsons land all other sides on vacant land & hath such form & marks as the annexed plat represents. Surveyed the 23rd day of Sept. 1784

George Salmon Esq. Surveyor

Recorded the 16th Dec. 1784

