

State of South Carolina
 Pursuant to a warrant from John Thomas Esq. Com. Loc. dated the 9th of Aug. 1784. I have admeasured & laid out unto John Cannon a tract of land containing 300 acres, Situate in q6 Dist. East of the Old Indian Boundary on both sides of Peters creek of Peter's Creek (Boundary) from John Cannon's Land all other lines on Vacant Land and hath such form & marks as the annexed plat represents Surveyed the 31st Aug. 1784
 Recorded the 16th Dec. 1784
 Geo. Salmon D.S.

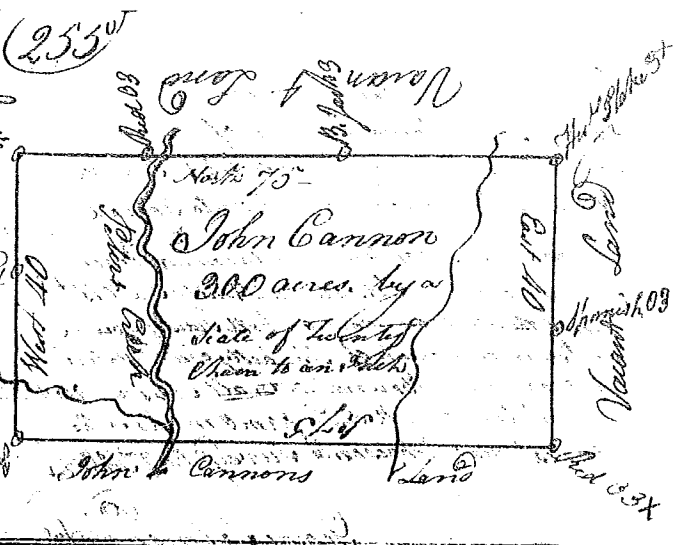

State of South Carolina
 Pursuant to a warrant from John Thomas Esq. Com. Loc. dated the 16th of Aug. 1784. I have admeasured & laid out unto James Wyatt Senr. a tract of land containing 200 acres, Situate in Ninety Six District East of the Old Indian Boundary, on the North side of the Old Indian Boundary Westwards on said River, all other lines on Vacant Land, and hath such form & marks as the annexed plat represents Surveyed the 11th Aug. 1784
 Recorded the 16th Dec. 1784
 Geo. Salmon D.S.

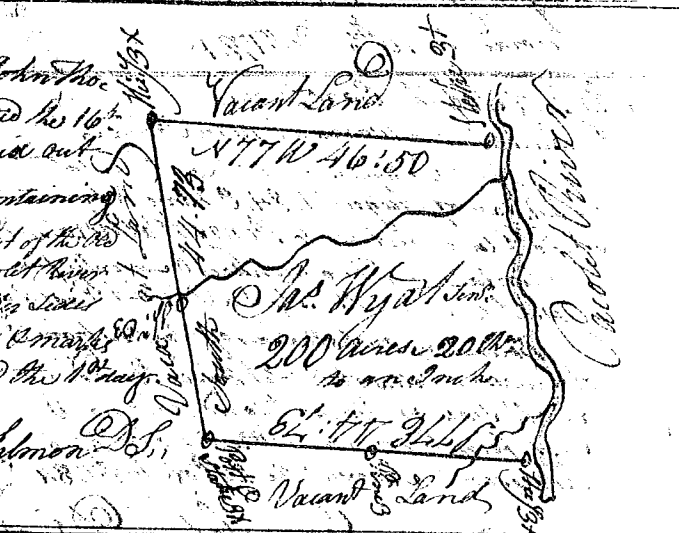

State of South Carolina
 Pursuant to a warrant from John Thomas Esq. Com. Loc. dated the 29th day of Aug. 1784. I have admeasured & laid out unto William Brandon a tract of land containing four hundred acres Situate in Ninety Six District East of the Old Indian Boundary on both sides of Sawyers fork of Peter's River, Boundary N.W. on David Lewis's Land all other lines on Vacant Land and hath such form & marks as the annexed plat represents Surveyed the 17th Aug. 1784
 Recorded the 16th Dec. 1784
 Geo. Salmon D.S.



State of South Carolina
 Pursuant to a warrant from John Thomas Esq. Com. Loc. dated the 6th day of August 1784. I have admeasured & laid out unto Thomas Jordan a tract of land containing one hundred acres Situate in q6 Dist. East of the Old Indian Boundary on both sides of a branch of Peter's Creek, Boundary on all sides on Vacant Land and hath such form & marks as the annexed plat represents Surveyed the 25th day of Aug. 1784
 Recorded the 16th Dec. 1784
 Geo. Salmon D.S.

