

State of South Carolina Pursuant to a (25A)

Warrant from John Thomas Esq. Com. of Locations dated the 15<sup>th</sup> of Sept. 1784. I have admeasured & laid out unto Wm Caldwell a tract of land containing 290 acres. Situated in 96 Dis. East of the waters of Little River below the Ancient Boundary line bounding on James Smith N.E. on Charles Jones & Wm Griffin & Jacob Jones & M. on Vacant Land & hath such shape form & marks as the annexed plat represents.

Surveyed the 25<sup>th</sup> Nov. 1784

Recorded the 29<sup>th</sup> Nov. 1784

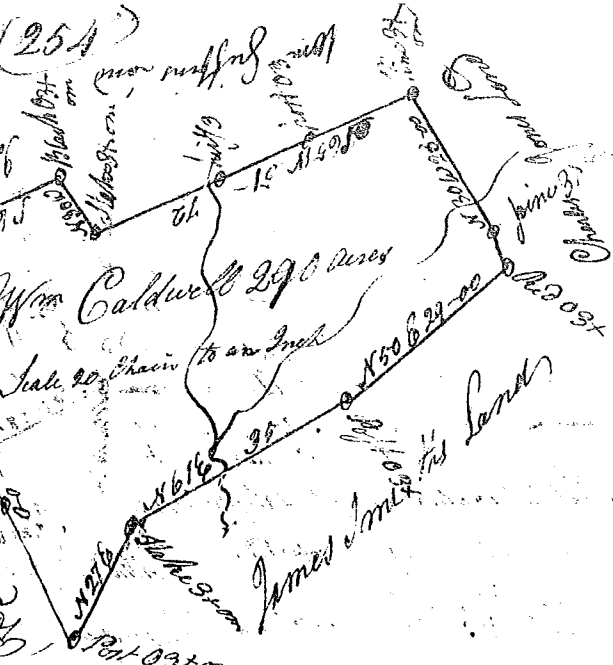

State of South Carolina Pursuant to a warrant from John

Thomas Esq. Com. of Locations dated the 15<sup>th</sup> of Sept. 1784. I have admeasured & laid out unto Samuel Scott a land containing 150 acres. Situated in vicinity to district on the waters of Hogburns creek below the Ancient Boundary bounding to the SW on lands of Daniel Williams S.E. on Vacant N.W. on land the owner unknown also on lands of the Widow Milhouse and hath such shape form & marks as the annexed plat represents.

Surveyed the 8<sup>th</sup> day of Oct. 1784

Recorded the 29<sup>th</sup> Nov. 1784

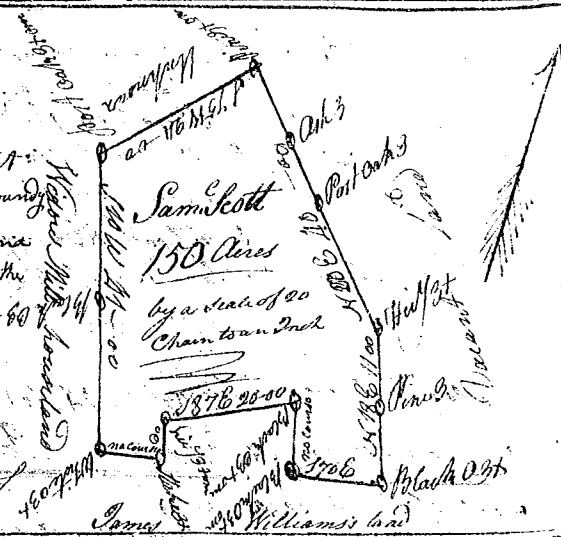

State of South Carolina

Pursuant to a warrant from John Thomas Esq. Com. of Locations dated the 31<sup>st</sup> day of Aug. 1784. I have admeasured & laid out unto William Taylor a tract of land containing 200 acres. Situated in 96 Dis. East of the old boundaries on both sides of Peoples Creek of Broad River. Bounding on the East on Vacant Land & hath such form & marks as the annexed plat represents. Surveyed the 3<sup>rd</sup> of Sept. 1784.

Recorded the 16<sup>th</sup> Dec. 1784

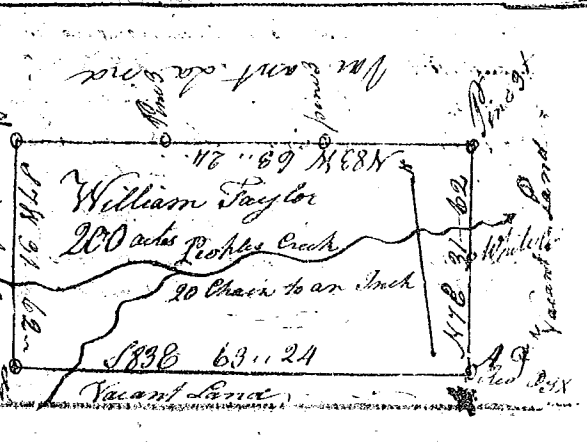

State of South Carolina

Pursuant to a warrant from John Thomas Esq. Com. of Locations dated the 23<sup>rd</sup> of Aug. 1784. I have admeasured & laid out unto Daniel Walker a tract of land containing 200 acres. Situated in 96 Dis. East of the old boundaries on the North side of Peoples River. Bounding N.E. on River & all other sides on Vacant Land & hath such form & marks as the annexed plat represents.

Surveyed the 31<sup>st</sup> of Aug. 1784

Recorded the 16<sup>th</sup> Dec. 1784

