

State of South Carolina Pursuant to a Warrant from John Thomas Esq. Commissioner of Locations Dearing Date 27 Sept. 1784
I have commensured of Laid out unto Marshal Franks a Tract of Land containing 180 Acres Situate in 96 District on a Branch of Warriors Creek Call. Cox. Branch Below the Ancient Boundary Line bounded N. E. on Henry Bromblet's N. and N. W. by William Andersons N. W. by Land laid out to E. by John Cox. Land and hath such Shape and Marks as the above Plat Represents

Survey'd this 8th day of Oct. 1784
Recorded the 7th Dec. 1784 By Southth Downs D. S. Del. Saml. Franks

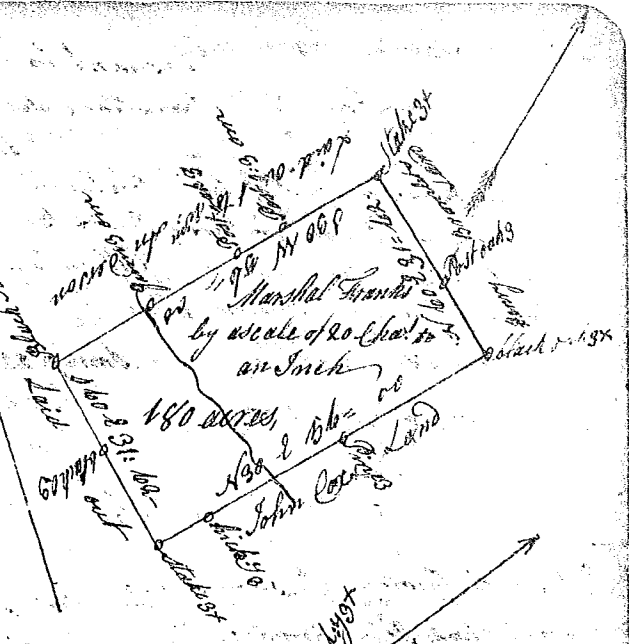

State of South Carolina Pursuant to a warrant from John Thomas Esq. Commissioner of Locations dated 20th Sept. 1784
I have admeasured and laid out unto Marshal Franks a tract of land containing 280 acres situate in 96 District on a branch Enorce called Duncan's Creek below the ancient Boundary Line bounded N. E. by John M. Donald Ward N. W. on William Cheek and Ducont. W. by Theodorious Goodwin S. E. on James Gidions Land all other sides on Vacant Land and hath such shape and Marks as the above Plat Represents

Recorded 7th Dec. 1784 Del. Saml. Franks



State of South Carolina Pursuant to a warrant from John Thomas Esq. Commissioner of Locations I have admeasured and laid out unto George Astor a tract of one hundred and sixty three acres of land situate in Ninety six District on the waters of Cain Creek and bounding N. W. on land laid out to Terrance Carril, and William Bethany J. E. by Vacant Land S. E. by John White and John Brown N. E. by unknown and hath such shape and Marks as the above Plat Represents

Recorded the 7th Dec. 1784

