

State of South Carolina (205)

Pursuant to a warrant from John Thomas Esq. Com. Locations in Ninety six District Northward Saluda River Bearing date the 22nd day of Oct. 1784, I have admeasured & laid out unto James Vardiman a tract of land containing four Hundred & forty acres on the north side of Enoree River below the ancient Boundary. Bounded N.W. on John Clark & Co. on John Caldwell & Co. land & Co. & S.W. on vacant land and hath such shape & marks as the annexed plot represents. Survey, the 8th Nov. 1784
Recorded the 11th Nov. 1784

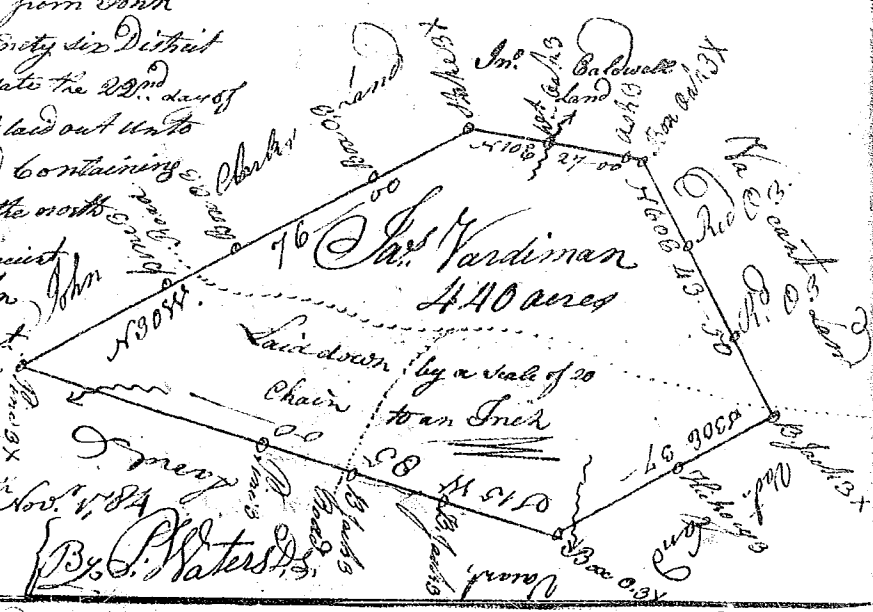

State of South Carolina
Pursuant to a warrant from John Thomas Esq. Commissioner of locations for Ninety six District North of Saluda River dated the 20th Sept. 1784, I have admeasured and laid out unto Lewis Hogg a tract of one Hundred & forty six acres of land lying on Enoree River below the ancient Boundary Bounding N.W. on John Clark & Co. on the heirs of Chandler & Co. on Wm. Waddletons & S.W. on P. Ann & hath such shape & marks as the annexed plot represents. Survey, the 9th Nov. 1784 - By Waters Esq.

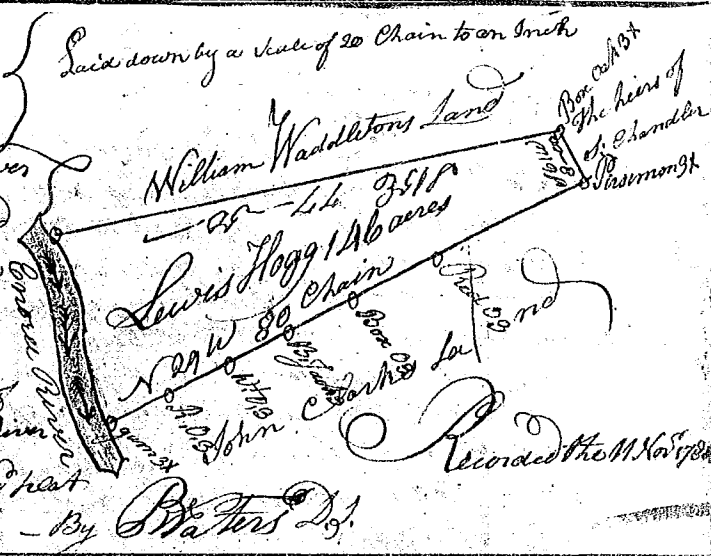

State of South Carolina
Pursuant to a warrant from John Thomas Esq. Com. of locations, I have admeasured and laid out unto William Carter a tract of two Hundred & fifty acres of land, situated in 96th District on the Waters of Broad River on the fishdam creek Bounding N.W. on land laid out to Chandler & Co. & all other sides on vacant land laid out, & hath such shape & marks as the annexed plot represents. Survey, the 30th Augt. 1784
David Hopkins Esq.
Recorded the 13th Nov. 1784

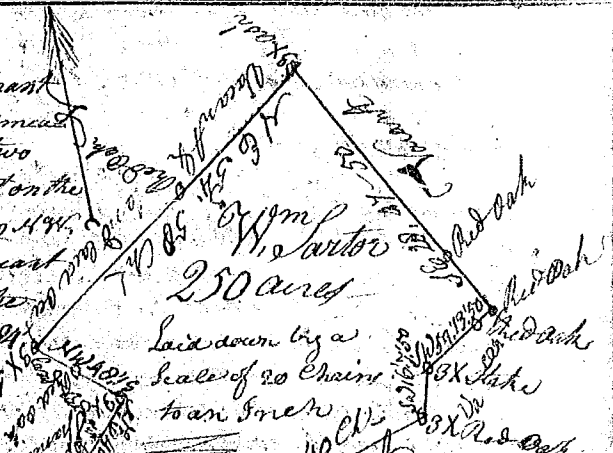

State of South Carolina
Pursuant to a warrant from John Thomas Esq. Com. Loc. dated the 27th of Oct. 1784 I have admeasured & laid out unto Charles Larson a tract of land containing eighty seven acres situated in 96th District on the west side Saluda River below the ancient Boundary on a bend of Little River called Beaver dam Boundary R. on the east side Wm. Waddletons land laid out & by James Madsen & on the north by John Clark & Co. I mark as the annexed plot represents. Survey, the 15th Nov. 1784
Recorded the 15th Nov. 1784

